

ZB200 Bridge



ZEBRA

User Guide

2026/01/07

ZEBRA and the stylized Zebra head are trademarks of Zebra Technologies Corporation, registered in many jurisdictions worldwide. All other trademarks are the property of their respective owners. ©2026 Zebra Technologies Corporation and/or its affiliates. All rights reserved.

Information in this document is subject to change without notice. The software described in this document is furnished under a license agreement or nondisclosure agreement. The software may be used or copied only in accordance with the terms of those agreements.

For further information regarding legal and proprietary statements, please go to:

SOFTWARE: zebra.com/informationpolicy.

COPYRIGHTS: zebra.com/copyright.

PATENTS: ip.zebra.com.

WARRANTY: zebra.com/warranty.

END USER LICENSE AGREEMENT: zebra.com/eula.

Terms of Use

Proprietary Statement

This manual contains proprietary information of Zebra Technologies Corporation and its subsidiaries ("Zebra Technologies"). It is intended solely for the information and use of parties operating and maintaining the equipment described herein. Such proprietary information may not be used, reproduced, or disclosed to any other parties for any other purpose without the express, written permission of Zebra Technologies.

Product Improvements

Continuous improvement of products is a policy of Zebra Technologies. All specifications and designs are subject to change without notice.

Liability Disclaimer

Zebra Technologies takes steps to ensure that its published Engineering specifications and manuals are correct; however, errors do occur. Zebra Technologies reserves the right to correct any such errors and disclaims liability resulting therefrom.

Limitation of Liability

In no event shall Zebra Technologies or anyone else involved in the creation, production, or delivery of the accompanying product (including hardware and software) be liable for any damages whatsoever (including, without limitation, consequential damages including loss of business profits, business interruption, or loss of business information) arising out of the use of, the results of use of, or inability to use such product, even if Zebra Technologies has been advised of the possibility of such damages. Some jurisdictions do not allow the exclusion or limitation of incidental or consequential damages, so the above limitation or exclusion may not apply to you.

Contents

Getting Started.....	4
Unpacking the Device.....	5
Bridge Features.....	5
Using the Device.....	7
Connecting the Cables.....	7
Connecting the USB Power Cable.....	7
Connecting the Ethernet Cable.....	8
Mounting the Bridge.....	9
Bridge LED Indicators.....	10
Configuring the Bridge.....	11
Maintenance and Troubleshooting.....	21
Cleaning the Bridge.....	21
Approved Cleaning Agents.....	21
Troubleshooting.....	23
Frequently Asked Questions.....	25
Technical Specifications.....	26

Getting Started

This guide provides a general description of the ZB200 Bridge solution, practical instructions for installation, and easy setup of your device.

The Bridge is designed to interact with the following Zebra products and associated applications:

- ZS300 Sensor
- Setup Utility App for Electronic Temperature Sensors (Android OS) for Bridge configuration (ZBSetup)
- Customer-facing set of Application Programming Interface (API's) and Android Sensor Discovery Service for data and management
- Sensor Discovery Service App for Android OS (ZSFinder)
- Zebra Developer Portal

The Bridge automatically detects all compatible ZS300 Sensors within wireless range and passes the data stored in their memory to the Cloud. The API's allow Independent Software Vendors (ISV's), Partner Integrators, and Enterprise-level Customers, who have their own development staff, to integrate the Zebra solution with software applications that they develop or choose to interface with, for purposes of monitoring the cold chain.

It is a best practice to place devices behind a firewall to limit unauthorized access. The firewall only needs to allow the device to create outgoing HTTP connections to port 443; no incoming connections should be allowed.

Figure 1 High Level Data Flow



Unpacking the Device

The ZB200 Bridge is packaged with the following contents:

- USB A-to-C locking cable
- Mounting bracket
- Quick Start Guide



NOTE: The AC Power Adapter must be purchased separately based on country of use.

Bridge Features

This section lists the features of the ZB200 Bridge.

Figure 2 ZB200 Features

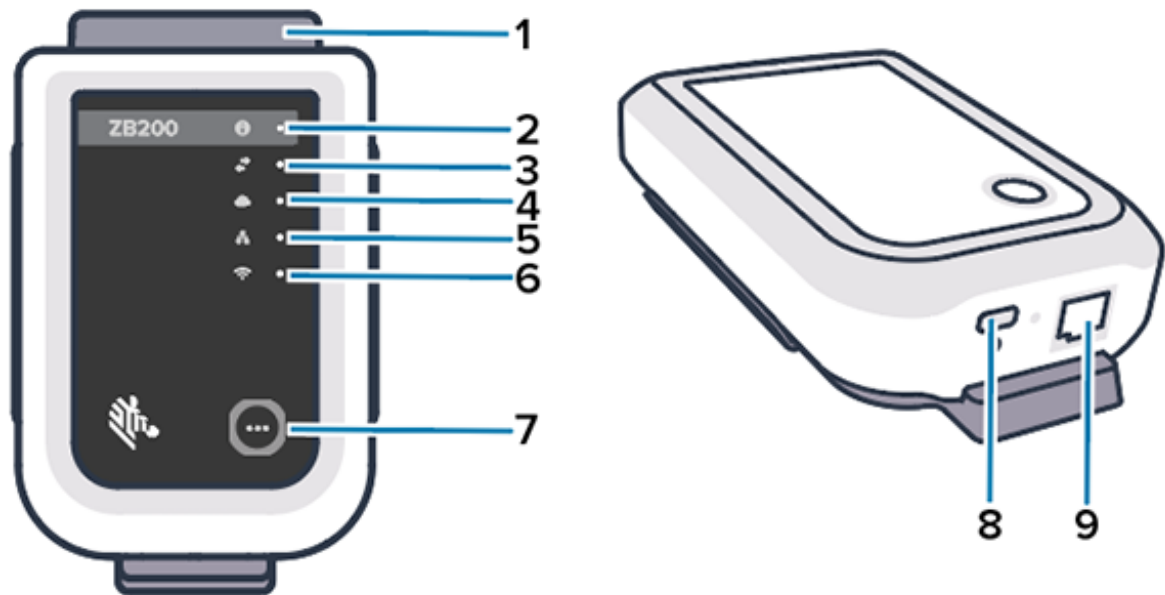

1	Mounting Bracket
2	Status LED
3	Sensor Communication Icon
4	Cloud Connection LED
5	Ethernet Connection LED
6	Wi-Fi Connection LED
7	Pair Button
8	USB Port
9	Ethernet Port

The ZB200 Bridge features the following:

- Ethernet 802.3 (10/100) communication
- Wi-Fi 802.11 a/c communication
- Bluetooth Low Energy 4.1 or greater compliant radio
- Encrypted communication between Bridge and ZS300 Sensor
- Unlimited storage of sensor readings in the Cloud
- IP50 compliant
- Wall bracket for mounting
- Pairing button for Bridge configuration

Using the Device

This section describes how to use the ZB200 Bridge, including connecting the USB power cable, connecting the Ethernet cable, and LED blink patterns.

Connecting the Cables

The ZB200 Bridge has two potential cable options, one a USB power cable and the other an Ethernet cable, which cannot be connected in order to use Wi-Fi. The following section describes how to install each cable.

Connecting the USB Power Cable

1. Insert the USB-C connector (1) into the USB port on the bottom of the Bridge.
2. Insert the twist lock (2) in the hole (3) beneath the USB port and tighten to secure it to the Bridge.
3. Insert the opposite end of the USB cable into the USB port on the Zebra-approved power adapter (available separately).

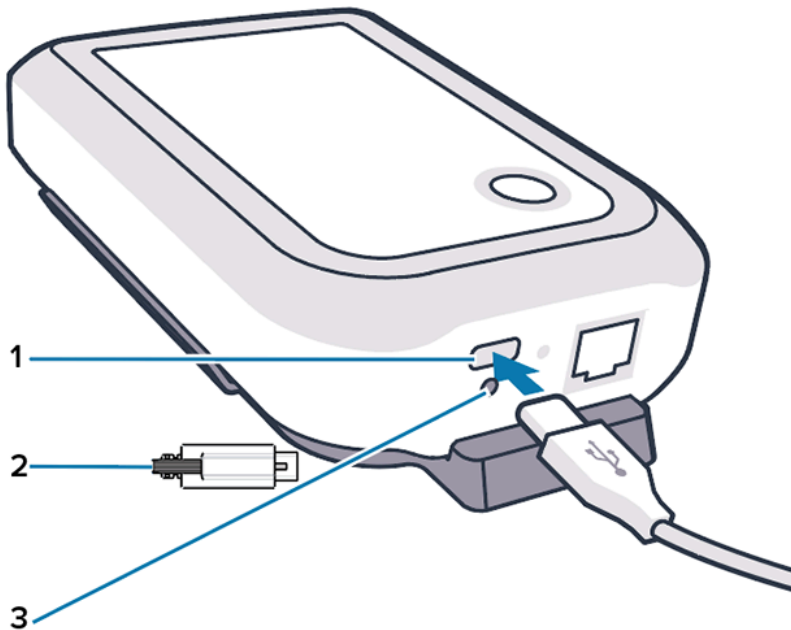

Connecting the Ethernet Cable



NOTE: This step only applies if using Ethernet.

1. Insert the Ethernet connector into the ethernet port on the bottom of the Bridge until it clicks into place.
2. Plug the other end of the Ethernet cable into an Ethernet port at the customer facility to connect to their network.

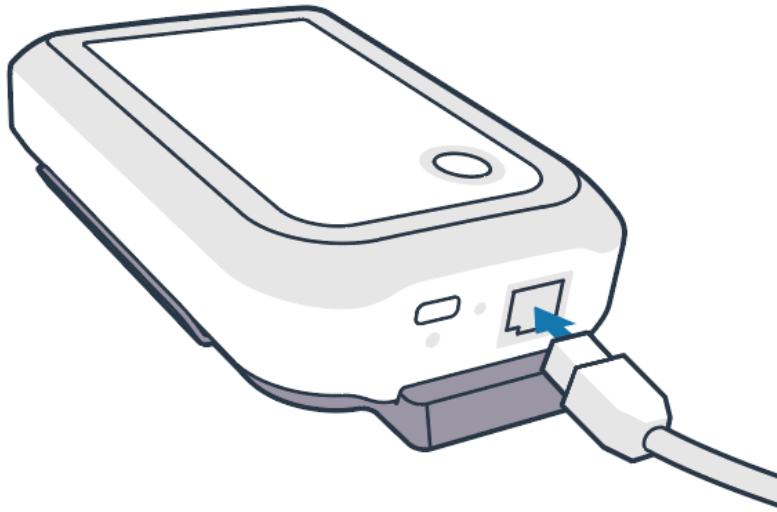

Mounting the Bridge

The ZB200 Bridge comes with a wall mounting bracket which allows the bridge to be mounted on a wall or pole in a desired location, one which allows proper connectivity with a ZS300 Sensor and provides optimal range coverage.

1. Mount the wall bracket using four 3/4 in. long #6 round head sheet metal screws and drywall anchors (not included) where indicated. Ensure that the bracket is secure enough to withstand changing environmental conditions.

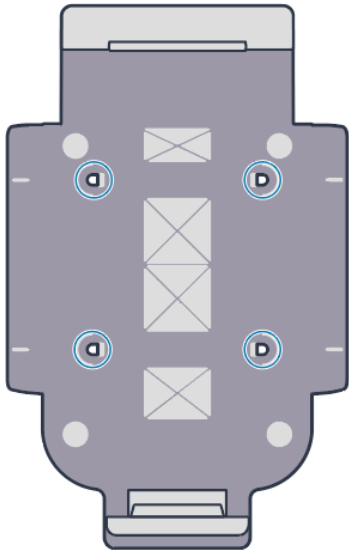

2. Insert the slot (1) on the bottom of the Bridge into the tab on the bottom of the bracket.

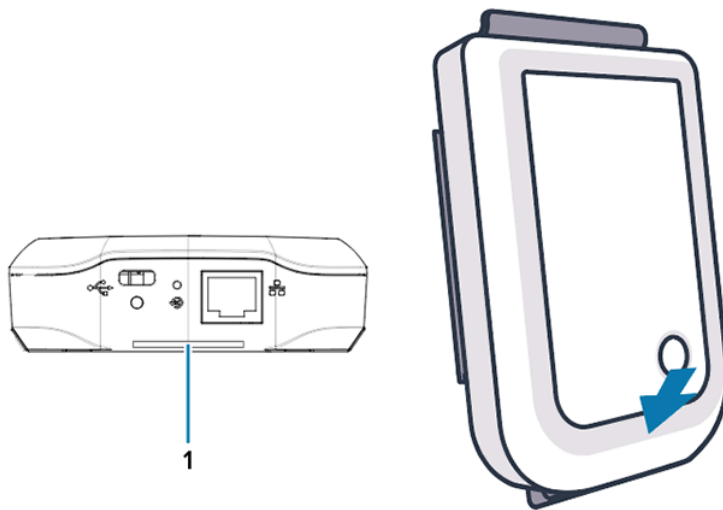

3. Press down on the top of the Bridge until it snaps into place in the bracket.

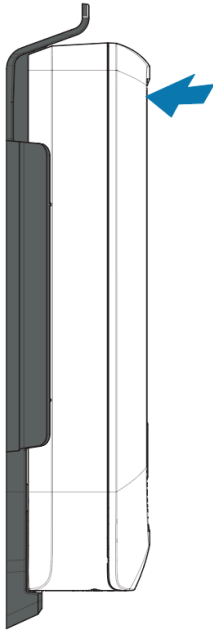

NOTE: If using Wi-Fi or changing to a Static IP Address, proceed to [Setting a Network Connection](#) to first configure your network settings before mounting the bridge on the bracket.

Bridge LED Indicators

The ZB200 Bridge features LED indicators in red, green, yellow, and blue colors for various functions outlined in the image below.

Figure 3 ZB200 LED Behavior

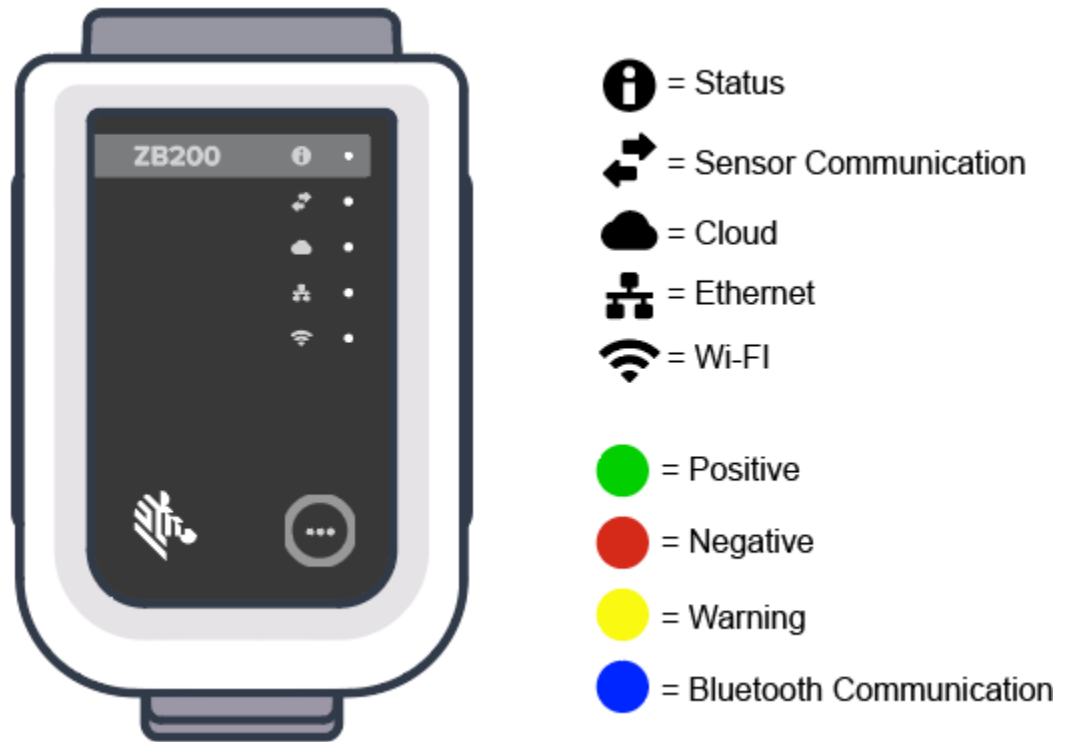

Configuring the Bridge

This section details the steps needed to set a network connection for the ZB200 Bridge using the Zebra Setup Utility App for Electronic Temperature Sensors for Android (ZBSetup).



NOTE: The ZB200 Bridge is set up for DHCP via Ethernet by default, therefore the following steps are only necessary if you are changing to a Static IP address or Wi-Fi.

1. Download the Zebra Setup Utility App for Electronic Temperature Sensors for Android (ZBSetup) from the Google Play store on your mobile device.

2. Ensure Bluetooth is enabled on your mobile device and then click **Configure Bridge** (1) on the splash screen.

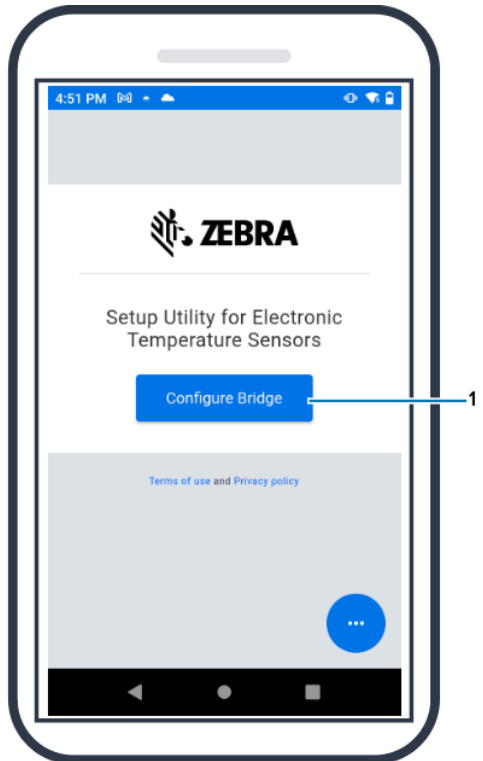

3. Press and hold **Pair** (2) on the front of the Bridge until the Status LED (3) blinks blue. This puts the Bridge into Bluetooth pairing mode.

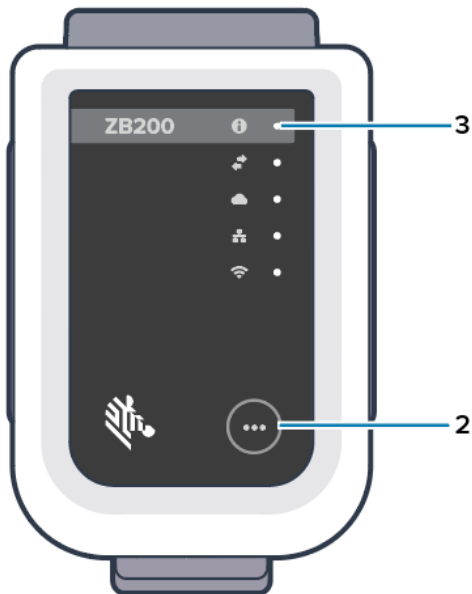

4. Click **Continue** (4).



5. The Setup Utility App scans for nearby Bridges.

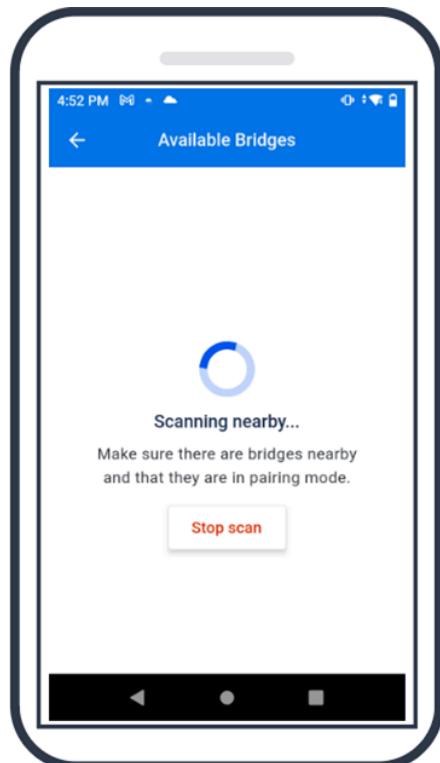

Using the Device

6. Select the Bridge from the list that matches the Bluetooth MAC address on the back of the Bridge you want to configure.



7. Click **Pair** (5) to continue.

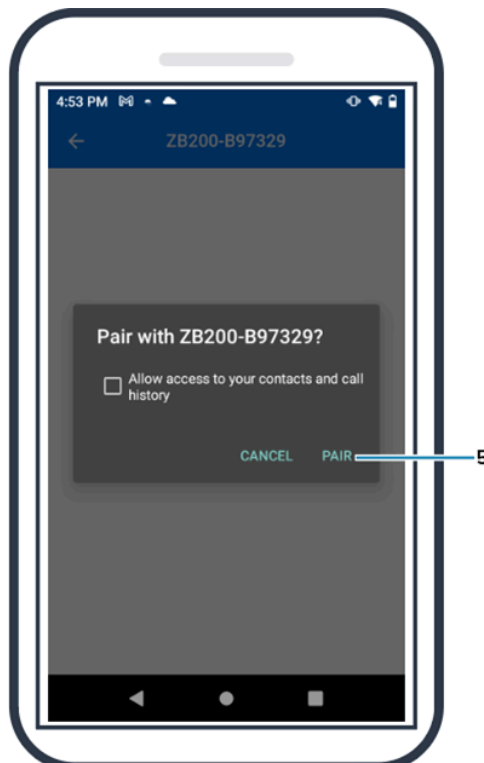

8. Manually enter valid Latitude (6) and Longitude (7) coordinates for the Bridge, or click **Use Your Location** (8) to get coordinates from your mobile device, for the Bridge to add location to sensor data uploads.

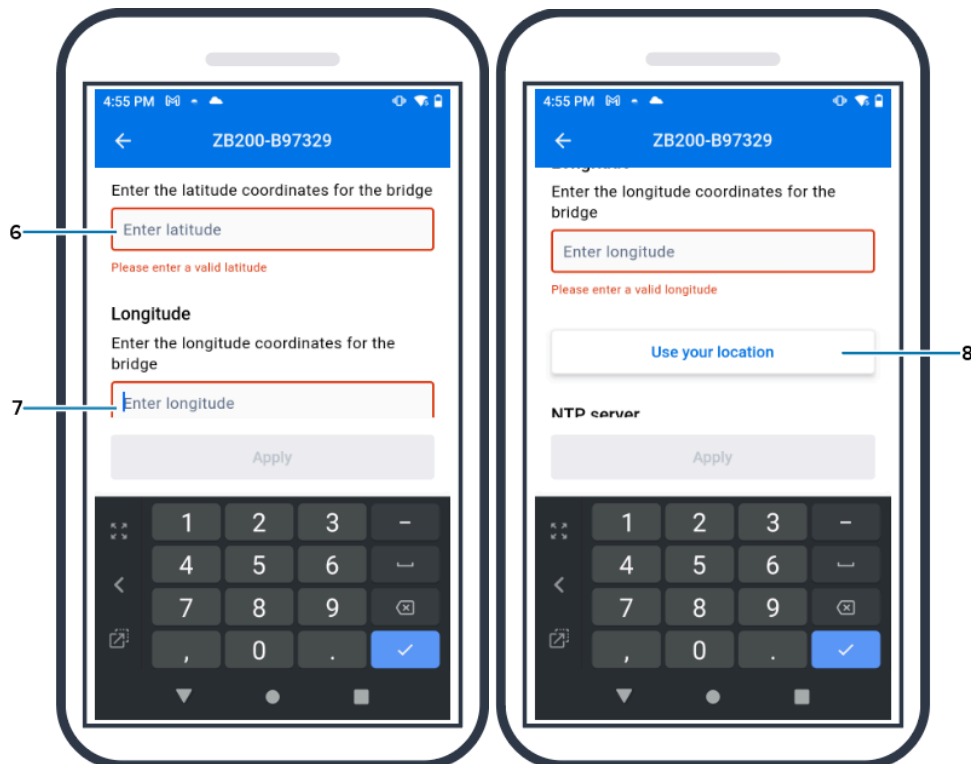

9. Select **Wireless** (9) or **Wired** to set the preferred Network connection type.

10. If you choose **Wireless**, click on the arrow next to **Available Networks** (10) to select your preferred Wi-Fi network from the list.

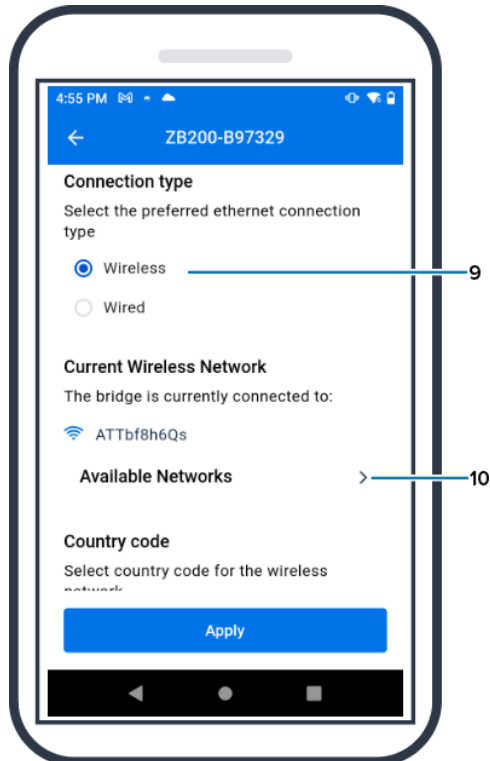

11. To enter your network manually, click on the arrow (11) and enter the **Network Name** (12) and the appropriate **Security** (13) from the dropdown list.

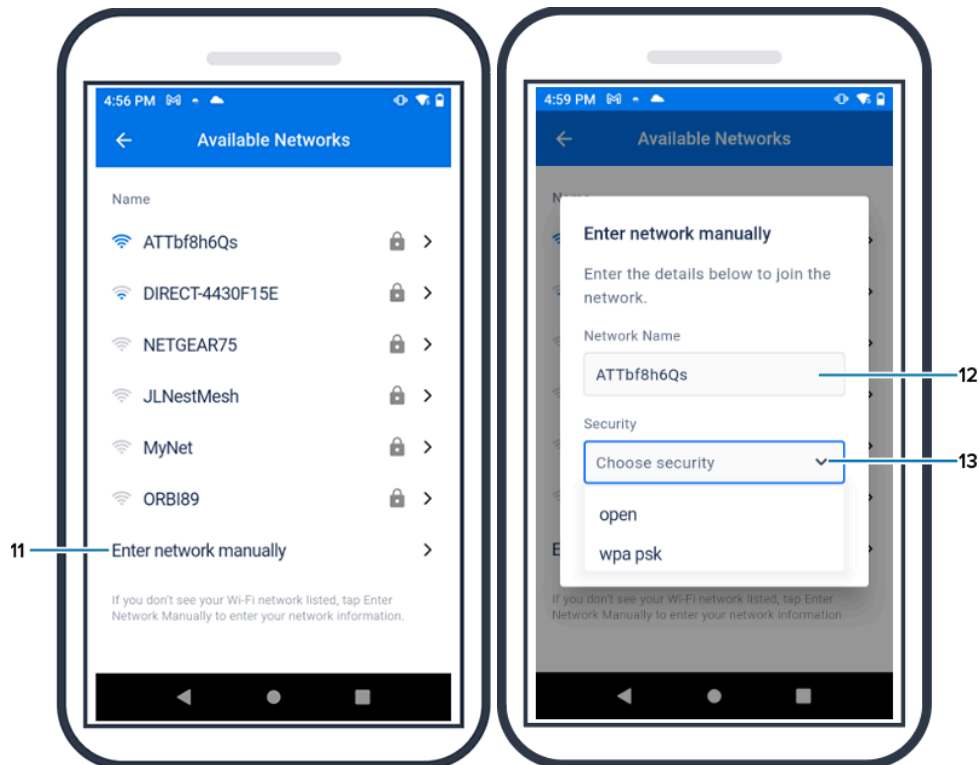

12. Enter the required password to join the network and click **OK** (14).

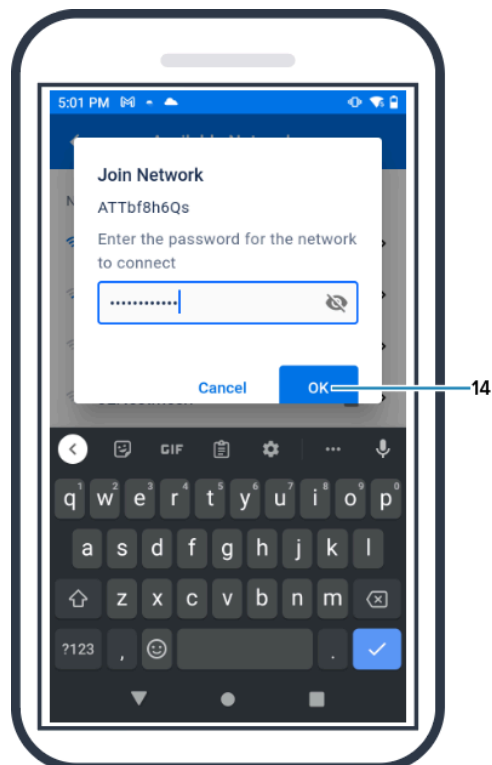

13. Select the appropriate Country Code from the dropdown menu (15).

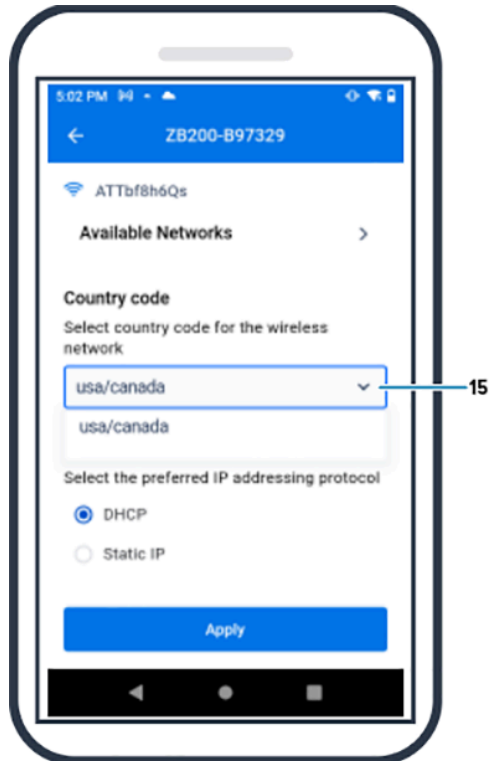

- DHCP is the default IP Addressing Protocol. If you want to switch to Static IP (16), select that as your preferred IP Addressing Protocol, then enter the IP Address (17), Subnet Mask (18), Gateway (19), and DNS Servers (20). Click **Apply** (21).

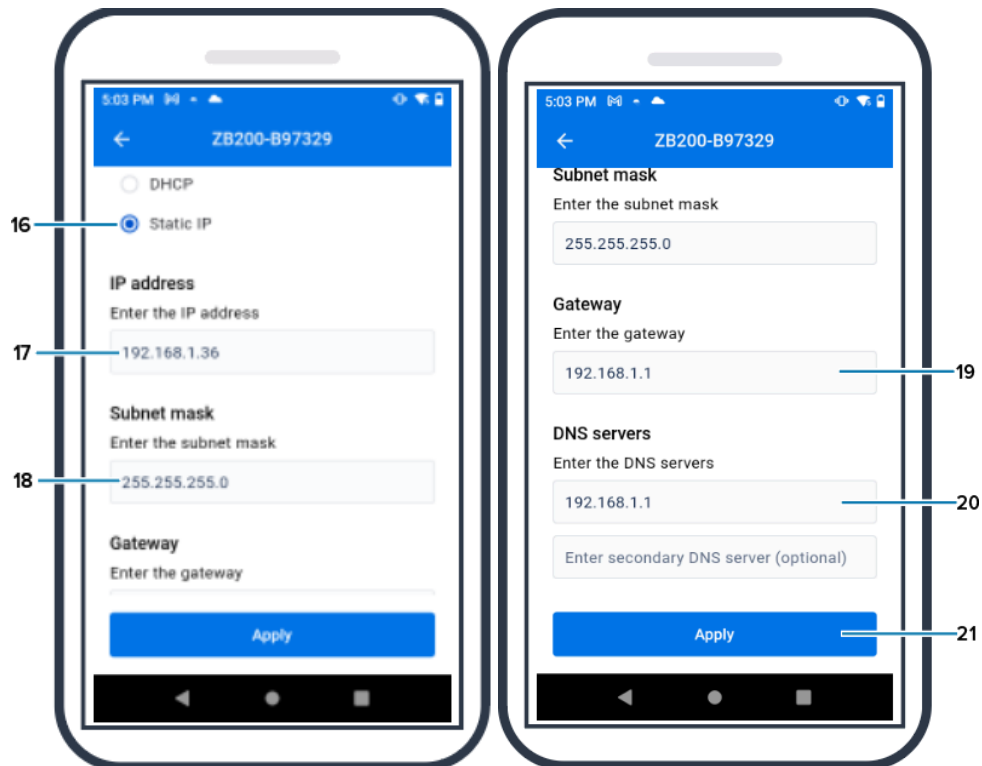

15. Bridge configuration is now complete.

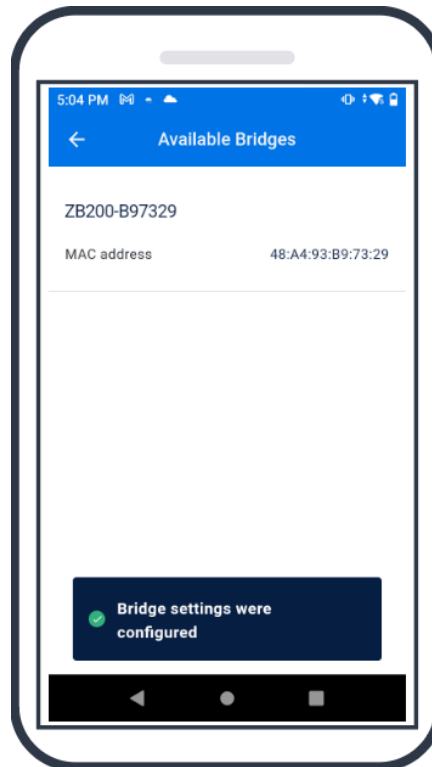

When you have successfully connected to the network, whether wired or wireless, the LED next to the appropriate icon on the front of the Bridge will light up.



NOTE: When DHCP is used, both the IP address and Subnet Mask are automatically obtained by the Bridge.

Maintenance and Troubleshooting

The ZB200 Bridge does not require much maintenance, however, there are specific cleaning requirements that are detailed in this section. Also detailed in this section are troubleshooting scenarios and frequently asked questions (FAQs).

Cleaning the Bridge

As the ZB200 is used in locations subjected to different environmental conditions, there will likely be a need to clean the device occasionally. Here are some recommendations and guidelines for cleaning your device.

- Only use the approved cleaning and disinfecting agents listed below to avoid damage to the device.
- Follow the manufacturer's directions on the approved cleaning and disinfecting agent for the proper and safe use of the product.
- Use pre-moistened wipes or a damp, soft sterile cloth with the approved agent. Never spray or pour chemical agents directly onto the device.
- Use a moistened cotton-tipped applicator to reach tight areas. Be sure to remove any lint left over by the applicator.
- Do not allow liquid to pool on the device.
- Clean and fully dry at room temperature before use. Exposing products to elevated temperatures before drying may cause product damage.
- The combining of chemical agents may be hazardous to both the user as well as the device. Always follow the safety instructions provided by the manufacturer, as well as the Zebra cleaning and disinfecting guidelines.
- The use of non-approved cleaners or disinfecting agents, or not following the recommended cleaning guidelines, may result in damage to the product and void the warranty.

Approved Cleaning Agents

The following are approved cleaning agents for use with the ZB200 Bridge.

- Sani-Cloth HB Wipes
- Super-Sani Cloth Wipes
- Sani-Cloth Plus Wipes
- Sani-Cloth Bleach Wipes

- Clorox Healthcare Hydrogen Peroxide Wipes
- Diversey Oxivir TB Wipes
- MadaCide-FDW-Plus Wipes
- CaviWipes Disinfectant Towelettes
- CaviWipes Bleach 1:10 Bleach Dilution Disinfecting Towelettes
- Windex Blue
- 409 General Purpose Cleaner

Troubleshooting

This section provides some basic troubleshooting information for the ZB200 Bridge. For API-related questions and issues, reference API documentation on the Developer Portal at developer.zebra.com/apis.

Table 1 Troubleshooting the Bridge

Issue	Possible Cause	Possible Resolution
<p>After installing the Bridge, users cannot see uploaded data from their sensors.</p>	<ul style="list-style-type: none"> • A connection to the cloud has not been established. • Firewall may be blocking the connection (for example, connected to network but not to the outside world). • Connections to the Bridge are not secure (for example, USB power cable or Ethernet cable). • Bridge does not have a proper line of sight to the sensors. • Power adapter is not Zebra-approved. • Sensor is not within normal operating range to the Bridge. • Sensor battery is dead. 	<ul style="list-style-type: none"> • Ensure cloud connection LED on the Bridge is lit green to show an established connection. • Reboot the system by unplugging the USB power connector and waiting 30-60 seconds before plugging it back in. • The Bridge requires access to the following destinations and ports: register-device.zpc.zebra.com, port 443 and zb-device.zpc.zebra.com, port 443. • Ensure all connections to the Bridge are secure. (Either wired or wireless LED must be lit green depending on your set-up. If lit red, check your network connections or wireless configuration.) • Ensure there is proper line of sight between Bridge and sensor. • Ensure Bridge is installed in a central location at least 3 feet from other electronic equipment to minimize interference. • Ensure you are using a Zebra-approved power adapter. • Ensure Sensor collecting the data is within normal operating range to the Bridge and not blocked or obstructed. • Replace Sensor if battery is dead.

Table 1 Troubleshooting the Bridge (Continued)

Issue	Possible Cause	Possible Resolution
<p>Bridge is not pairing to the Android mobile setup utility via Bluetooth during Bridge network setup.</p>	<ul style="list-style-type: none"> • Bridge is not in Bluetooth pairing mode. • Android Setup Utility is not open. • Bridge has been reset and no longer recognizes the mobile device that was previously used to configure it. • Bluetooth is not on in mobile device. • Bridge is out of Bluetooth range of the mobile device. • Proper permissions have not been given to the Android mobile application to enable Bluetooth. 	<ul style="list-style-type: none"> • Press and hold the button on the front of the Bridge until the status light blinks blue. • Open the Android mobile setup utility to the Bridge Network Setup page. • Clear the Bridge out of the Bluetooth device list on the mobile device. • Go into Bluetooth settings on mobile device and “forget” or unpair the Bridge and then attempt pairing again. • Ensure Bluetooth is On in your mobile device. • Ensure Bridge is in close proximity of mobile device for Bluetooth to work. • Try using another Android mobile device. • Ensure that the Android version is 8.1 or higher. • Ensure proper permissions have been given to the Android mobile application to enable Bluetooth.
<p>Unable to establish a wireless connection between the Bridge and access point.</p>	<ul style="list-style-type: none"> • Wrong password is entered. • Do not have correct certificate or have an invalid certificate. • Access point could have a security that is not supported. • Captive networks are not supported, for example, any network that requires user to provide authentication on a screen. 	<ul style="list-style-type: none"> • Ensure WiFi password is correct. • Check certificates. • Check network name. • Check type of enterprise security selected. • Check with your IT administrator to resolve any network-related issues.

Frequently Asked Questions

This section provides a simple reference for the most commonly asked questions related to the ZB200 Bridge and the answers to those questions.

Table 2 FAQs

Question	Answer
What is included in the box with the Bridge?	The Bridge comes with a USB A-to-C locking cable, mounting bracket, and a Quick Start Guide.
How do I power my Bridge?	The Bridge should only be used with the Zebra-approved power adapter (available as an accessory and sold separately).
How do I clear all my network settings from the Bridge?	Insert a paper clip in the hole next to the USB connector and press for 6 seconds while the Bridge is on.
How do I configure a Bridge?	Go to the Bridge Network Setup page on the navigation page of the Zebra Setup Utility for Electronic Temperature Sensors for Android app.
How do I access the Zebra Setup Utility for Electronic Temperature Sensors for Android app?	Go directly to the Google Play store to download the app.
How do I know if my Bridge is connected to the Cloud?	The Bridge is connected to the Cloud when the Cloud connection light on the Bridge is lit (LED is green if connection established).
How do I mount the Bridge?	Mount the wall bracket in the desired location, insert the bottom of the Bridge onto the bracket, and press down on the top of the Bridge until it snaps into place in the bracket.
How do I properly dispose of my Bridge?	Refer to the following link for product recycling information: zebra.com/recycle

Technical Specifications

This section details basic specifications for the ZB200 Bridge.

Physical Characteristics	
Dimensions	160 mm L x 100 mm W x 36 mm H (6.3 in L x 3.9 in W x 1.4 in H)
Weight	172.4 g (6.1 oz)
Case Material	Polycarbonate
IP Rating	IP50
Mounting	Mounting Bracket (hardware not included)
LED Indicators	Various Connectivity Status and Power Indicators
Traceability	Unique Serial Number and MAC ID

Operating Conditions	
Operating Temperature Range	0 to 50°C (32 to 122°F)
Operating Humidity Range	10-90% (non-condensing)
Storage Temperature Range	-25 to 65°C (-13 to 149°F)

Connectivity Specifications	
Bluetooth	Bluetooth Low Energy 4.1
WiFi	Dual Band 802.11ac
Ethernet	10/100

Minimum Connectivity Requirements	
Access via port 443 to register-device.zpc.zebra.com and zb-device.zpc.zebra.com for registration and data transfer to the Zebra Cloud Platform	
Power Supply	
External Power Supply	110-240V AC, USB Power Supply cable, power adapter ordered separately
Max Output Current	2.5 Amps

