

Contents of the box:

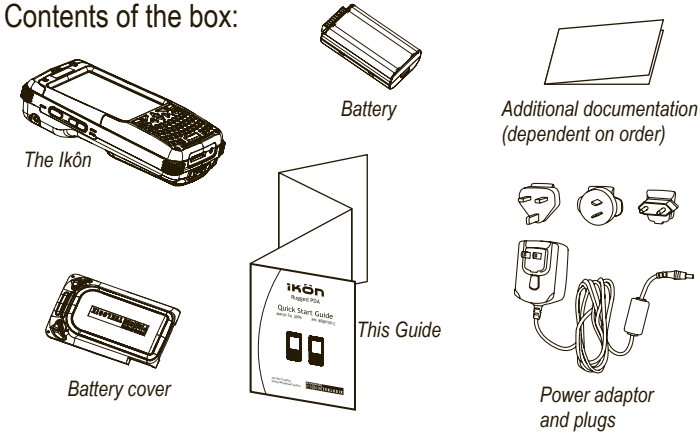

Features: Front And Ports

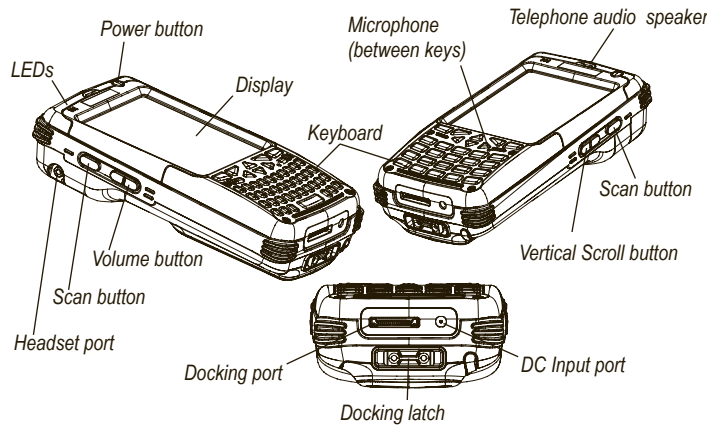

Features: Back

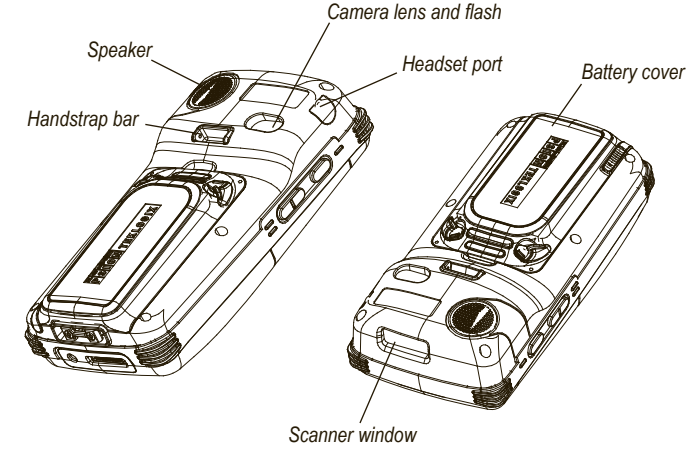

Features: QWERTY Keyboard

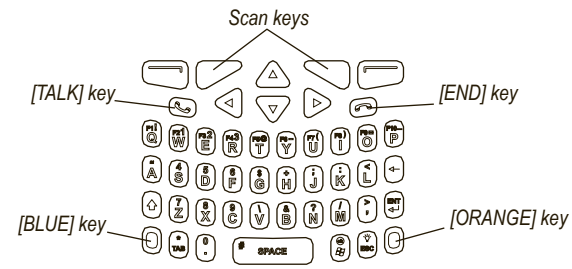

Features: Battery Compartment

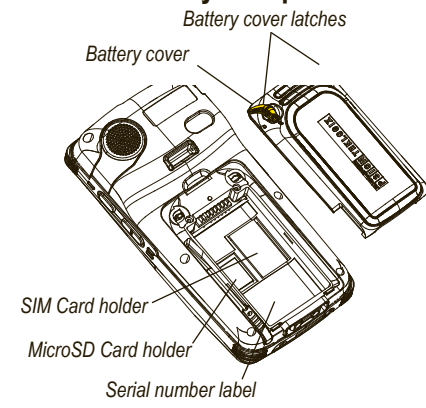

Important: Before removing the battery, power the Ikôn off as described at the end of this guide.

Features: Numeric Keyboard

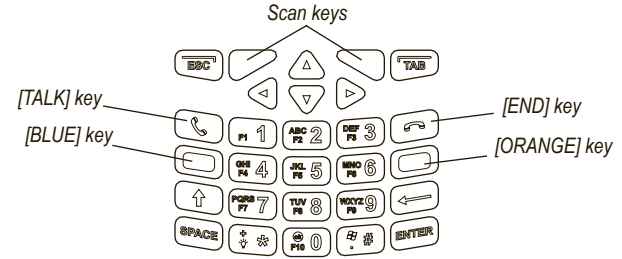

Note: On Ikôn units without the phone feature, the [TALK] key is replaced by an [ALT] key, and the [END] key is replaced by a [CTRL] key.

Turn the battery cover latches towards the outside of the unit to unlatch the battery cover; turn them towards the centre of the unit to latch the battery cover.

Closed and latched

Open and unlatched

Always place the latches in the unlatched position when removing or replacing the battery cover.

Getting Started

1 Unlatch and open the battery compartment.

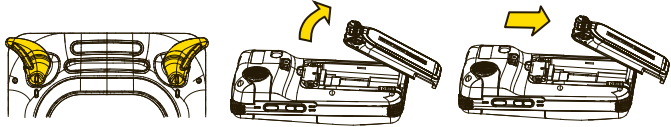

2 Insert the SIM card, if necessary.

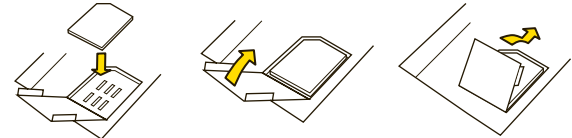

3 Insert the battery.

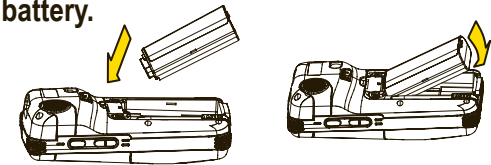

4 Close and latch the battery compartment.

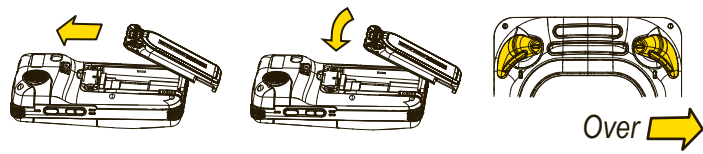

5**Charge the battery.**

The power adaptor may be plugged directly into the Ikôn.

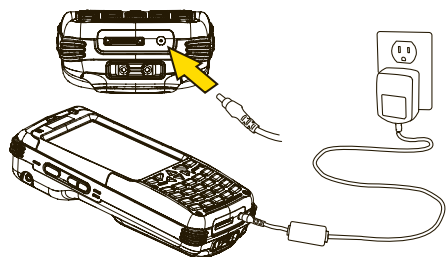

Note: Use only the universal AC power supply approved by Psion Teklogix for use with the Ikôn.

The Ikôn may also be charged in a Docking Station.

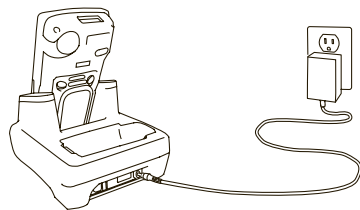

Note: Use only the universal AC power supply approved by Psion Teklogix for use with the Docking Station.

Allow the Ikôn to charge for four hours.



5 - 40 °C
41 - 104 °F



4h

Note: Full battery performance is only reached after the first few charge/discharge cycles.

6**Turn the unit on.**

Press the Power button for four seconds.

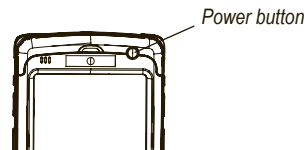
**7****Connect the Ikôn to the host computer.**

Connect using a Tether port to USB cable, or through a Docking Station.

8**Install ActiveSync®.**

Go to <http://go.microsoft.com/fwlink/?LinkId=147001> and follow the instructions to download and install ActiveSync 4.5 or higher.

Note: ActiveSync is not needed when connecting to a host computer that uses the Windows® Mobile Device Center (such as Microsoft® Windows Vista®).

9**Configure ActiveSync.**

Follow the onscreen instructions provided by ActiveSync to establish a connection between the host computer and the Ikôn in the Docking Station.

Before removing the battery, turn the Ikôn off as described below.

Failure to do so may cause the unit to become unresponsive, requiring it to be reset as described below.

To turn the Ikôn off, do one of the following:

- Press and hold the Power button until the **Shutdown** menu appears.
- Select **Shutdown** from the menu.

Resetting the unit:

Important: Resetting the unit may result in data loss.

To warm-reset the Ikôn:

- Press the [BLUE] and [ENTER] keys simultaneously for six seconds.
- Select **Shutdown** from the **Start** menu.

Psion Teklogix and Ikôn are trademarks of Psion Teklogix Inc. Other product names mentioned in this document are trademarks or registered trademarks of other hardware, software, or service providers and are used herein for identification purposes only.



8000150

Rev. D

ikôn™

Rugged PDA

Quick Start Guide

July 14, 2009

PN: 8000150.D

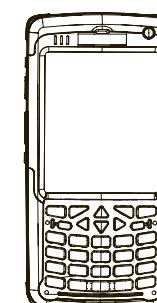
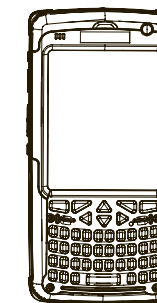

ISO 9001 Certified
Quality Management System

