

MC70

Quick Start Guide

FEATURES

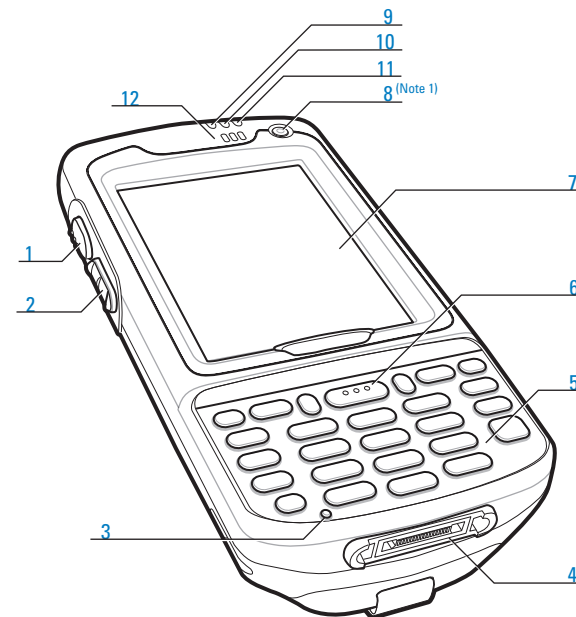

- | | | |
|----------------------|-------------------------|---------------------|
| 1 Scan/Action Button | 5 Keypad | 9 Scan/Decode LED |
| 2 Up/Down Button | 6 Scan/Action Button | 10 Charging LED |
| 3 Microphone | 7 Touch Screen | 11 Radio Status LED |
| 4 I/O Connector | (with screen protector) | 12 Phone Speaker |
| | 8 Power Button | |

Note 1: To reset the MC70, press and hold the Power button for five (5) seconds.

- | | | |
|-------------------|----------------------------|-------------------------|
| 13 Battery Door | 18 Speaker | 22 Scan/Action Button |
| 14 Door Latch | 19 Scan Window | 23 Action Button |
| 15 Handstrap | (see Data Capture Options) | 24 Back Housing Bracket |
| 16 Handstrap Slot | 20 Stylus | 25 Memory Card Slot |
| 17 Headset Jack | 21 Tether Point | |

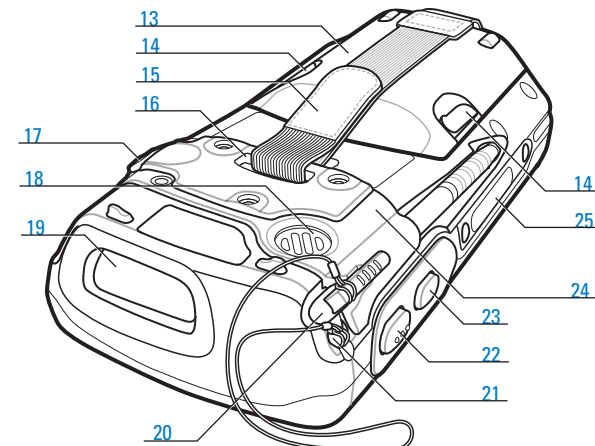

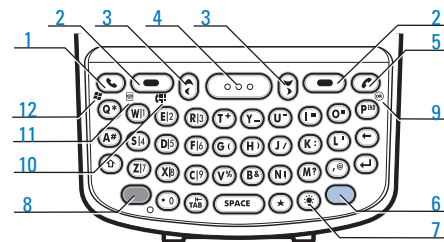

KEYPADS

- | | | | | | | | | |
|------------|----------------------|--------------|-------------|------------|------|-------------|---------|---------------|
| 1 Call | 3 Navigation | 5 End Call | 7 Backlight | 8 Blue Key | 9 OK | 10 Phonepad | 11 Menu | 12 Start Menu |
| 2 Soft Key | 4 Scan/Action Button | 6 Orange Key | | | | | | |



- Blue Key**
Use this key to launch applications and select items (shown on the keypad in blue).
> Press the  key once to activate this mode followed by another key.

- Orange Key**
Use this key to access the secondary layer of characters and actions.
> Press the  key once to lock the keypad in the Alpha state.
> Press the  key a second time to return to the normal state.

GETTING STARTED

1 Insert the Battery

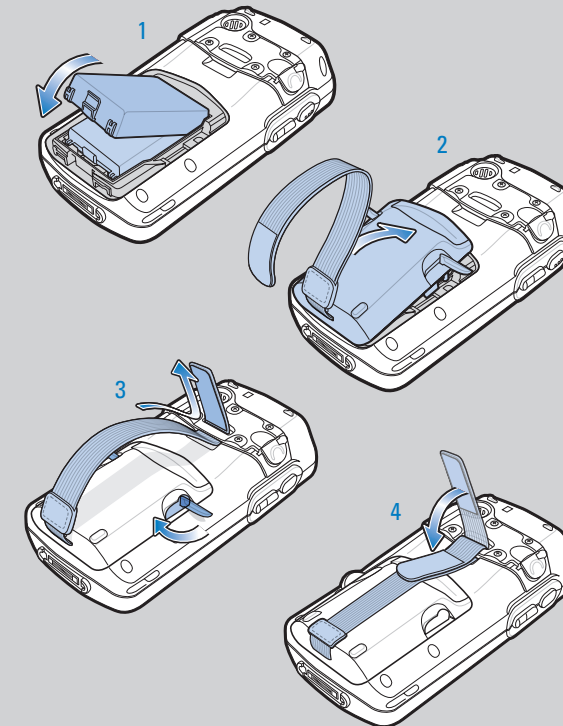

Note 2: Standard Capacity Battery and Door shown.

2 Charge the MC70 24hr*

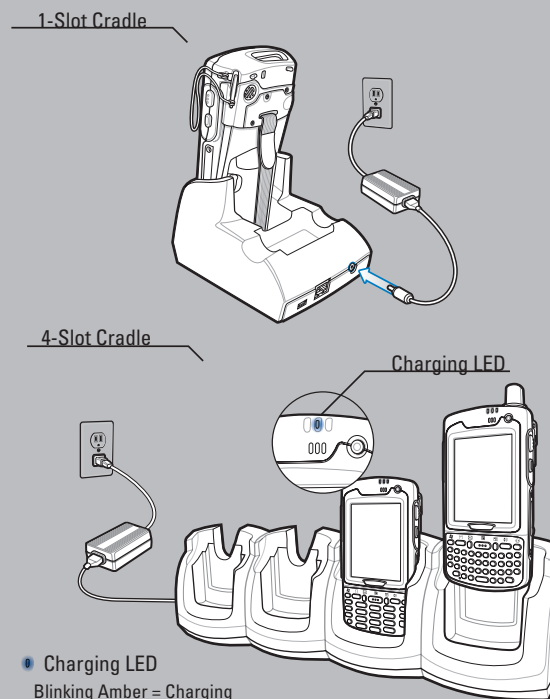

- Charging LED**
Blinking Amber = Charging
Solid Amber = Fully Charged
Fast Blinking Amber = Charging Error

* It is recommended that this product be charged for 24 hours before the first use to ensure that the internal battery is fully charged.

3 Install ActiveSync®

Download ActiveSync® 4.0 or higher from <http://www.microsoft.com> and follow the instructions to install ActiveSync onto the host computer.

4 Communicate with Host

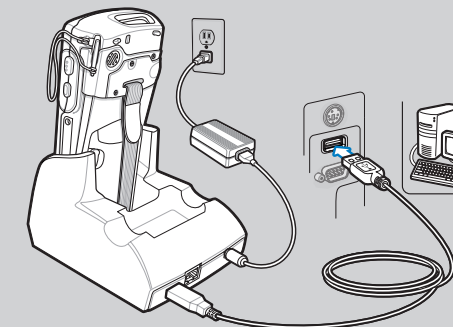

5 Create a Partnership

Follow the on-screen ActiveSync instructions to establish a connection between the MC70 and the host computer.

SUPPORT INFORMATION

More Information on the MC70

Visit the Zebra Web site at <http://www.zebra.com/mc70>
MC70 Companion CD

Setting up and using the MC70

MC70 User Guide
MC70 Integrator Guide
Available at: <http://www.zebra.com/mc70>

Troubleshooting

MC70 – MC70 User Guide
Accessories – MC70 Integrator Guide
Available at: <http://www.zebra.com/mc70>

Connecting and synchronizing with the host computer

ActiveSync® Help on the host computer. To view help, start ActiveSync®, click Help - Microsoft ActiveSync Help.

Information on using programs on the MC70

Tap Start – Help within the specific program.

Service and Warranty

Licensing, Patent and Regulatory Guide



Zebra Technologies Corporation
Lincolnshire, IL U.S.A.
Zebra and the stylized Zebra head are trademarks of ZIH Corp., registered in many jurisdictions worldwide. All other trademarks are the property of their respective owners. © 2015 ZIH Corp and/or its affiliates. All rights reserved.



72-71770-03 Rev. A March 2015

ACCESSORIES

Memory Card Installation

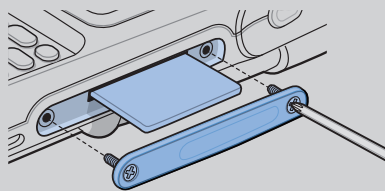

SIM Card Installation (Located Under Battery)

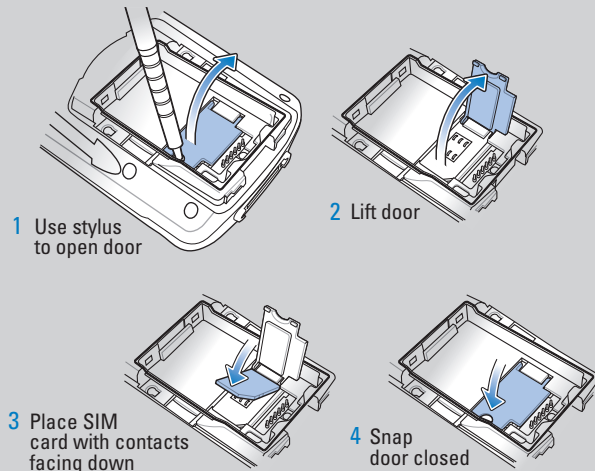

<http://www.zebra.com/mc70>

Screen Protector

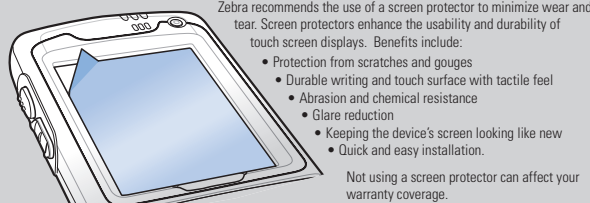

Zebra recommends the use of a screen protector to minimize wear and tear. Screen protectors enhance the usability and durability of touch screen displays. Benefits include:

- Protection from scratches and gouges
- Durable writing and touch surface with tactile feel
- Abrasion and chemical resistance
- Glare reduction
- Keeping the device's screen looking like new
- Quick and easy installation.

Not using a screen protector can affect your warranty coverage.

An initial screen protector is already applied to your MC70. Contact your local account manager or Zebra for more information and purchasing details. Part number: KT-67525-01 Screen Protector 3/pk.

Vehicle Cradle

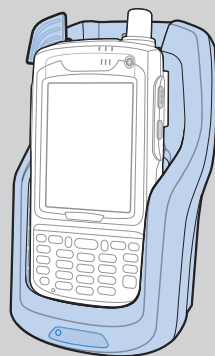

Trigger Handle

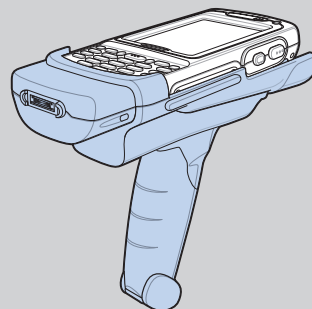

Standard Capacity Battery: ~ 4 hours Extended Capacity Battery: ~ 8 hours

Charge in Cradle

Flashing Amber: Battery charging
Solid Amber: Battery fully charged

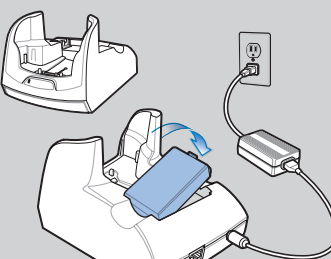

Spare Battery Charger

Flashing Amber: Battery charging
Solid Amber: Battery fully charged

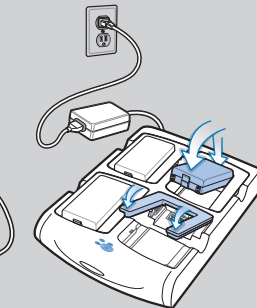

Snap-On Accessories

Magnetic Stripe Reader

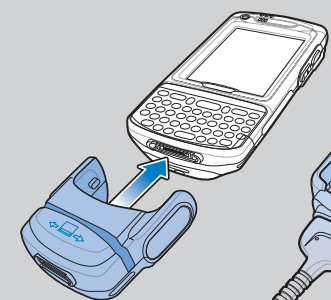

Cables

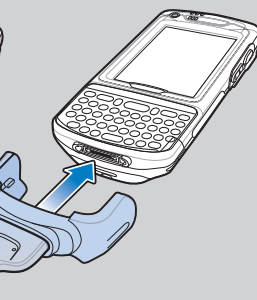

DATA CAPTURE OPTIONS

Scanner

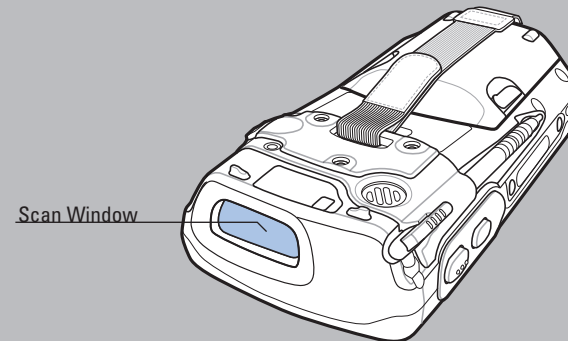

Imager

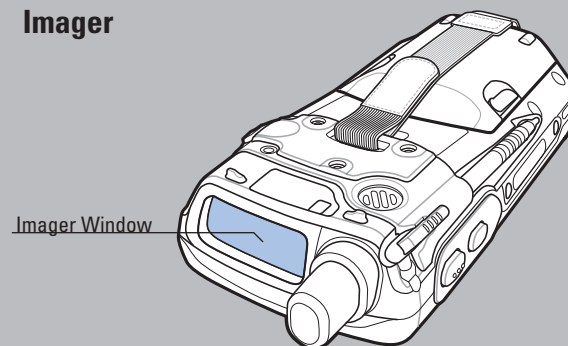

OPTIMUM SCANNING AND IMAGING

Scanning/Imaging

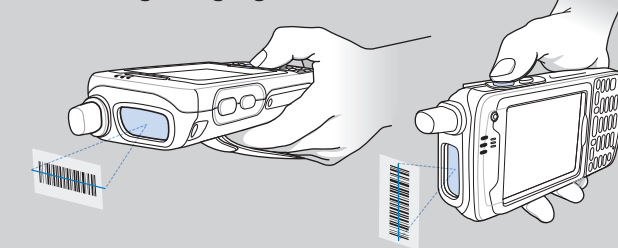

Scanning

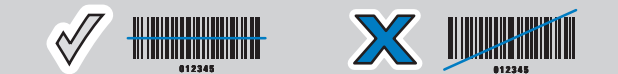

Imaging

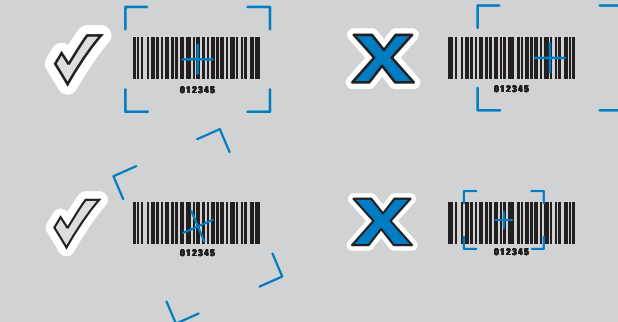

AVOID EXTREME WRIST ANGLES

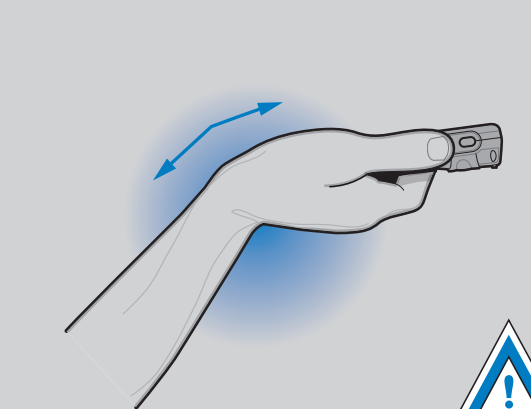

AVOID EXTREME WRIST ANGLES

