

VCD9000 Cradle

For MC9000 Mobile Computers

Quick Reference Guide

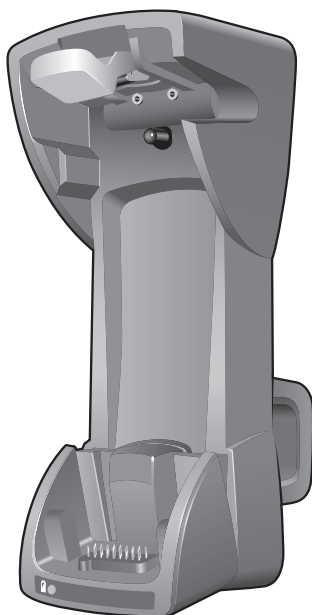

© 2015 Symbol Technologies, Inc.

Zebra reserves the right to make changes to any product to improve reliability, function, or design.

Zebra does not assume any product liability arising out of, or in connection with, the application or use of any product, circuit, or application described herein.

No license is granted, either expressly or by implication, estoppel, or otherwise under any patent right or patent, covering or relating to any combination, system, apparatus, machine, material, method, or process in which Zebra products might be used. An implied license exists only for equipment, circuits, and subsystems contained in Zebra products.

Zebra and the Zebra head graphic are registered trademarks of ZIH Corp. The Symbol logo is a registered trademark of Symbol Technologies, Inc., a Zebra Technologies company. Other product names mentioned in this manual may be trademarks or registered trademarks of their respective companies and are hereby acknowledged.

Zebra Technologies Corporation
Lincolnshire, IL U.S.A.
<http://www.zebra.com>

Warranty

For the complete Zebra hardware product warranty statement, go to:

<http://www.zebra.com/warranty>.

Introduction

This guide describes how to install and use a VCD9000 vehicle cradle with a MC9000 Series mobile computer.

Install the VCD9000 into the cab of the vehicle. Once installed, the cradle holds the mobile computer securely in place. It also:

- provides power for operating the mobile computer.
- provides a serial port for data communication between the mobile computer and an external device (e.g., a printer).
- re-charges the mobile computer's battery.
- re-charges a spare battery.

The vehicle's 12 V or 24 V electrical system powers the cradle. The operating voltage range is 9 V to 32 V and requires a maximum current of 4A.

About This Guide

Specific topics in this guide include:

- [*Requirements on page 4*](#)
- [*Parts on page 5*](#)
- [*Cradle Mounting on page 7*](#)
- [*Power Connection on page 9*](#)
- [*Serial Device Connection on page 11*](#)
- [*Mobile Computer Insertion and Removal on page 12*](#)
- [*Mobile Computer Battery Charging on page 13*](#)
- [*Spare Battery Insertion and Removal on page 14*](#)
- [*Spare Battery Charging on page 14*](#)
- [*LED Indicators on page 15*](#)
- [*Care and Cleaning on page 15*](#)
- [*Troubleshooting on page 16*](#)
- [*Regulatory Information on page 17*](#)
- [*Service Information on the back cover.*](#)

For detailed information on MC9000 Series mobile computers, refer to the mobile computer's *Quick Start Guide* or *Product Reference Guide*.

Requirements

- for mounting:
 - four 8-32 X 1" long screws with locking washers (provided as part of the cradle)
 - four #8 washers recommended
 - a drill with a #6 drill bit (0.204")
- for power connection:
 - power input cable (provided)
 - UL-listed in-line fuse rated 4A or 5A (both included), must be used if not connecting to vehicle's fuse panel.

For 12 V operation use UL-listed 5A fuse (included).

For 24 V operation use UL-listed 4A fuse (included).



WARNING! For continued protection against risk of fire, replace only with same type and rating of fuse according to the input voltage used.

- In-line fuse holder (included), must be used if not connecting to vehicle's fuse panel.
- for serial connection:
 - DB9 female serial cable (some external devices require a null modem cable)
- for communication:
 - an MC9000 Series mobile computer
 - setup of mobile computer and external device (as determined by the application used).

Parts

FRONT

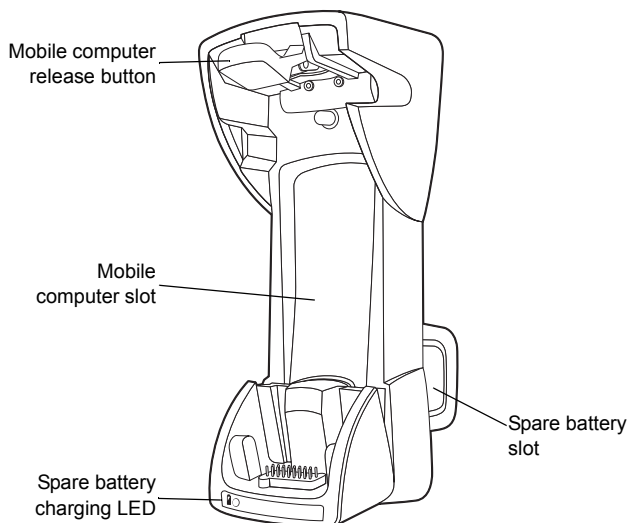

BACK

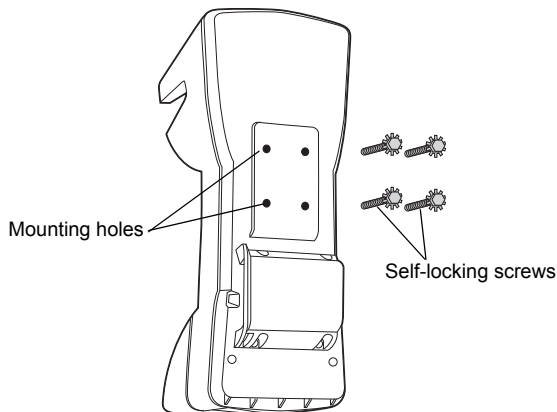

BOTTOM

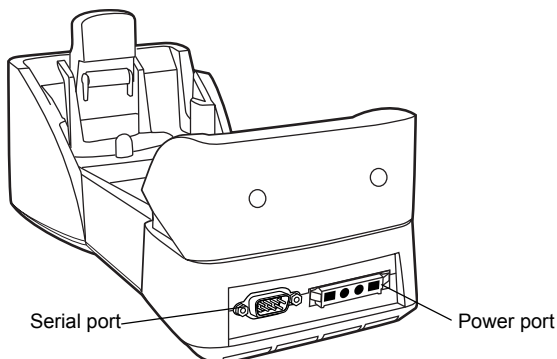

There are two connection ports on the bottom of the cradle:

| Ports | Function |
|--------|---|
| Serial | Standard RS-232 port for direct connection to a serial device using a serial cable. |
| Power | Connects to vehicle power using the power input cable. |



CAUTION ROAD SAFETY - Do not use the mobile computer while driving. Park the vehicle first. Ensure the mobile computer is fully inserted in the cradle. Do not place it on the seat or where it can break loose in a collision or sudden stop. Improper insertion can result in property damage or personal injury. Remember: Safety comes first.

Cradle Mounting



CAUTION Only mount the Vehicle Cradle in a vertical position with the release button at the top or in a horizontal position with the mobile computer display facing up. Never mount the Vehicle Cradle on the side or upside down or on a wall that can be subject to impact or collision of greater than 40Gs, in accordance with SAE J1455 Section 4.10.3.5.

1. If not using a mounting bracket or mounting device compatible with the VCD9000, prepare the mounting surface to accept four 8-32 X 1" long self-locking screws, using a copy of the mounting template below. Drill four holes (0.204" diameter) with a #6 drill bit.

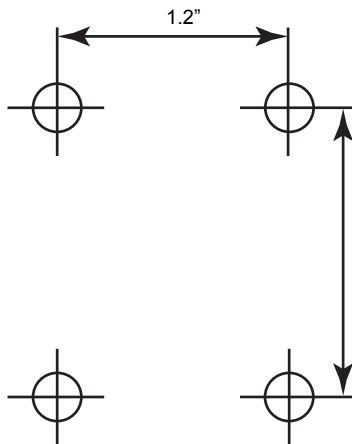

2. Remove the four self-locking screws from the back of the cradle.

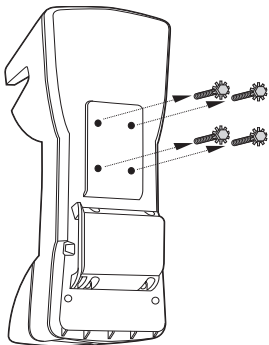

3. Place the back of the cradle on the mounting bracket or other mounting device/surface, with the four holes in the back of the cradle aligned with the four holes in the mounting surface.
4. Insert the four self-locking screws through the holes in the mounting surface, into the back of the cradle.

Zebra recommends using #8 washers to protect the mounting surface.

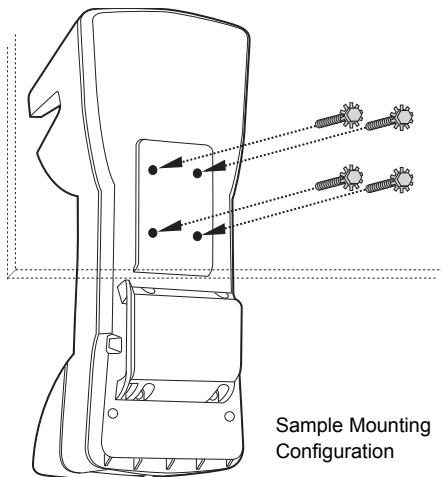

CAUTION Do not install the cradle on or near an air bag cover plate or within an aerobic zone. Also, do not install it in a location that affects vehicle safety or driving ability.

Power Connection

Read the following instructions completely before beginning.



WARNING! A properly trained technician must perform the power connection. Improper connection can damage the vehicle or cradle.

To connect the cradle to power:

1. Locate the vehicle power source.



NOTE An accessory output in the vehicle's fuse panel is the ideal location for connecting the vehicle cradle power input cable. The vehicle cradle should be added to a circuit with a maximum load capacity for the cradle and the original circuit. Refer to the vehicle's owner's manual for identification of the circuit. If a fused output is not available, the cradle must be installed with the provided in-line fuse holder and UL-listed fuse (rated 4A for 24 V operation, 5A for 12 V operation). The fuse protects the vehicle from an electrical short on the power line to the cradle.

To use the cradle to charge the mobile computer and spare battery, shut off the vehicle's ignition, then connect the cradle to unswitched power.

2. Route the power input cable from the cradle's power port to the connection point for the vehicle's power source.



CAUTION The means of routing and securing the power input cable from the cradle through to the vehicle power source is extremely important. Hazards associated with improper wiring can be severe. To avoid unintentional contact between the wire and any sharp edges, provide the cable with proper bushings and clamping where it passes through openings. If the wire is subject to sharp surfaces and excess engine vibration, the wiring harness insulation can wear away, causing a short between the bare wire and chassis. This can start a fire.

3. When using the supplied in-line fuse holder (which must be used if not connecting to the vehicle's fuse panel):
 - a. Ensure the fuse holder contains a UL-listed fuse (rated 4A for 24 V operation, 5A for 12 V operation).

- b. Splice the fuse holder to the end of the red V+ wire, as shown below. Make the distance from the fuse to the power connection point as short as possible.

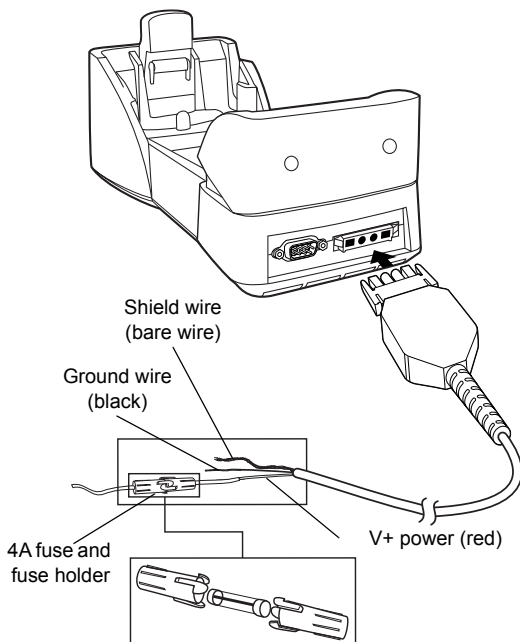

4. Prepare the cable termination.

- a. Red wire: connect to a +12/24 V vehicle power source.
- b. Black wire and shield wire: connect to vehicle ground wire or chassis ground.



NOTE How the cable terminates depends on the vehicle. If the vehicle has a power output connector, attach a mating connector to the end of the power cable. You may be able to connect to a fuse panel with a simple blade terminal or commercially available connector. Consult the vehicle owner's manual for information on how to access the vehicle's power supply.

5. Connect the power input cable to the power port on the cradle.

To see if the cradle has power, insert the mobile computer. The mobile computer battery charging LED blinks amber to indicate charging, then turns solid amber when the battery is completely charged. See [LED Indicators on page 15](#) for other indications.

Serial Device Connection

When you insert the MC9000 into the cradle, the mobile computer's serial port connects to the cradle's serial port. The mobile computer can then use the cradle's serial port to communicate with an external device.

To provide serial communication between the mobile computer and a serial device, connect one end of the 9-pin serial cable to the serial port on the cradle, and the other end to the serial port on the serial device.

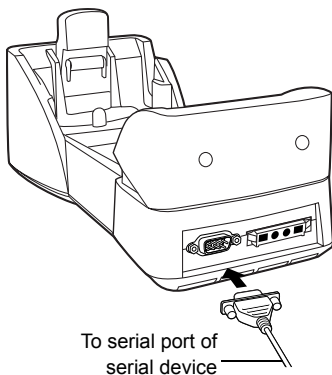

NOTE Some external devices may require a null modem cable.

To begin communication:

1. Insert the mobile computer into the cradle.
2. Initiate communication on the mobile computer, as determined by the application used.



CAUTION Removing the mobile computer during communication disrupts communication between the mobile computer and the attached device.

Mobile Computer Insertion and Removal

To insert the mobile computer into the cradle, place the bottom of the mobile computer into the bottom of the cradle, then press the mobile computer back into the cradle until the release button locks it in place.

Release button

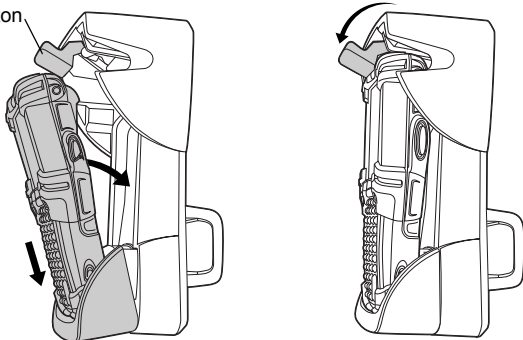

CAUTION Ensure the mobile computer is fully inserted into the cradle. Improper insertion can result in property damage or personal injury. Do not use the product while driving.

To remove the mobile computer from the cradle, lift the release button, then lift the mobile computer from the cradle.

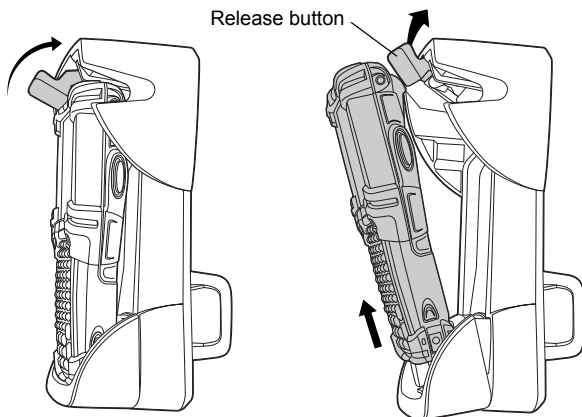

Mobile Computer Battery Charging

1. Ensure the cradle is connected to a power source. See [Power Connection on page 9](#).
2. Insert the mobile computer into the cradle. See [Mobile Computer Insertion and Removal on page 12](#).

The mobile computer starts charging when inserted. This does not deplete the vehicle battery significantly.

The mobile computer battery charging LED blinks amber to indicate charging, then turns solid amber when the battery is completely charged. The battery charges in approximately four hours. See [LED Indicators on page 15](#) for other indications.

Spare Battery Insertion and Removal

To insert a spare battery:

1. Insert the battery into the spare battery charging slot in the back of the cradle as shown.

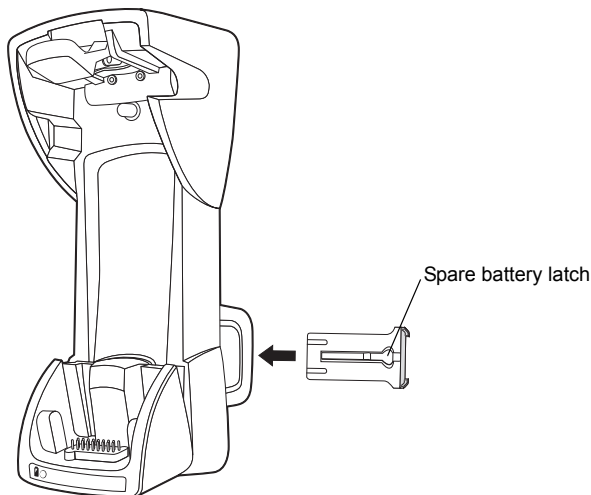

2. Push the battery in. Listen for the click that signifies the battery's latch has locked the battery into place.

To remove the spare battery, press in the battery latch, then remove the battery from the spare battery slot.

Spare Battery Charging

1. Ensure the cradle is connected to a power source. See [Power Connection on page 9](#).
2. Insert the spare battery into the cradle. See [Spare Battery Insertion and Removal on page 14](#).

The spare battery charging LED blinks amber to indicate charging, then turns solid amber when the battery is completely charged. The battery charges in approximately four hours. See [LED Indicators](#) for other indications.

LED Indicators

| Cradle LED | Indication |
|---|---|
| Mobile Computer Battery Charging LED | |
| Off | Mobile computer is not in cradle; mobile computer is not inserted correctly; cradle is not powered. |
| Fast Blinking Amber | Error in charging; check placement of mobile computer. |
| Slow Blinking Amber | Mobile computer is charging. |
| Solid Amber | Charging complete. |
|  Spare Battery Charging LED (on Cradle) | |
| Off | No spare battery in slot; spare battery is not inserted correctly; cradle is not powered. |
| Fast Blinking Amber | Error in charging; check placement of spare battery. |
| Slow Blinking Amber | Spare battery is charging. |
| Solid Amber | Charging is complete. |

Care and Cleaning

Avoid getting oils, grease, or gasoline on the cradle, and do not let debris gather in the bottom of the cradle slot. When necessary, clean the cradle with a mild cleaner. If necessary, contact Zebra for advice on whether to use a particular cleaner.

Troubleshooting

| Symptom | Possible Cause | Action |
|--|--|--|
| Mobile computer battery charging LED does not light. | Cradle is not receiving power. | Ensure the power input cable is securely connected to the cradle's power port. |
| Mobile computer's battery is not recharging. | Mobile computer was removed from the cradle too soon. | Replace the mobile computer in the cradle. If the mobile computer's battery pack is fully depleted, it can take four hours to fully recharge the battery. |
| | Battery is faulty. | Replace the battery. |
| | Mobile computer was not placed correctly in the cradle. | Remove the mobile computer from the cradle, and re-insert correctly. If the battery still does not charge, contact Customer Support. The mobile computer battery charging LED blinks amber when the mobile computer is correctly inserted and is charging. |
| No data was transmitted, or transmitted data was incomplete. | Mobile computer was removed from the cradle during communication. | Replace the mobile computer in the cradle and retransmit. |
| | The external device required a null modem cable, which was not used. | Retransmit using a null modem cable. |
| | Incorrect cable configuration. | See the system administrator. |

Regulatory Information

This guide applies to Model Number VCD5500.

All Zebra devices are designed to be compliant with rules and regulations in locations they are sold and will be labeled as required.

Any changes or modifications to Zebra equipment, not expressly approved by Zebra, could void the user's authority to operate the equipment.

Radio Frequency Interference Requirements-FCC



Note: This equipment has been tested and found to comply with the limits for a Class B digital device, pursuant to Part 15 of the FCC rules. These limits are designed to provide reasonable protection against harmful interference in a residential installation. This equipment generates, uses and can radiate radio frequency energy and, if not installed and used in accordance with the instructions, may cause harmful interference to radio communications. However there is no guarantee that interference will not occur in a particular installation. If this equipment does cause harmful interference to radio or television reception, which can be determined by turning the equipment off and on, the user is encouraged to try to correct the interference by one or more of the following measures:

- Reorient or relocate the receiving antenna
- Increase the separation between the equipment and receiver
- Connect the equipment into an outlet on a circuit different from that to which the receiver is connected
- Consult the dealer or an experienced radio/TV technician for help.

Radio Frequency Interference Requirements - FCC

This device complies with Part 15 of the FCC Rules. Operation is subject to the following two conditions: (1) this device may not cause harmful interference, and (2) this device must accept any interference received, including interference that may cause undesired operation.

Radio Frequency Interference Requirements - Canada

This Class B digital apparatus complies with Canadian ICES-003.

Cet appareil numérique de la classe B est conforme à la norme NMB-003 du Canada.

CE Marking and European Economic Area (EEA)

Statement of Compliance

Zebra Technologies Corporation, hereby, declares that this device is in compliance with all the applicable Directives, 2004/108/EC, 2006/95/EC, and 2011/65/EU. A Declaration of Conformity may be obtained from <http://www.zebra.com/doc>.

Safety Instructions

An air bag inflates with great force. DO NOT place objects, including either installed or portable wireless equipment, in the area over the air bag or in the air bag deployment area. If in-vehicle wireless equipment is improperly installed and the air bag inflates, serious injury could result.

Position your device within easy reach. Be able to access your device without removing your eyes from the road.

Do not take notes or use the device while driving. Jotting down a "to do" list or flipping through your address book takes attention away from your primary responsibility, driving safely.



Waste Electrical and Electronic Equipment (WEEE)

English: For EU Customers: All products at the end of their life must be returned to Zebra for recycling. For information on how to return product, please go to:
<http://www.zebra.com/weee>.

Čeština: Pro zákazníky z EU: Všechny produkty je nutné po skončení jejich životnosti vrátit společnosti Zebra k recyklaci. Informace o způsobu vrácení produktu najdete na webové stránce: <http://www.zebra.com/weee>.

Dansk: Til kunder i EU: Alle produkter skal returneres til Zebra til recirkulering, når de er udtjent. Læs oplysningerne om returnering af produkter på:
<http://www.zebra.com/weee>.

Deutsch: Für Kunden innerhalb der EU: Alle Produkte müssen am Ende ihrer Lebensdauer zum Recycling an Zebra zurückgesandt werden. Informationen zur Rücksendung von Produkten finden Sie unter <http://www.zebra.com/weee>.

Eesti: EL klientidele: kõik tooted tuleb nende eluea lõppedes tagastada taaskasutamise eesmärgil Zebra'ile. Lisainformatsiooni saamiseks toote tagastamise kohta külastage palun aadressi: <http://www.zebra.com/weee>.

Ελληνικά: Για πελάτες στην Ε.Ε.: Όλα τα προϊόντα, στο τέλος της διάρκειας ζωής τους, πρέπει να επιστρέφονται στην Zebra για ανακύκλωση. Για περισσότερες πληροφορίες σχετικά με την επιστροφή ενός προϊόντος, επισκεφθείτε τη διεύθυνση <http://www.zebra.com/weee> στο Διαδίκτυο.

Español: Para clientes en la Unión Europea: todos los productos deberán entregarse a Zebra al final de su ciclo de vida para que sean reciclados. Si desea más información sobre cómo devolver un producto, visite:
<http://www.zebra.com/weee>.

Français: Clients de l'Union Européenne: Tous les produits en fin de cycle de vie doivent être retournés à Zebra pour recyclage. Pour de plus amples informations sur le retour de produits, consultez : <http://www.zebra.com/weee>.

Български: За клиенти от ЕС: След края на полезния им живот всички продукти трябва да се връщат на Zebra за рециклиране. За информация относно връщането на продукти, моля отидете на адрес:
<http://www.zebra.com/weee>.

Italiano: per i clienti dell'UE: tutti i prodotti che sono giunti al termine del rispettivo ciclo di vita devono essere restituiti a Zebra al fine di consentirne il riciclaggio. Per informazioni sulle modalità di restituzione, visitare il seguente sito Web: <http://www.zebra.com/weee>.

Polski: Klienci z obszaru Unii Europejskiej: Produkty wycofane z eksploatacji należy zwrócić do firmy Zebra w celu ich utylizacji. Informacje na temat zwrotu produktów znajdują się na stronie internetowej <http://www.zebra.com/weee>.

Português: Para clientes da UE: todos os produtos no fim de vida devem ser devolvidos à Zebra para reciclagem. Para obter informações sobre como devolver o produto, visite: <http://www.zebra.com/weee>.

Lietuvių: ES vartotojams: visi gaminiai, pasibaigus jų eksploatacijos laikui, turi būti grąžinti utilizuoti į kompaniją „Zebra“. Daugiau informacijos, kaip grąžinti gaminį, rasite: <http://www.zebra.com/weee>.

Latviešu: ES klientiem: visi produkti pēc to kalpošanas mūža beigām ir jānogādā atpakaļ Zebra atreizējam pārstrādei. Lai iegūtu informāciju par produktu nogādāšanu Zebra, lūdzu, skatiet: <http://www.zebra.com/weee>.

Magyar: Az EU-ban vásárlóknak: Minden tönkrement termékét a Zebra vállalatához kell eljuttatni újrahasznosítás céljából. A termék visszajuttatásának módjával kapcsolatos tudnivalóért látogasson el a <http://www.zebra.com/weee> weboldalra.

Malti: Għal klijenti fl-UE: il-prodotti kollha li jkun u waslu fl-aħħar tal-ħajja ta' l-użu tagħhom, iridu jiġu rritornati għand Zebra għar-riċiklaġġ. Għal aktar tagħrif dwar kif għandek tirritorna l-prodott, jekk jogħġbok żur: <http://www.zebra.com/weee>.

Nederlands: Voor klanten in de EU: alle producten dienen aan het einde van hun levensduur naar Zebra te worden teruggezonden voor recycling. Raadpleeg <http://www.zebra.com/weee> voor meer informatie over het terugzenden van producten.

Românesc: Pentru clienții din UE: Toate produsele, la sfârșitul duratei lor de funcționare, trebuie returnate la Zebra pentru reciclare. Pentru informații despre returnarea produsului, accesați: <http://www.zebra.com/weee>.

Slovenčina: Pre zákazníkov z krajín EU: Všetky výrobky musia byť po uplynutí doby ich životnosti vrátené spoločnosti Zebra na recykláciu. Bližšie informácie o vrátení výrobkov nájdete na: <http://www.zebra.com/weee>.

Slovenski: Za kupce v EU: vsi izdelki se morajo po poteku življenjske dobe vrniti podjetju Zebra za reciklažo. Za informacije o vračilu izdelka obiščite: <http://www.zebra.com/weee>.

Suomi: Asiakkaat Euroopan unionin alueella: Kaikki tuotteet on palautettava kierrätettäväksi Zebra-yhtiöön, kun tuotetta ei enää käytetä. Lisätietoja tuotteen palauttamisesta on osoitteessa <http://www.zebra.com/weee>.

Svenska: För kunder inom EU: Alla produkter som uppnått sin livslängd måste returneras till Zebra för återvinning. Information om hur du returnerar produkten finns på <http://www.zebra.com/weee>.

Türkçe: AB Müşterileri için: Kullanım süresi dolan tüm ürünler geri dönüşürme için Zebra'ya iade edilmelidir. Ürünlerin nasıl iade edileceği hakkında bilgi için lütfen şu adresi ziyaret edin: <http://www.zebra.com/weee>.

Service Information

If you have a problem using the equipment, contact your facility's Technical or Systems Support. If there is a problem with the equipment, they will contact the Zebra Support at: <http://www.zebra.com/support>.

For the latest version of this guide go to: <http://www.zebra.com/support>.



Zebra Technologies Corporation
Lincolnshire, IL U.S.A.
<http://www.zebra.com>

Zebra and the Zebra head graphic are registered trademarks of ZIH Corp. The Symbol logo is a registered trademark of Symbol Technologies, Inc., a Zebra Technologies company.

© 2015 Symbol Technologies, Inc.



72-63295-04 Revision A - March 2015