

MC9190-G

Osnovne upute

UMETANJE BATERIJE

<http://www.zebra.com/mc9190g>

Dodatne informacije potražite u korisničkom priručniku

Pogled sprijeda

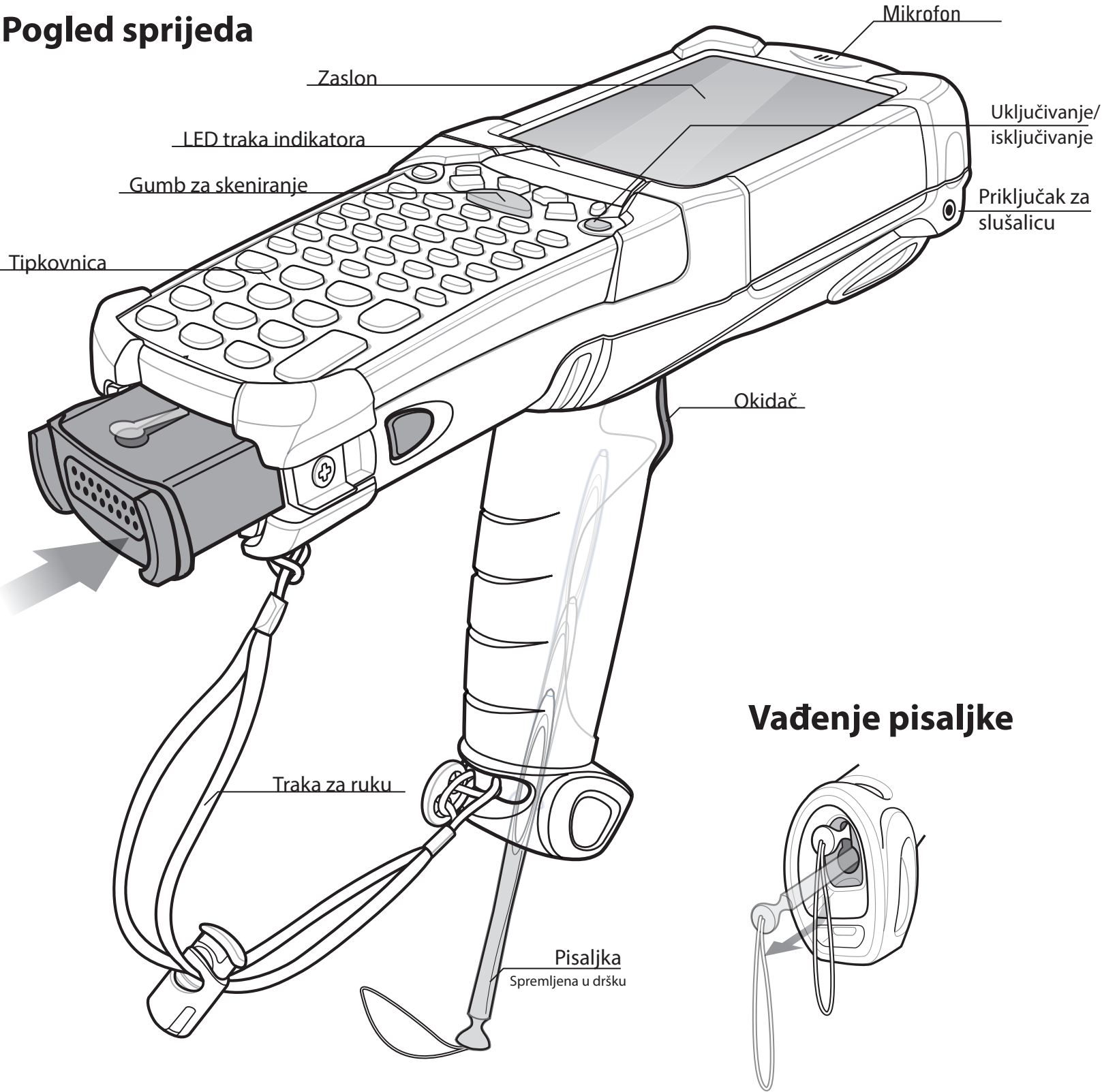

Vađenje baterije

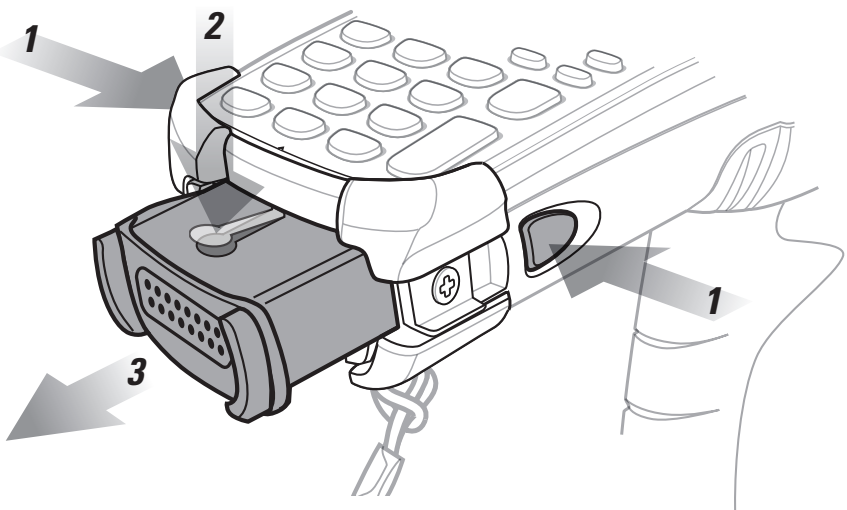

Vađenje pisaljke

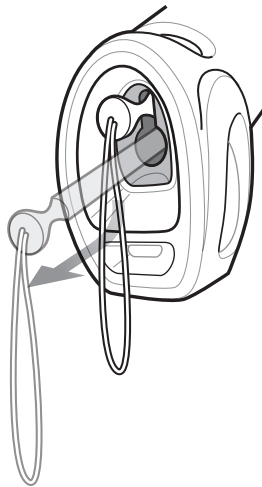

PRIKLJUČIVANJE DODATNE OPREME

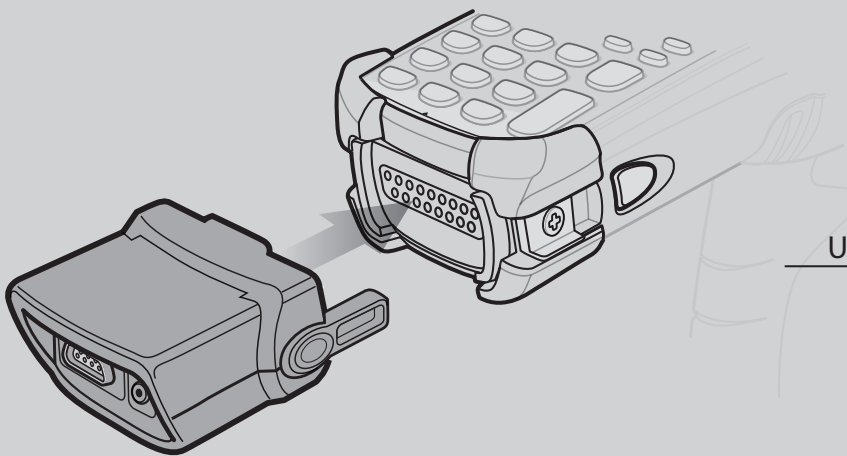

Podaci
Uključivanje/isključivanje

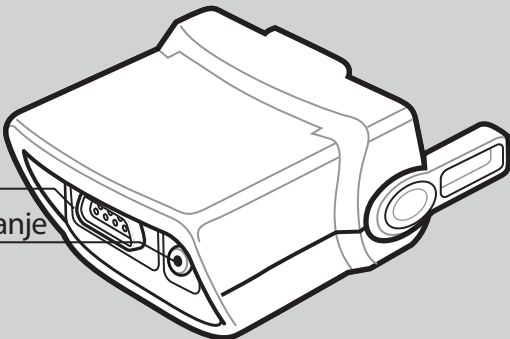

Modul adaptera kabela

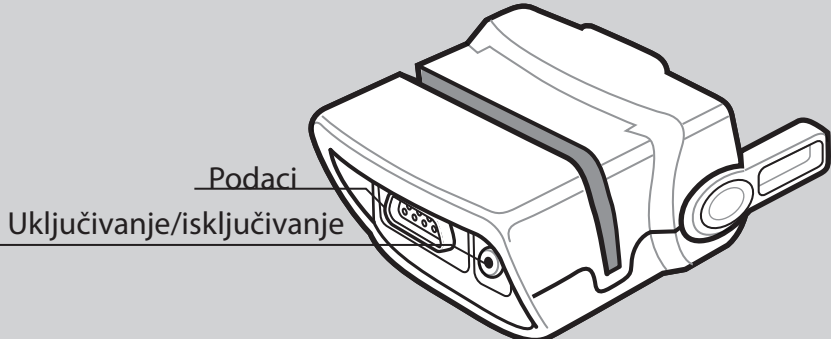

Podaci
Uključivanje/isključivanje

Čitač magnetske trake

UPUTE ZA PUNJENJE

⦿ = Lokacija LED indikatora Sporo bljeska = normalno punjenje Svijetli narančasto = uređaj napunjen Brzo bljeska = pogreška prilikom punjenja

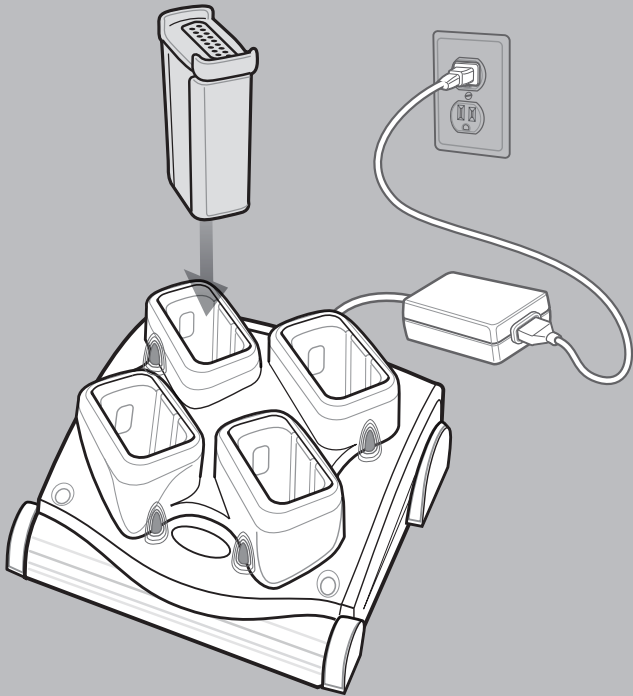

Punjač za rezervnu bateriju s četiri ležišta

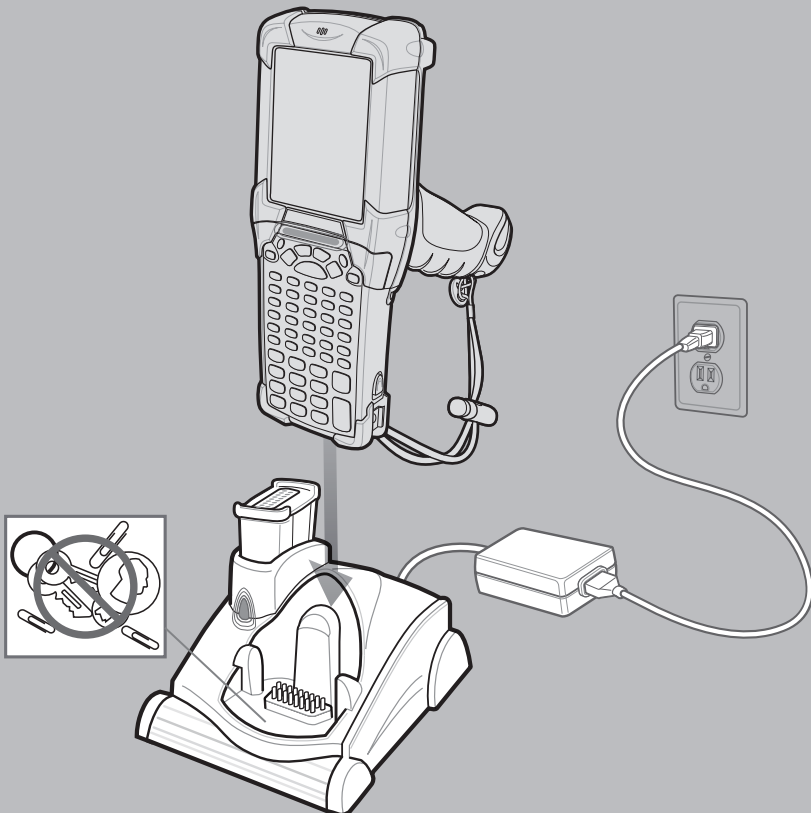

Postolje sa serijskim/USB priključkom s jednim ležištem

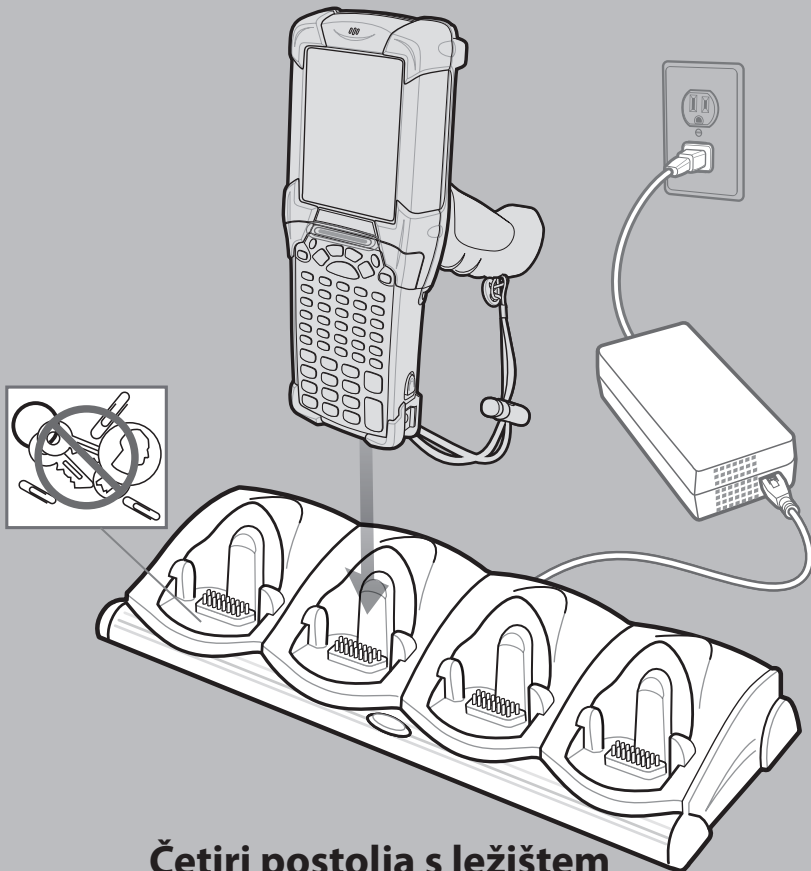

Četiri postolja s ležištem
Postolje za punjenje i Ethernet postolja

OPTIMALNI POLOŽAJI ZA SNIMANJE I SKENIRANJE

Lasersko skeniranje

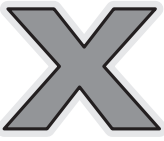

Snimanje standardnog dometa

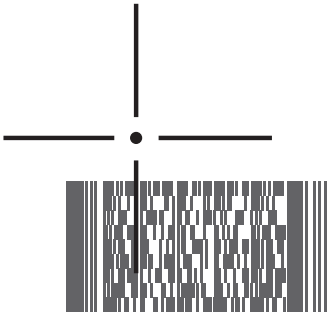
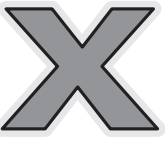
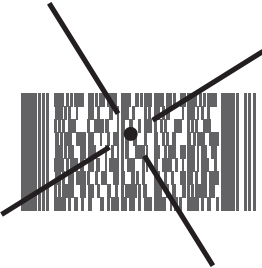

Snimanje dugog dometa

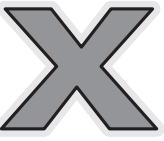
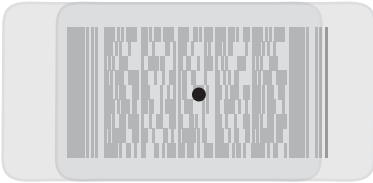
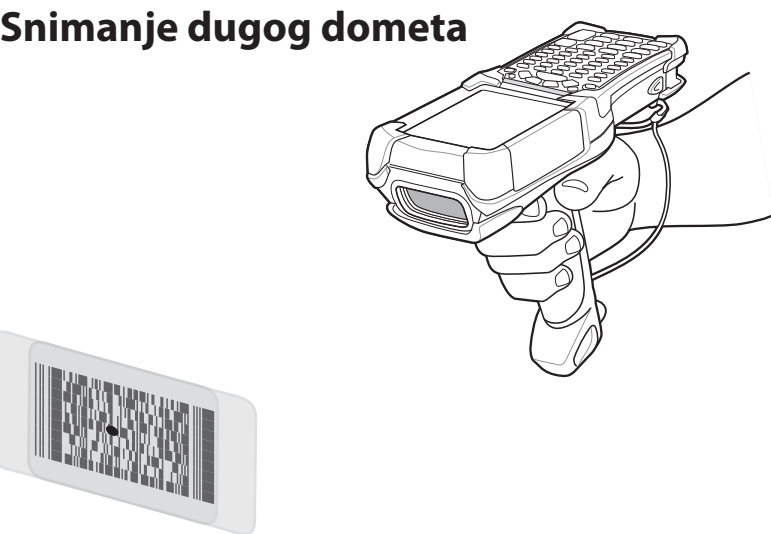

OPTIMALNI USPRAVNI POLOŽAJ TIJELA



NEMOJTE PREVIŠE SAVIJATI ZGLOB

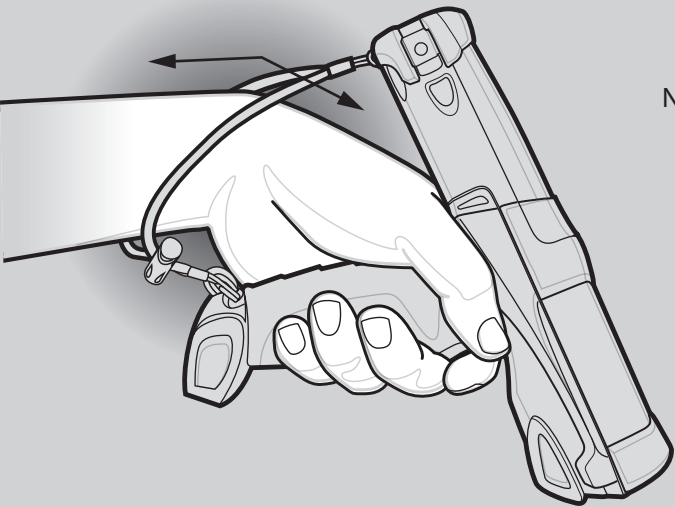

NEMOJTE PREVIŠE SAVIJATI ZGLOB

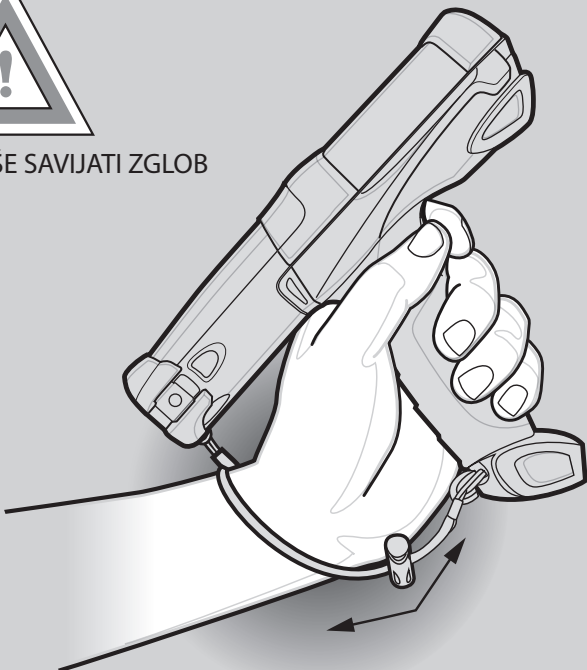

NAIZMJENCE KORISTITE LIJEVU I DESNU RUKU
PREPORUČUJE SE UZIMANJE PAUZA
I IZMJENA REDOSLIJEDA ZADATAKA

OPTIMALAN POLOŽAJ TIJELA

Skeniranje u niskom položaju

Naizmjenice koristite lijevu i desno koljeno



IZBJEĞAVAJTE SAVIJANJE

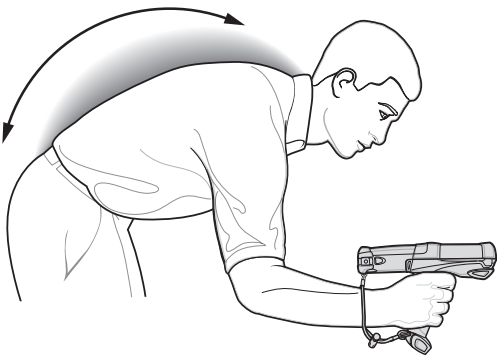

Naizmjenice koristite lijevu i desnu ruku



NEMOJTE PREVIŠE DIZATI RUKU



Skeniranje s visokog položaja

Koristite ljestve



Preporučuje se uzimanje pauza i izmjena redoslijeda zadataka



Zebra Technologies Corporation, Lincolnshire, IL USA
Riječ Zebra i grafički prikaz glave zebre registrirani su zaštitni znakovi tvrtke ZIH Corp. Logotip Symbol registrirani su zaštitni znak tvrtke Symbol Technologies, Inc., koja je dio tvrtke Zebra Technologies.
© 2015 Symbol Technologies, Inc.



72-139206-02HR Prerađeno izdanje B – Travnja 2015.



<http://www.zebra.com/mc9190g>

MC9190-G

Upute za preporučeno korištenje

IZLOŽITI U RADNOM PODRUČJU