

MC92N0-G

Guida introduttiva

<http://www.zebra.com/mc92n0-g>

Per ulteriori informazioni, consultare
la Guida dell'utente

INSERIMENTO DELLA BATTERIA

Vista anteriore

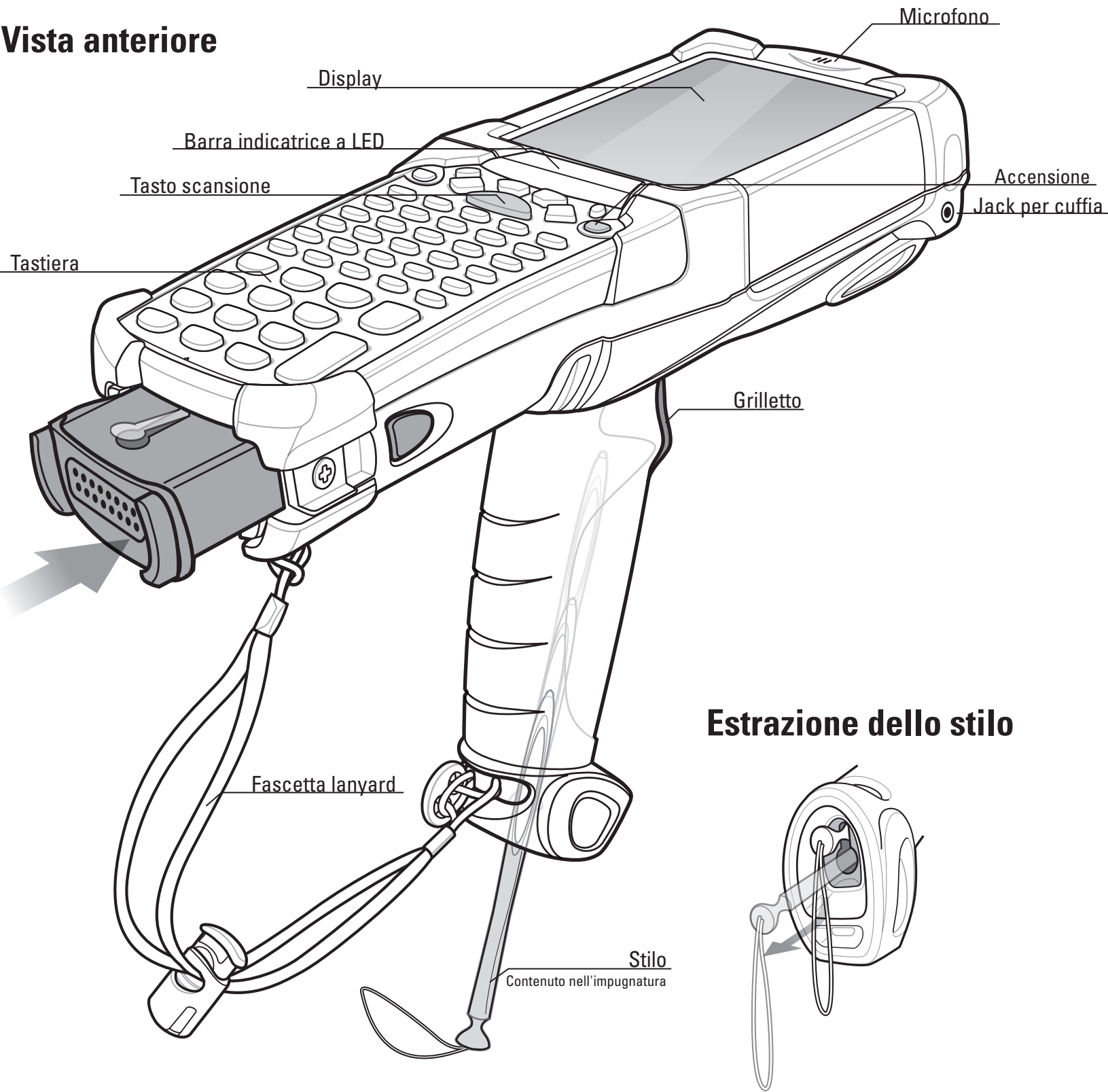

Rimozione della batteria

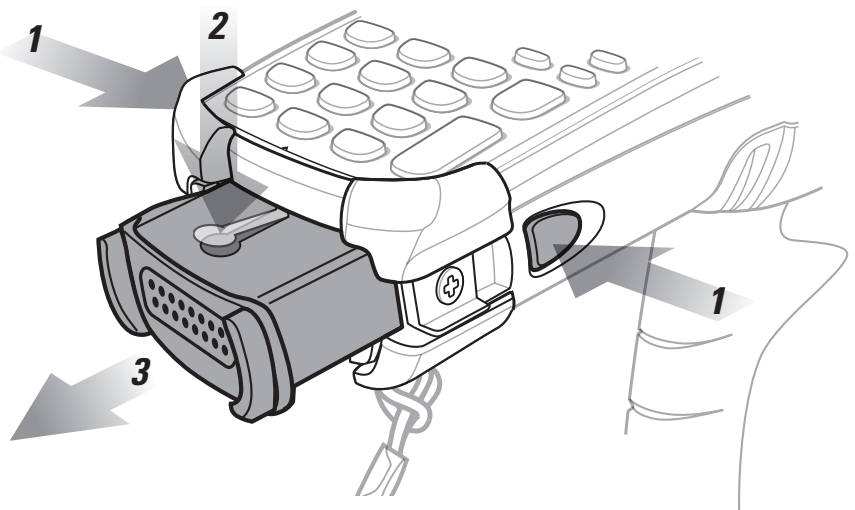

Estrazione dello stilo

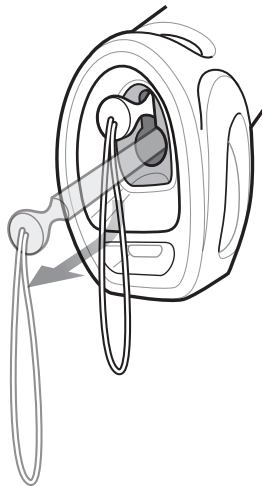

INSTALLAZIONE ACCESSORI SNAP-ON

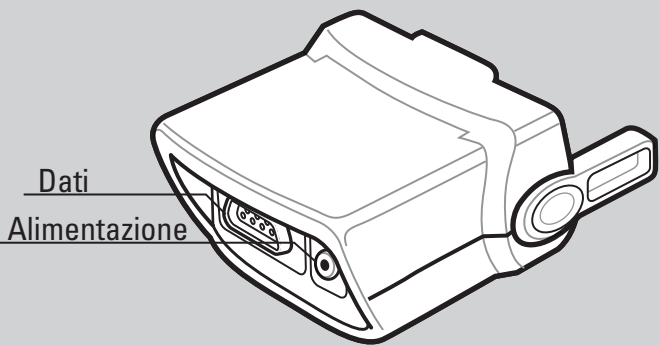
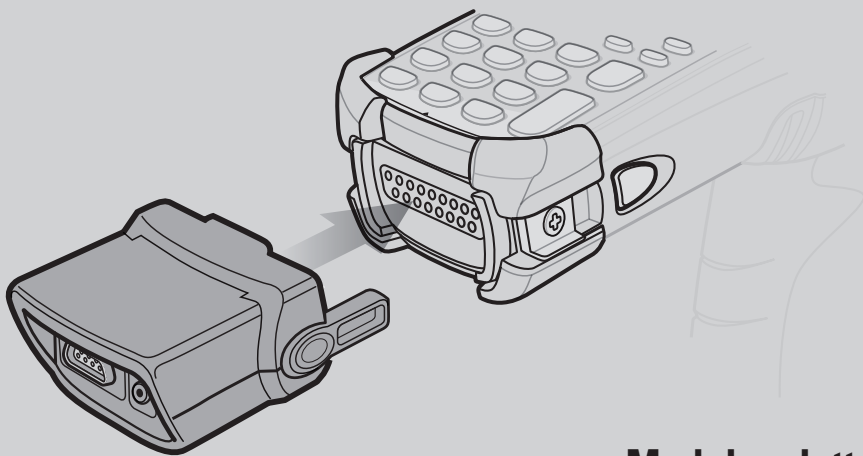

ISTRUZIONI DI RICARICA

☉ = Posizione dell'indicatore LED Lampeggio lento = Ricarica normale Giallo fisso = Ricarica completata Lampeggio rapido = Errore di ricarica

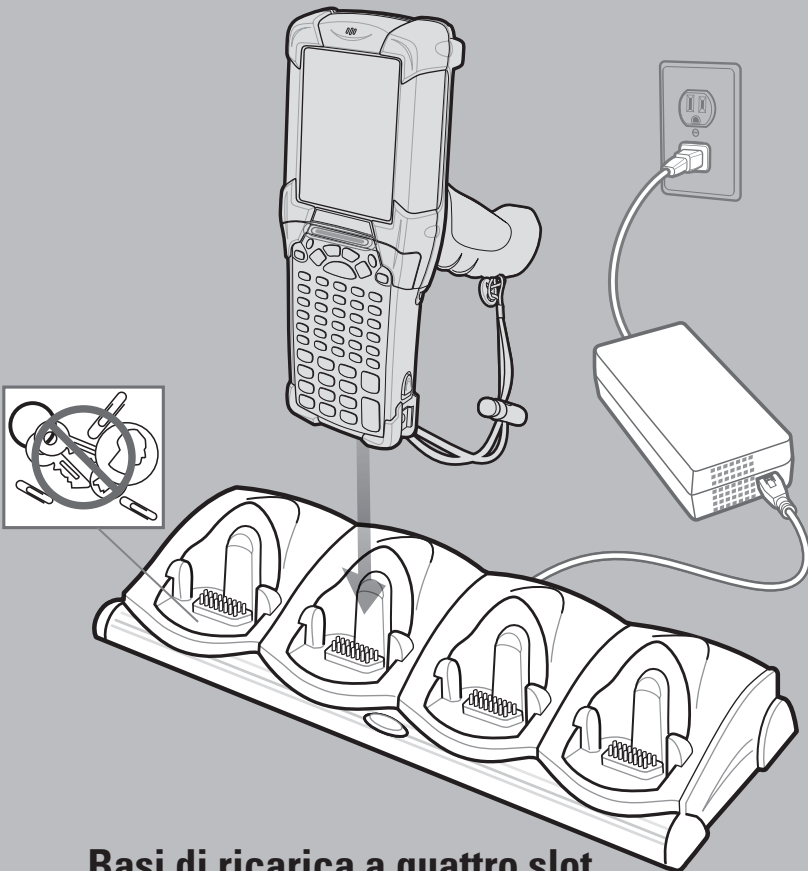
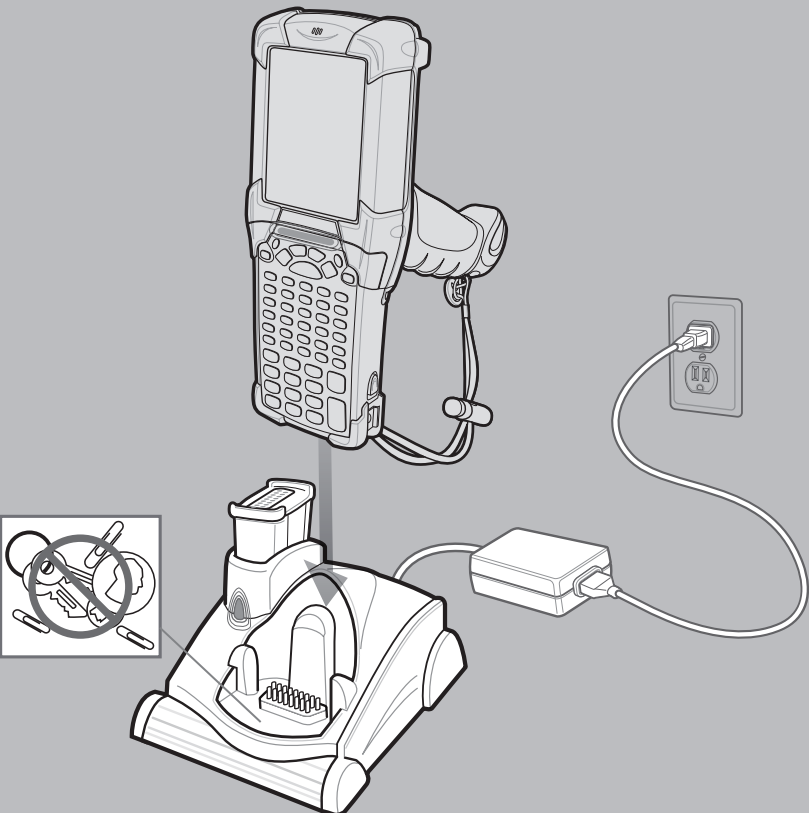
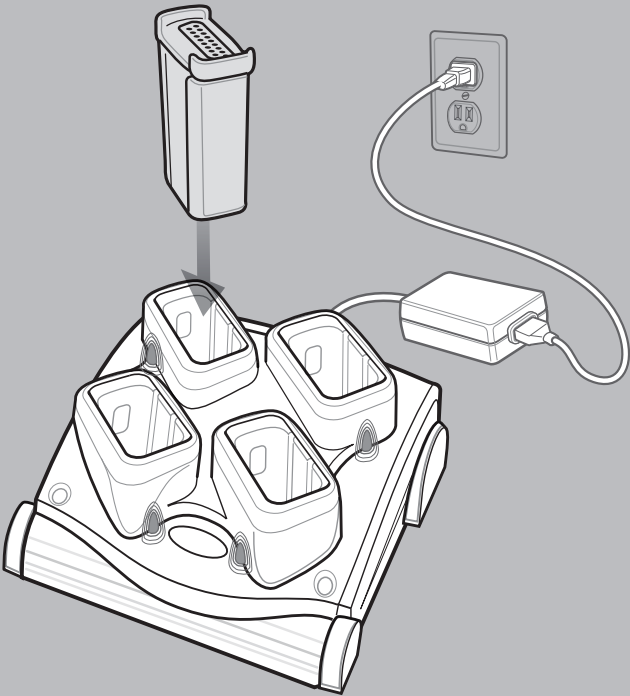

POSIZIONI OTTIMALI DI IMAGING E SCANSIONE

Scansione laser

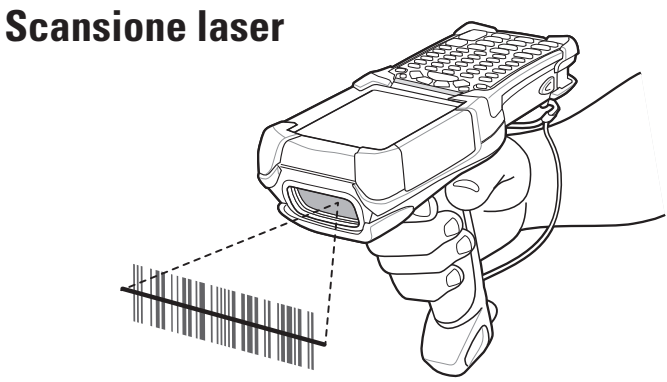

Imaging della portata standard

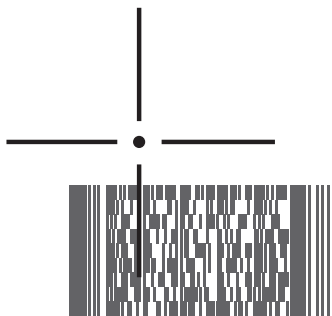
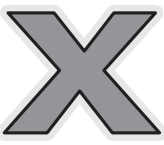
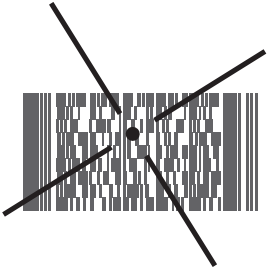
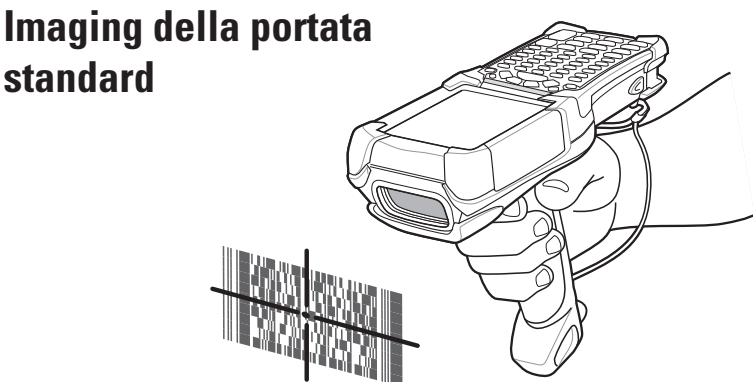

Imaging della portata estesa

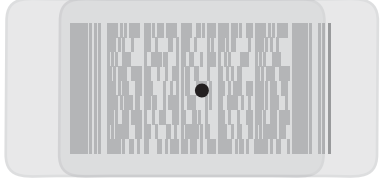
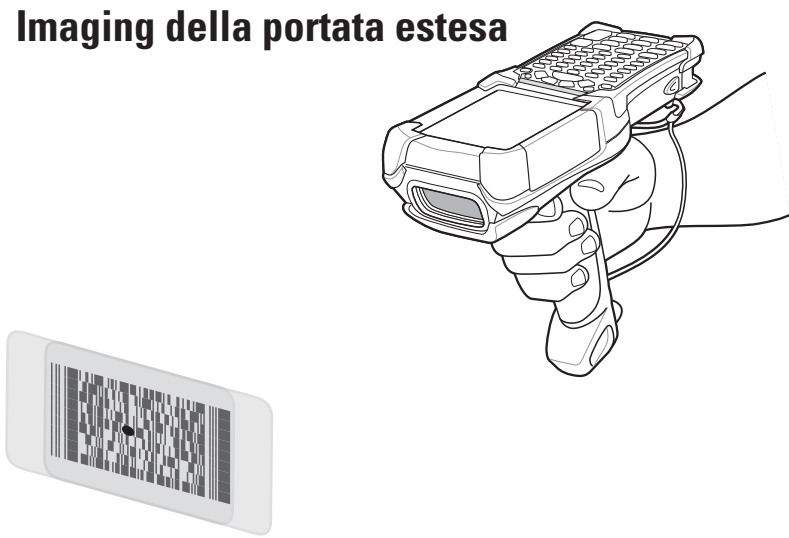

POSIZIONE OTTIMALE ERETTA DEL CORPO



EVITARE DI CREARE ANGOLI ESTREMI CON IL POLSO

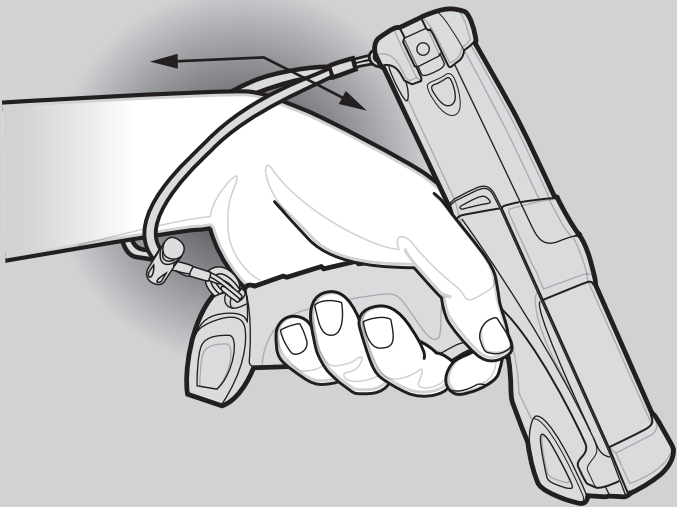

EVITARE DI CREARE ANGOLI ESTREMI CON IL POLSO

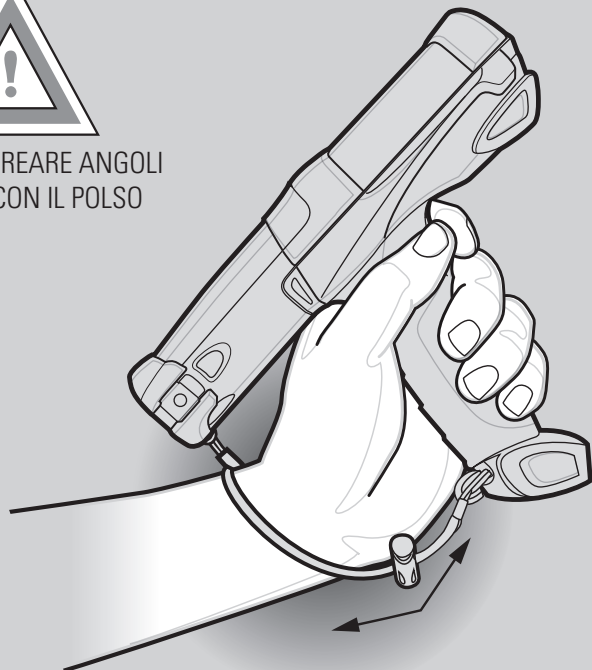

Scansione bassa

Alternare il ginocchio sinistro e quello destro



EVITARE DI PIEGARSI

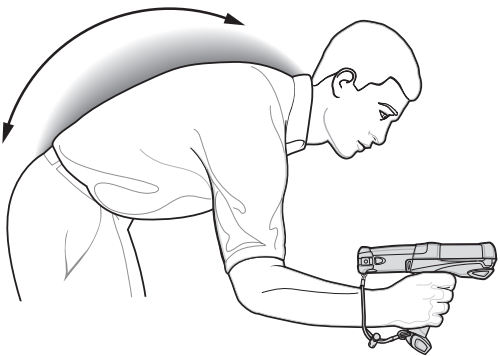

Alternare la mano sinistra e quella destra



EVITARE DI SPORGERSI



Scansione alta

Utilizzare una scala



Si raccomanda di effettuare delle pause e alternare le attività lavorative



Zebra Technologies Corporation
Lincolnshire, IL U.S.A.
Zebra e l'immagine della testa di zebra sono marchi registrati di ZIH Corp.
Il logo di Symbol è un marchio registrato di Symbol Technologies, Inc., una
società Zebra Technologies. © 2015 Symbol Technologies, Inc.



72-161751-02IT Rev. B - Aprile 2015



<http://www.zebra.com/mc92n0-g>

MC92N0-G

Guida all'utilizzo ottimale