

M a g n e t i c S t r i p e R e a d e r



symbol®



© 2003 SYMBOL TECHNOLOGIES, INC. All rights reserved.

Symbol reserves the right to make changes to any product to improve reliability, function, or design.

Symbol does not assume any product liability arising out of, or in connection with, the application or use of any product, circuit, or application described herein.

No license is granted, either expressly or by implication, estoppel, or otherwise under any patent right or patent, covering or relating to any combination, system, apparatus, machine, material, method, or process in which Symbol products might be used. An implied license exists only for equipment, circuits, and subsystems contained in Symbol products.

Symbol and the Symbol logo are registered trademarks of Symbol Technologies, Inc. Other product names mentioned in this manual may be trademarks or registered trademarks of their respective companies and are hereby acknowledged.

Symbol Technologies, Inc.

One Symbol Plaza

Holtsville, N.Y. 11742-1300

<http://www.symbol.com>

Patents

This product is covered by one or more of the following U.S. and foreign Patents:

U.S. Patent No. 4,593,186; 4,603,262; 4,607,156; 4,652,750; 4,673,805; 4,736,095;
 4,758,717; 4,760,248; 4,806,742; 4,816,660; 4,845,350; 4,896,026; 4,897,532; 4,923,281;
 4,933,538; 4,992,717; 5,015,833; 5,017,765; 5,021,641; 5,029,183; 5,047,617; 5,103,461;
 5,113,445; 5,130,520; 5,140,144; 5,142,550; 5,149,950; 5,157,687; 5,168,148; 5,168,149;
 5,180,904; 5,216,232; 5,229,591; 5,230,088; 5,235,167; 5,243,655; 5,247,162; 5,250,791;
 5,250,792; 5,260,553; 5,262,627; 5,262,628; 5,266,787; 5,278,398; 5,280,162; 5,280,163;
 5,280,164; 5,280,498; 5,304,786; 5,304,788; 5,306,900; 5,324,924; 5,337,361; 5,367,151;
 5,373,148; 5,378,882; 5,396,053; 5,396,055; 5,399,846; 5,408,081; 5,410,139; 5,410,140;
 5,412,198; 5,418,812; 5,420,411; 5,436,440; 5,444,231; 5,449,891; 5,449,893; 5,468,949;
 5,471,042; 5,478,998; 5,479,000; 5,479,002; 5,479,441; 5,504,322; 5,519,577; 5,528,621;
 5,532,469; 5,543,610; 5,545,889; 5,552,592; 5,557,093; 5,578,810; 5,581,070; 5,589,679;
 5,589,680; 5,608,202; 5,612,531; 5,619,028; 5,627,359; 5,637,852; 5,664,229; 5,668,803;
 5,675,139; 5,693,929; 5,698,835; 5,705,800; 5,714,746; 5,723,851; 5,734,152; 5,734,153;
 5,742,043; 5,745,794; 5,754,587; 5,762,516; 5,763,863; 5,767,500; 5,789,728; 5,789,731;
 5,808,287; 5,811,785; 5,811,787; 5,815,811; 5,821,519; 5,821,520; 5,823,812; 5,828,050;
 5,848,064; 5,850,078; 5,861,615; 5,874,720; 5,875,415; 5,900,617; 5,902,989; 5,907,146;
 5,912,450; 5,914,478; 5,917,173; 5,920,059; 5,923,025; 5,929,420; 5,945,658; 5,945,659;
 5,946,194; 5,959,285; 6,002,918; 6,021,947; 6,029,894; 6,031,830; 6,036,098; 6,047,892;
 6,050,491; 6,053,413; 6,056,200; 6,065,678; 6,067,297; 6,082,621; 6,084,528; 6,088,482;
 6,092,725; 6,101,483; 6,102,293; 6,104,620; 6,114,712; 6,115,678; 6,119,944; 6,123,265;
 6,131,814; 6,138,180; 6,142,379; 6,172,478; 6,176,428; 6,178,426; 6,186,400; 6,188,681;
 6,209,788; 6,209,789; 6,216,951; 6,220,514; 6,243,447; 6,244,513; 6,247,647; 6,308,061;
 6,250,551; 6,295,031; 6,308,061; 6,308,892; 6,321,990; 6,328,213; 6,330,244; 6,336,587;
 6,340,114; 6,340,115; 6,340,119; 6,348,773; 6,380,949; 6,394,355; D305,885; D341,584;
 D344,501; D359,483; D362,453; D363,700; D363,918; D370,478; D383,124; D391,250;
 D405,077; D406,581; D414,171; D414,172; D418,500; D419,548; D423,468; D424,035;
 D430,158; D430,159; D431,562; D436,104.

Invention No. 55,358; 62,539; 69,060; 69,187, NI-068564 (Taiwan); No. 1,601,796; 1,907,875;
 1,955,269 (Japan); European Patent 367,299; 414,281; 367,300; 367,298; UK 2,072,832; France
 81/03938; Italy 1,138,713

rev. 06/02

Introduction

This guide describes how to set up and use an MSR 8000 Magnetic Stripe Reader with Symbol PDT 8000 Series terminals. The magnetic stripe reader:

- provides power for operating the terminal
- allows you to use the terminal to capture data from magnetic stripe cards
- provides serial connection through the serial pass-through port
- re-charges the terminal's battery, when used with the appropriate power supply.

The magnetic stripe reader snaps easily on to the bottom of the terminal and can be removed easily when not in use.

About This Guide

This guide provides basic information on the following topics:

- [*Requirements on page 2*](#)
- [*Parts on page 3*](#)
- [*Attaching and Removing the MSR 8000 on page 4*](#)
- [*Reading Magnetic Stripes on page 4*](#)
- [*Power Connection on page 6*](#)
- [*Serial Connection on page 6*](#)
- [*Terminal Battery Charging on page 7*](#)
- [*LED Indicators on page 7*](#)
- [*Regulatory Information on page 8*](#)
- [*Service Information on the back cover.*](#)

For detailed information on any PDT 8000 Series terminal, refer to the *PDT 8000 Series Quick Reference Guide*, p/n 72-58168-xx, *PDT80XX WAN Quick Reference Guide*, p/n 72-61492-xx or *PDT*



8000 Series Product Reference Guide, p/n 72-58169-xx, available at www.symbol.com/manuals.

Requirements

- for power connection:

U.S Customers	CBL-8000-200U
International Customers	Power Supply, p/n 50-14001-012 DC Cable, p/n 50-16002-028 AC Cord, appropriate for your country

- for data capture:
 - MSR8000 software, available at <http://devzone.symbol.com>.
- for serial connection:
 - a serial device cable
 - Microsoft ActiveSync
 - setup of host computer and terminal (refer to the *PDT 8000 Series Product Reference Guide* for detailed instructions).

Q u i c k R e f e r e n c e

Parts

FRONT

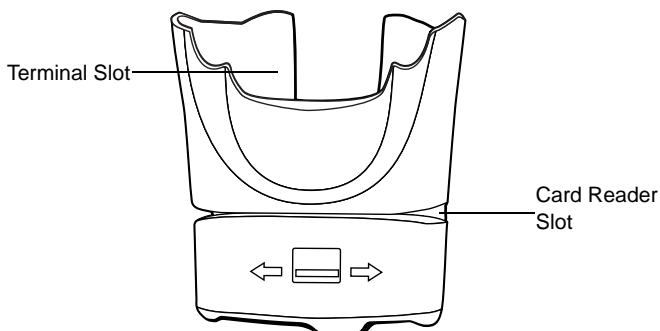

Bottom

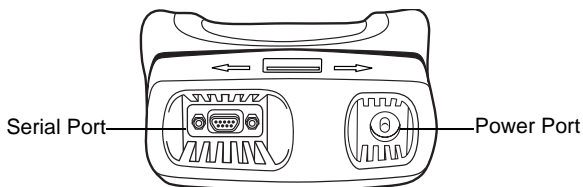

There are two connection ports on the bottom of the unit:

Ports	Function
Serial	Micro DB-9 connector used for direct connection using a serial device cable. Use this port to connect to a serial device, such as a printer or host computer.
Power	Used for power supply connection.

Attaching and Removing the MSR 8000

To attach, snap the magnetic stripe reader onto the bottom of the terminal as shown below.

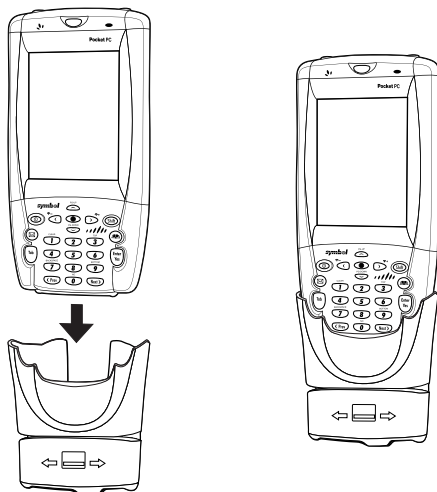

To remove, pull and remove the terminal from the magnetic stripe reader.

Note: Remove the magnetic stripe reader from the bottom of the terminal, before using a cradle for charging and communication.

Reading Magnetic Stripes

To use the magnetic stripe reader, the terminal must have an application installed which accepts magnetic stripe data. A sample application is available for reference at <http://devzone.symbol.com>.

Q u i c k R e f e r e n c e

To use the magnetic stripe reader:

Note: The MSR 8000 does not need to be attached to the power supply to read magnetic stripes.

1. Ensure that a magnetic stripe reader application is loaded on the terminal. A sample application is available at <http://devzone.symbol.com>
2. Attach the magnetic stripe reader to the terminal.
3. Power on the terminal.
4. Tap the icon associated with the magnetic stripe reader application on your terminal, or navigate to the magnetic stripe reader application under the Start menu on the terminal.
5. Swipe the magnetic stripe card through the reader, ensuring the magnetic stripe on the card is positioned as shown below.

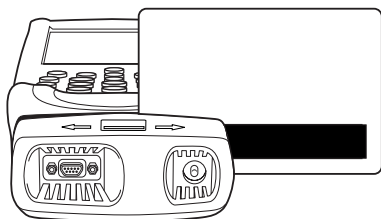

Note: The card may be swiped in either direction, from left to right, or from right to left, with the magnetic stripe facing away from the terminal. For best results, gently press down on the card while swiping to ensure contact with the bottom of the reader.

Power Connection

To connect the MSR 8000 to a power source:

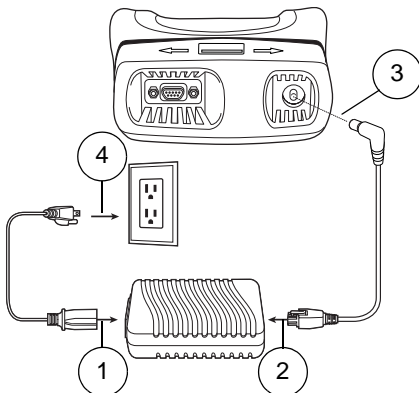

Serial Connection

To connect the MSR 8000 to a serial device:

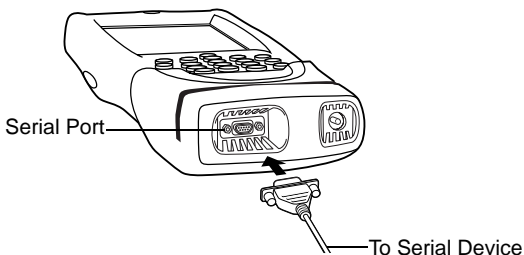

Note: The MSR8000 can connect to and communicate with a serial device, such as a printer or host computer, through this port. For communication setup, refer to the *PDT 8000 Series Product Reference Guide*.

Terminal Battery Charging

1. Ensure the magnetic stripe reader is connected to a power source.
See [Power Connection on page 6](#).
2. Attach the MSR 8000 to the terminal. The terminal starts to charge automatically.

The terminal's charging LED blinks amber to indicate that the battery is charging and turns solid amber when battery is completely charged. The battery charges in less than four hours, if the terminal is not in use. See [LED Indicators on page 7](#) for other indications.

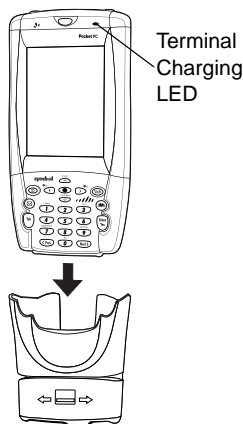

LED Indicators

Terminal Charging LED	Indication
Off	Terminal not attached to MSR 8000; terminal not placed correctly; MSR 8000 is not powered.
Fast Blinking Amber	Error in charging; check placement of terminal.
Slow Blinking Amber	Terminal is charging.
Solid Amber	Charging complete.



Regulatory Information

Power Supply

Note: Use only a Symbol-approved power supply (p/n 50-14001-012) output rated 9 Vdc and minimum 2A. The power supply is certified to EN60950 with SELV outputs.

Hinweis: Benutzen Sie nur eine Symbol Technologies genehmigt Stromversorgung (p/n 50-14001-012) in den Ausgabe: 9 Vdc und minimum 2A. Die Stromversorgung ist bescheinigt nach EN60950 mit SELV Ausgaben.

Radio Frequency Interference Requirements

This device has been tested and found to comply with the limits for a Class B digital device pursuant to Part 15 of the Federal Communications Commissions Rules and Regulation. These limits are designed to provide reasonable protection against harmful interference when the equipment is operated in a residential installation. This equipment generates, uses, and can radiate radio frequency energy and, if not installed and used in accordance with the instructions, may cause harmful interference to radio communications. Operation of this equipment in a residential area is likely to cause harmful interference in which case the user will be required to correct the interference at his own expense.

- Re-orient or relocate the receiving antenna.
- Increase the separation between the equipment and receiver.
- Connect the equipment into an outlet on a circuit different from that which the receiver is connected.
- Consult the dealer or an experienced radio/TV technician for help.

Radio Frequency Interference Requirements - FCC

This device complies with Part 15 of the FCC Rules. Operation is subject to the following two conditions: (1) this device may not cause harmful interference, and (2) this device must accept any interference received, including interference that may cause undesired operation.

Radio Frequency Interference Requirements - Canada

This Class B digital apparatus complies with Industry Canada Standard ICES-003. Cet appareil numérique de la classe B est conforme à la norme NMB-003 d'Industrie Canada.

Marking and European Economic Area (EEA)



Statement of Compliance

Symbol Technologies, Inc., hereby declares that this device is in compliance with all the applicable Directives, 89/336/EEC, 73/23/EEC. A Declaration of Conformity may be obtained from <http://www2.symbol.com/doc/>

Q u i c k R e f e r e n c e

Warranty

(A) Warranty Symbol Technologies (hereafter "Seller") hardware Products are warranted against defects in workmanship and materials for a period of three (3) months from the date of shipment, unless otherwise provided by Seller in writing, provided the Product remains unmodified and is operated under normal and proper conditions. Warranty provisions and durations on software, integrated installed systems, Product modified or designed to meet specific customer specifications ("Custom Products"), remanufactured products, and reconditioned or upgraded products, shall be as provided in the applicable Product specification in effect at the time of purchase or in the accompanying software license.

(B) Spare Parts Spare parts (i.e. parts, components, or subassemblies sold by Seller for use in the service and maintenance of Products) are warranted against defects in workmanship and materials for a period of thirty (30) days from the date of shipment. Spare parts may be new or originate from returned units under the conditions set forth in subsection D below.

(C) Repair of Symbol-branded hardware For repairs on Symbol-branded hardware Products under this Agreement, including repairs covered by warranty, the repair services provided are warranted against defects in workmanship and materials on the repaired component of the Product for a period of thirty (30) days from the shipment date of the repaired Product, or until the end of the original warranty period, whichever is longer.

(D) Product Service Products may be serviced or manufactured with parts, components, or subassemblies that originate from returned products and that have been tested as meeting applicable specifications for equivalent new material and Products. The sole obligation of Seller for defective hardware Products is limited to repair or replacement (at Seller's option) on a "return to service depot" basis with prior Seller authorization. Customer is responsible for shipment to the Seller and assumes all costs and risks associated with this transportation; return shipment to the Customer will be at Seller's expense. Customer shall be responsible for return shipment charges for product returned where Seller determines there is no defect ("No Defect Found"), or for product returned that Seller determines is not eligible for warranty repair. No charge will be made to Buyer for replacement parts for warranty repairs. Seller is not responsible for any damage to or loss of any software programs, data or removable data storage media, or the restoration or reinstallation of any software programs or data other than the software, if any, installed by Seller during manufacture of the Product.

(E) Original Warranty Period Except for the warranty applying solely to the repaired component arising from a repair service as provided in Section C above, the aforementioned provisions do not extend the original warranty period of any Product that had either been repaired or replaced by Seller.

(F) Warranty Provisions The above warranty provisions shall not apply to any Product (i) which has been repaired, tampered with, altered or modified, except by Seller's authorized service personnel; (ii) in which the defects or damage to the Product result from normal wear and tear, misuse, negligence, improper storage, water or other liquids, battery leakage, use of parts or accessories not approved or supplied by Symbol, or failure to perform operator handling and scheduled maintenance instructions supplied by Seller; (iii) which has been subjected to unusual physical or electrical stress, abuse, or accident, or forces or exposure beyond normal use within the specified operational and environmental parameters set forth in the applicable Product specification; nor shall the above warranty provisions apply to any expendable or consumable items, such as batteries, supplied with the Product.

EXCEPT FOR THE WARRANTY OF TITLE AND THE EXPRESS WARRANTIES STATED ABOVE, SELLER DISCLAIMS ALL WARRANTIES ON PRODUCTS FURNISHED HEREUNDER INCLUDING ALL IMPLIED WARRANTIES OF MERCHANTABILITY AND FITNESS FOR A PARTICULAR USE. ANY IMPLIED WARRANTIES THAT MAY BE IMPOSED BY LAW ARE LIMITED IN DURATION TO THE LIMITED WARRANTY PERIOD. SOME STATES OR COUNTRIES DO NOT ALLOW A LIMITATION ON HOW LONG AN IMPLIED WARRANTY LASTS OR THE EXCLUSION OR LIMITATION OF INCIDENTAL OR CONSEQUENTIAL DAMAGES FOR CONSUMER PRODUCTS. IN SUCH STATES OR COUNTRIES, FOR SUCH PRODUCTS, SOME EXCLUSIONS OR LIMITATIONS OF THIS LIMITED WARRANTY MAY NOT APPLY.

The stated express warranties are in lieu of all obligations or liabilities on the part of Seller for damages, including but not limited to, special, indirect or consequential damages arising out of or in connection with the use or performance of the Product or service. Seller's liability for damages to Buyer or others resulting from the use of any Product or service furnished hereunder shall in no way exceed the purchase price of said Product or the fair market value of said service, except in instances of injury to persons or property.

Service Information

Before you use the unit, it must be configured to operate in your facility's network and run your applications.

If you have a problem running your unit or using your equipment, contact your facility's Technical or Systems Support. If there is a problem with the equipment, they will contact the Symbol Support Center:

United States	1-800-653-5350 1-631-738-2400	Canada	905-629-7226
United Kingdom	0800 328 2424	Asia/Pacific	+65-6796-9600
Australia	1-800-672-906	Austria/Österreich	1-505-5794-0
Denmark/Danmark	7020-1718	Finland/Suomi	9 5407 580
France	01-40-96-52-21	Germany/Deutschland	6074-49020
Italy/Italia	2-484441	Mexico/México	5-520-1835
Netherlands/Nederland	315-271700	Norway/Norge	+47 2232 4375
South Africa	11-8095311	Spain/España	91 324 40 00 Inside Spain
Sweden/Sverige	84452900		+34 91 324 40 00 Outside Spain
Latin America Sales Support	1-800-347-0178 Inside US +1-954-255-2610 Outside US		
Europe/Mid-East Distributor Operations	Contact local distributor or call +44 118 945 7360		

For the latest version of this guide go to: <http://www.symbol.com/manuals>.



72-61513-01
Revision B — September 2003