

# WT41N0

## 快速入门指南

<http://www.zebra.com/wt41n0>  
有关详细信息，请参阅用户指南

### 特点

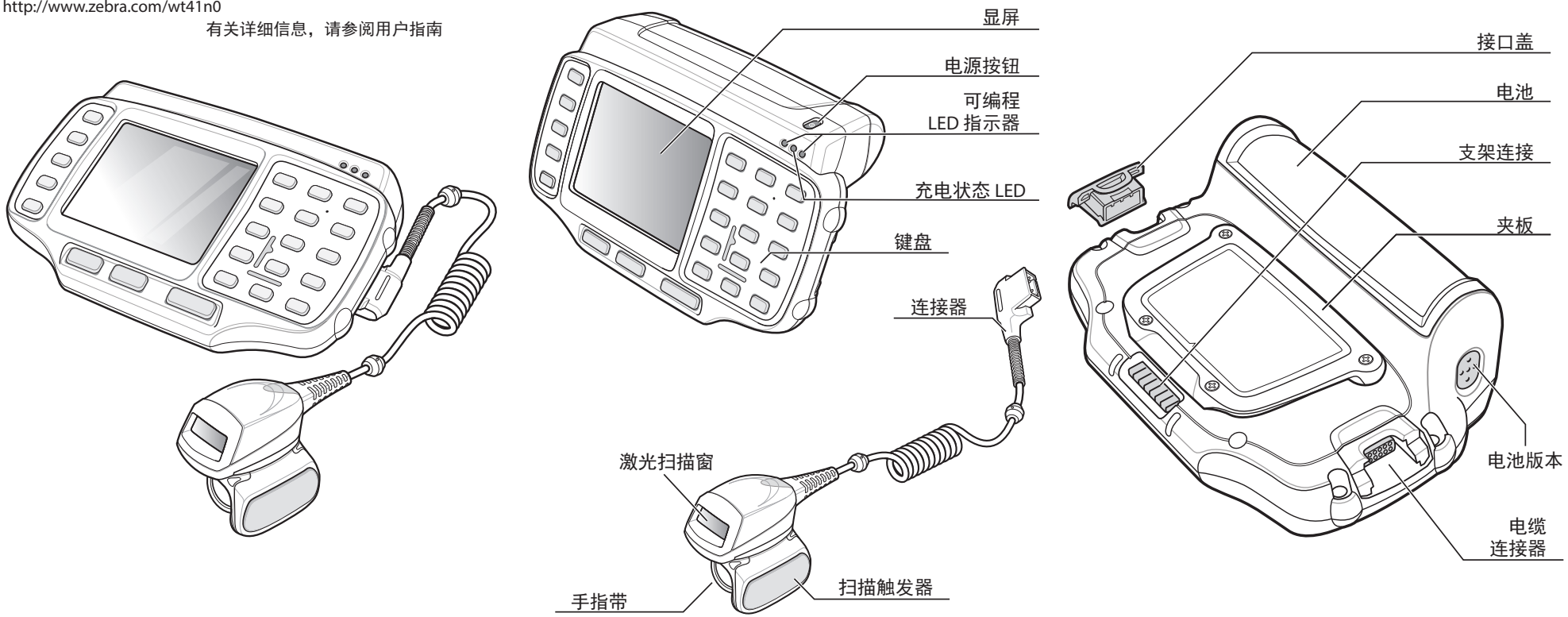

### 电池的安装和取出

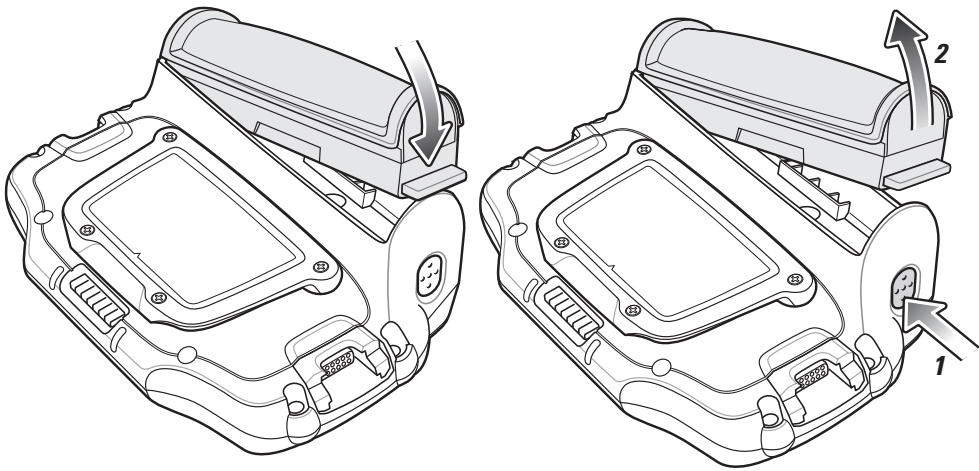

### 腕部佩戴用部件

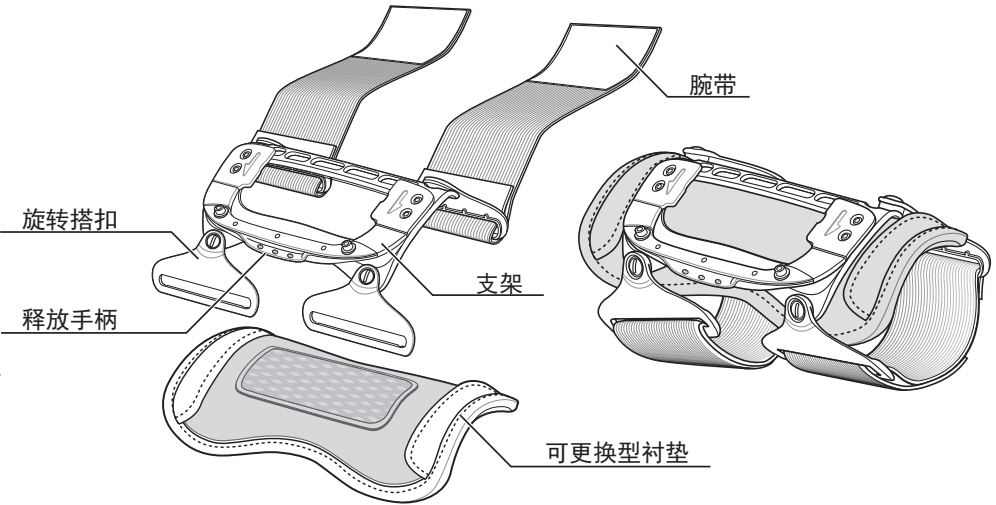

### 附件安装

#### 耳机适配器

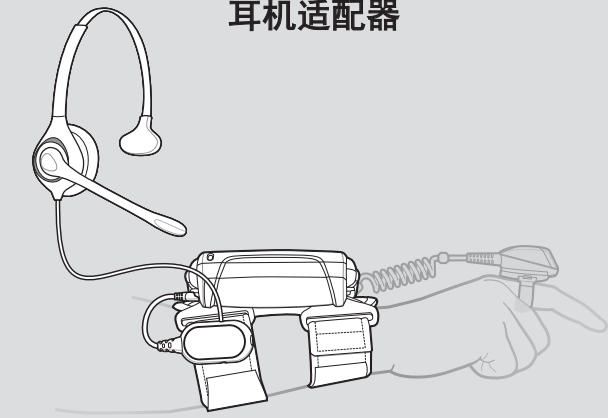

#### 将附件连接到终端

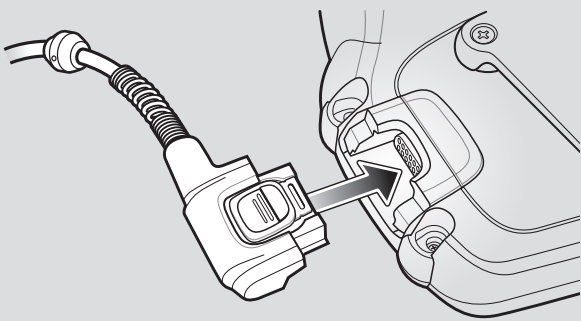

#### 断开终端与附件的连接

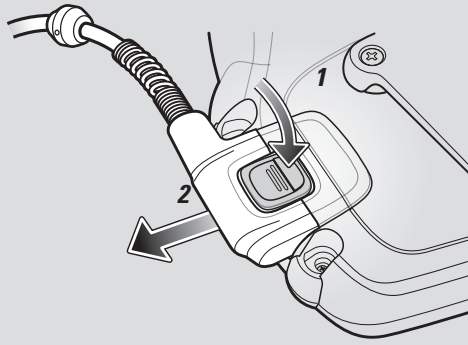

### 充电说明

◎ = LED 指示灯位置    慢闪 = 正常充电    稳定琥珀色 = 已充满    快闪 = 充电错误

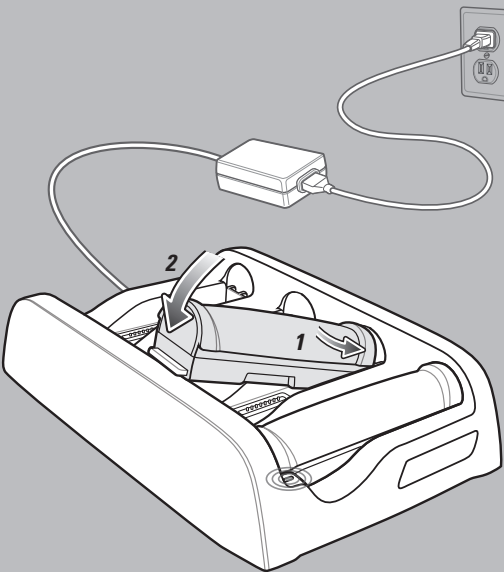

4 插槽式备用电池充电器

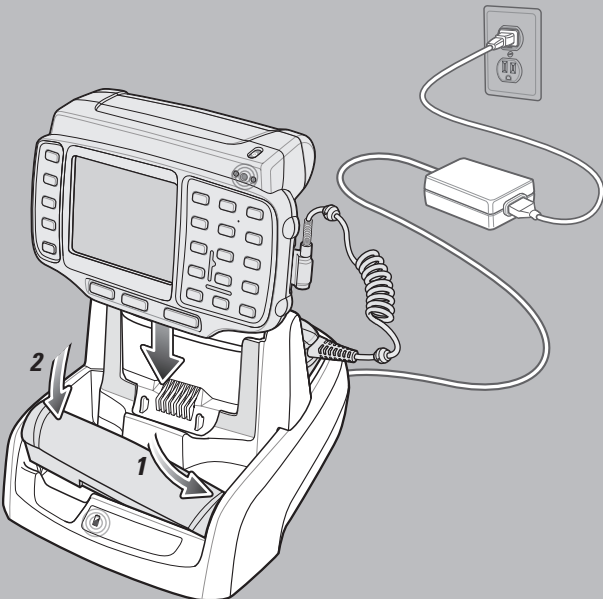

单一插槽式 USB 支架

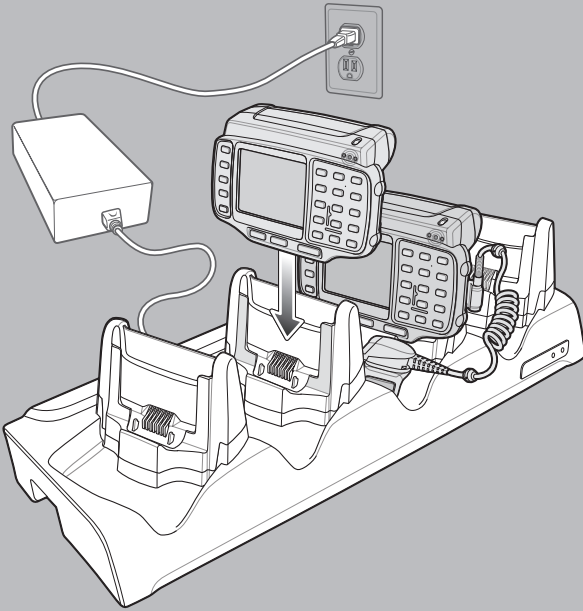

4 插槽式以太网支架

腕部佩戴/佩戴式终端安装

腕部佩戴安装

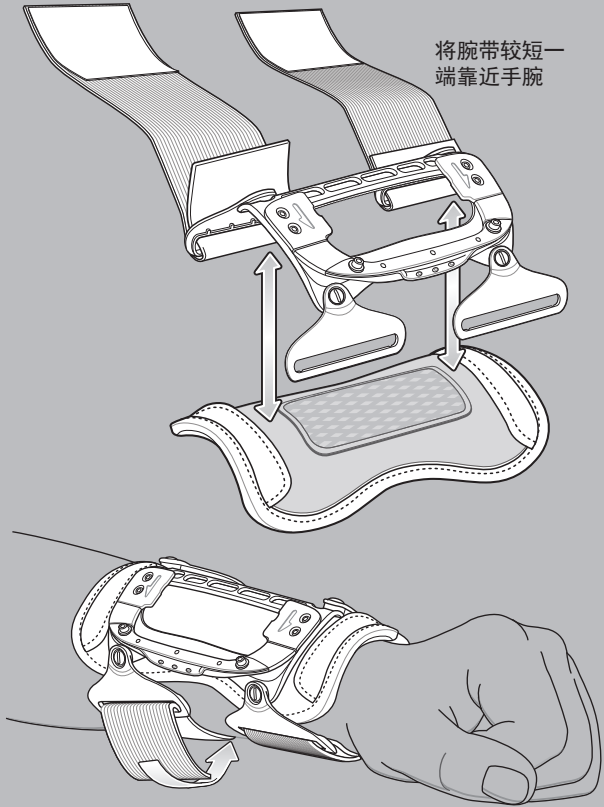

终端安装



佩戴在左或右手腕

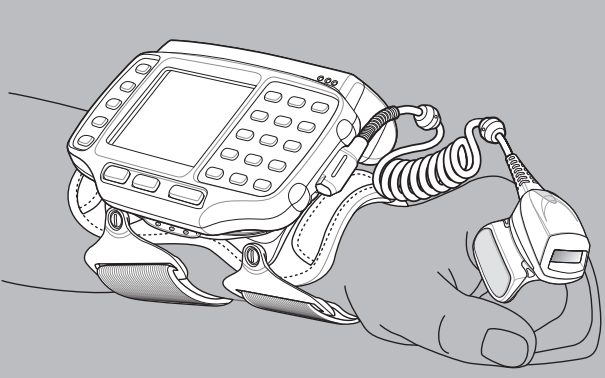

取出终端

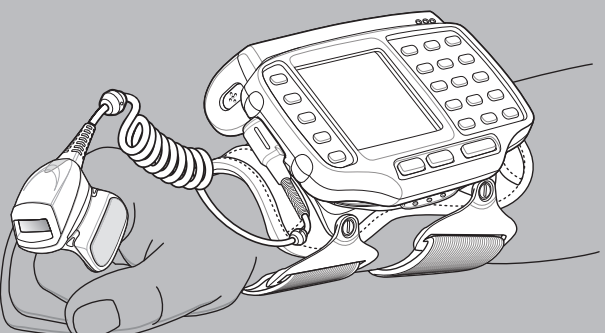
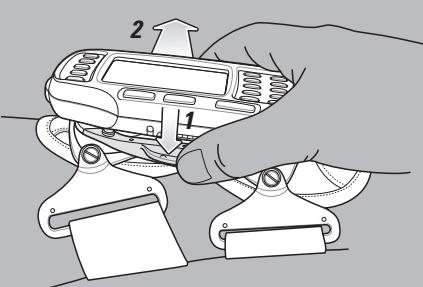

扫描仪手指佩戴

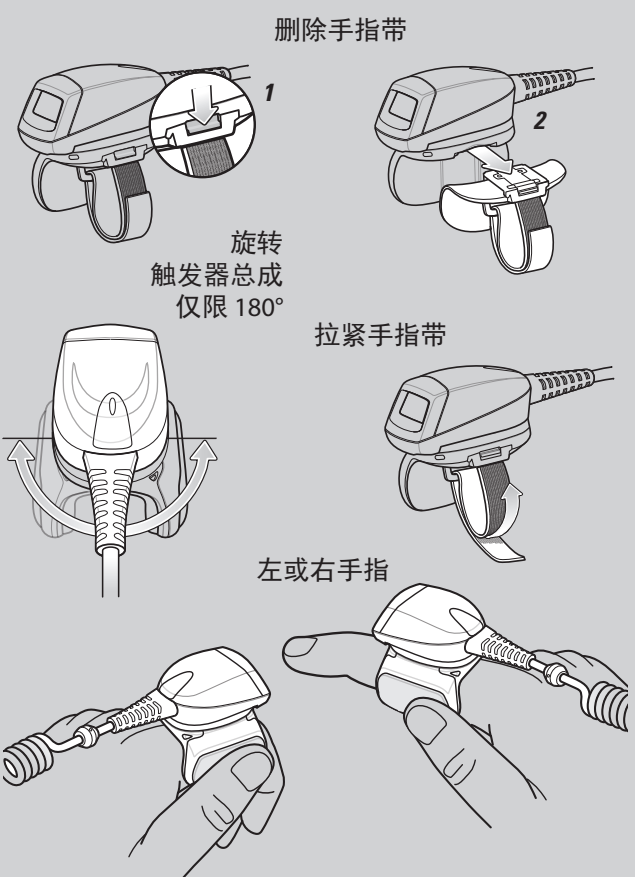

避免手腕弯曲过度

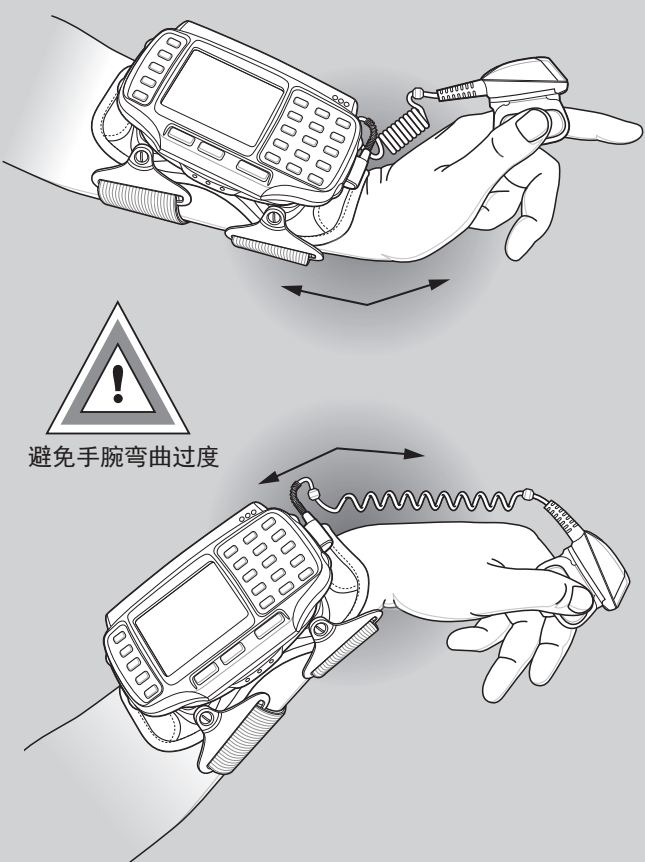

避免弯腰和高抬臂腕

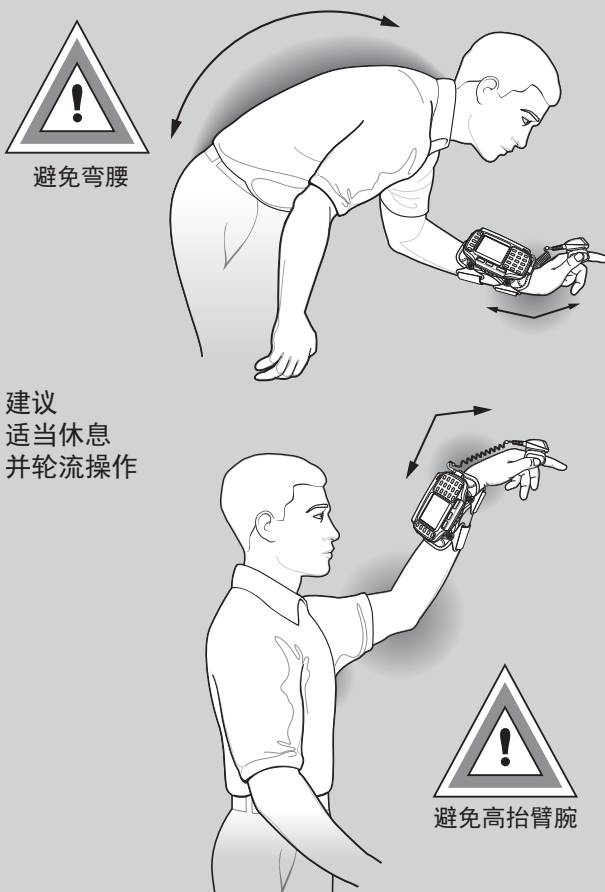

最佳身体姿势

低位扫描



直立扫描

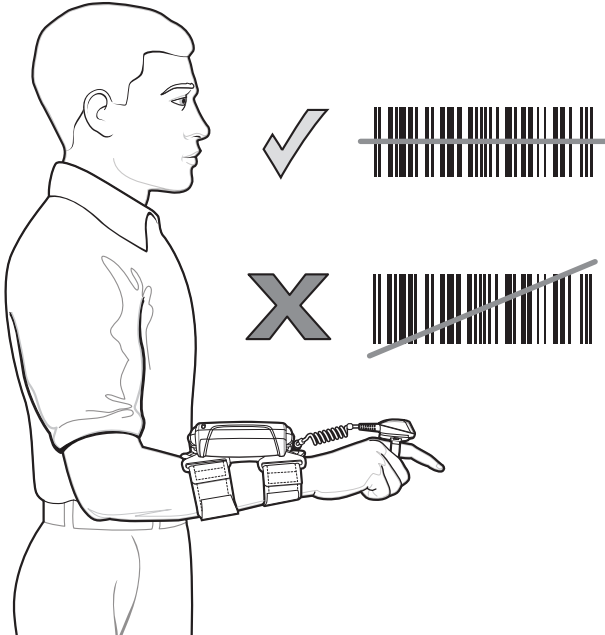

高位扫描

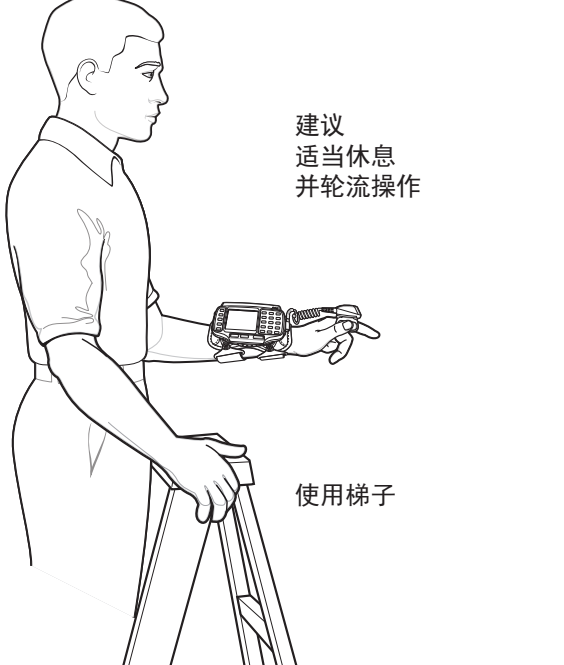

张贴在工作区域



Zebra Technologies Corporation  
Lincolnshire, IL U.S.A.  
Zebra 和 Zebra 头像是 ZIH 公司的注册商标。  
Symbol 徽标是 Symbol Technologies, Inc. 的注册商标，该公司是  
Zebra Technologies 的下属公司。  
©2015 Symbol Technologies, Inc.

72-157178-025C 版本 B - 2015 年 03 月

<http://www.zebra.com/wt41n0>

WT41N0