



Zebra[®]

P330*i* & P330*m*



**Card
Printer
Solutions**

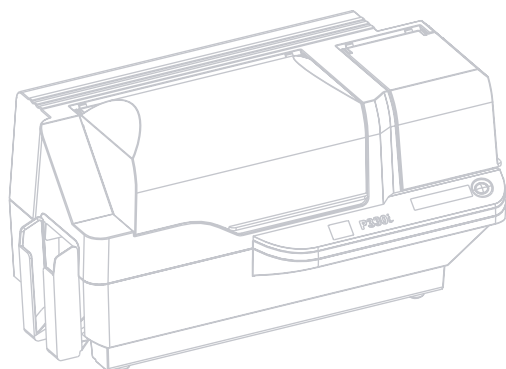

1

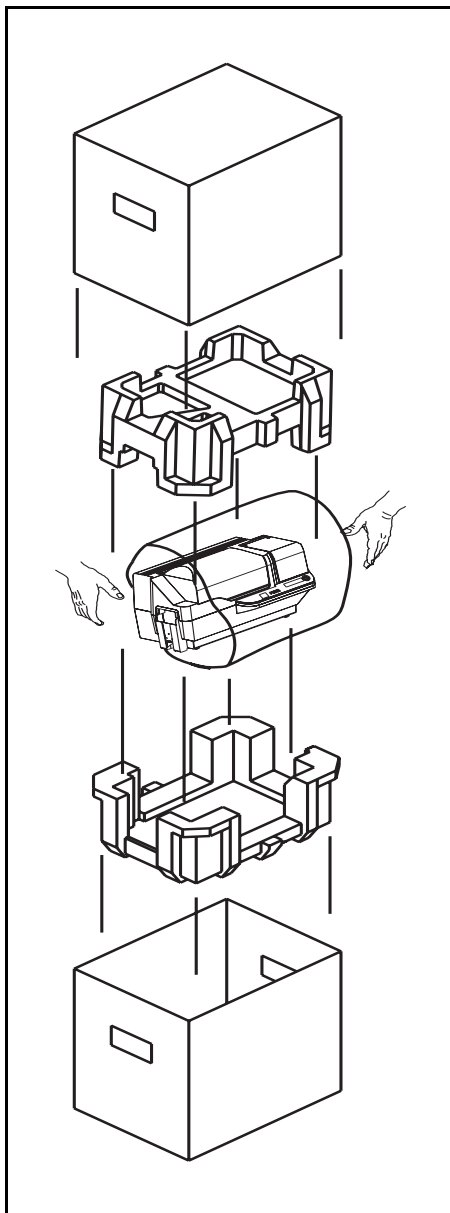
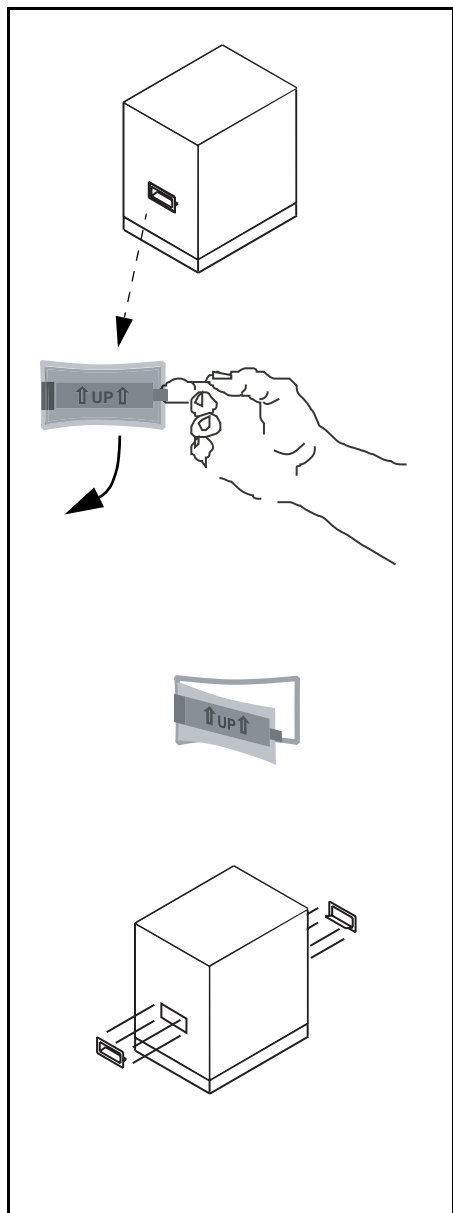
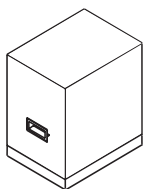

2

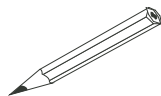
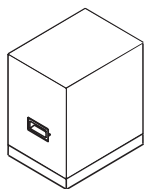

x 7:

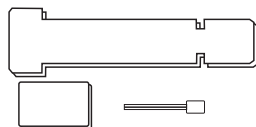
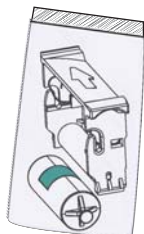
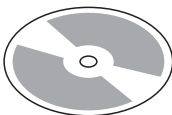
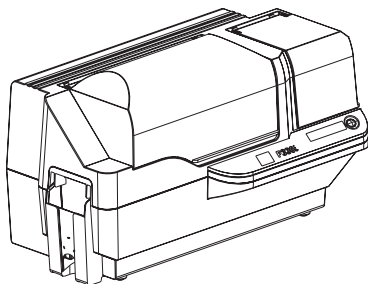

USB

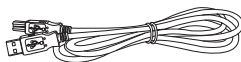

3

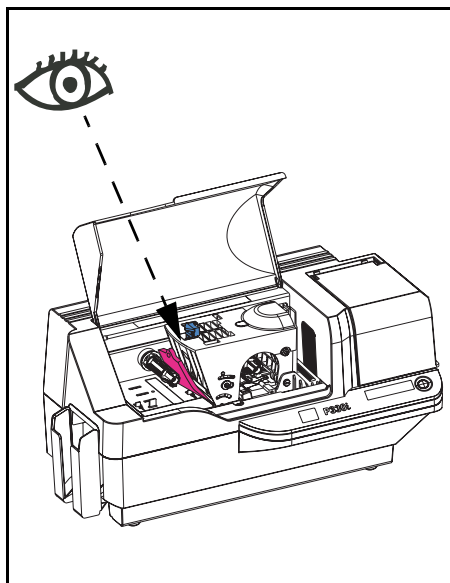
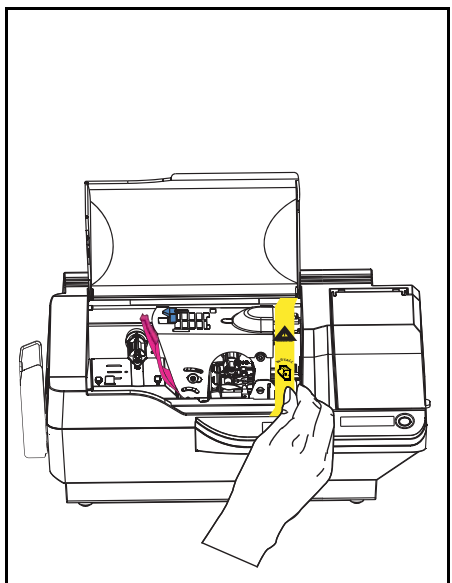
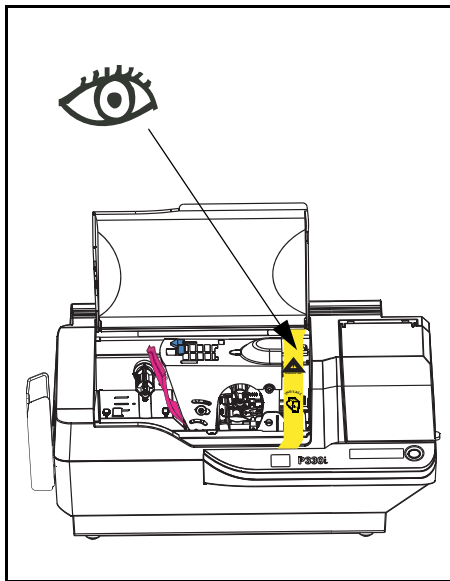
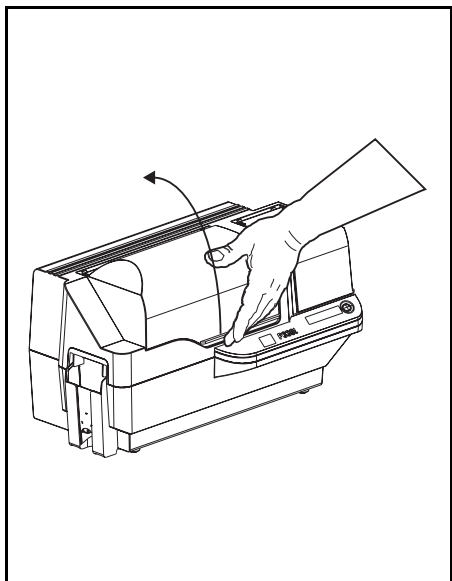
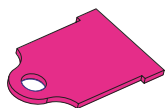

4

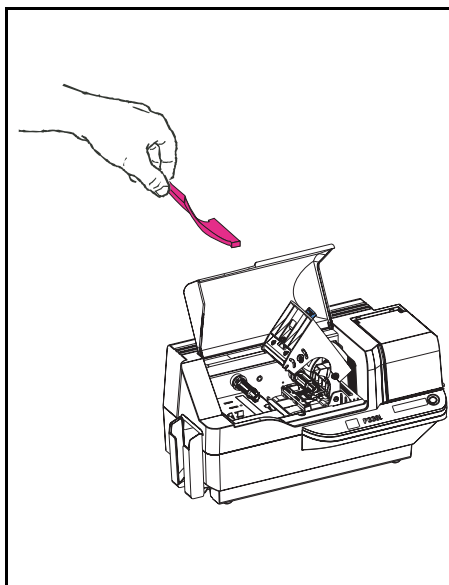
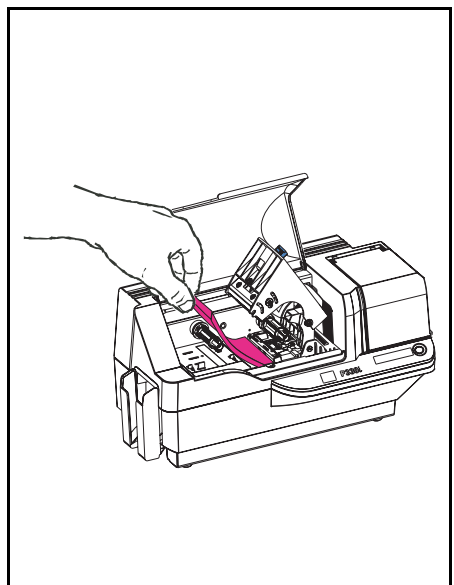
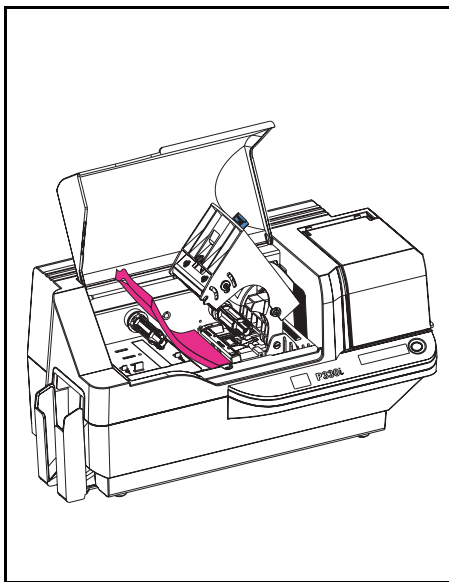
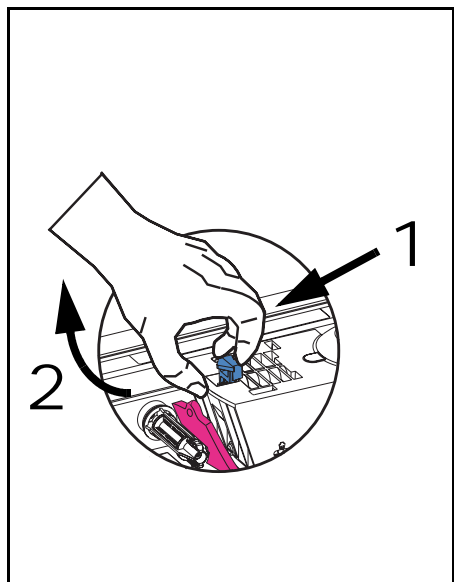
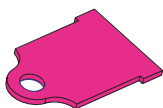

5

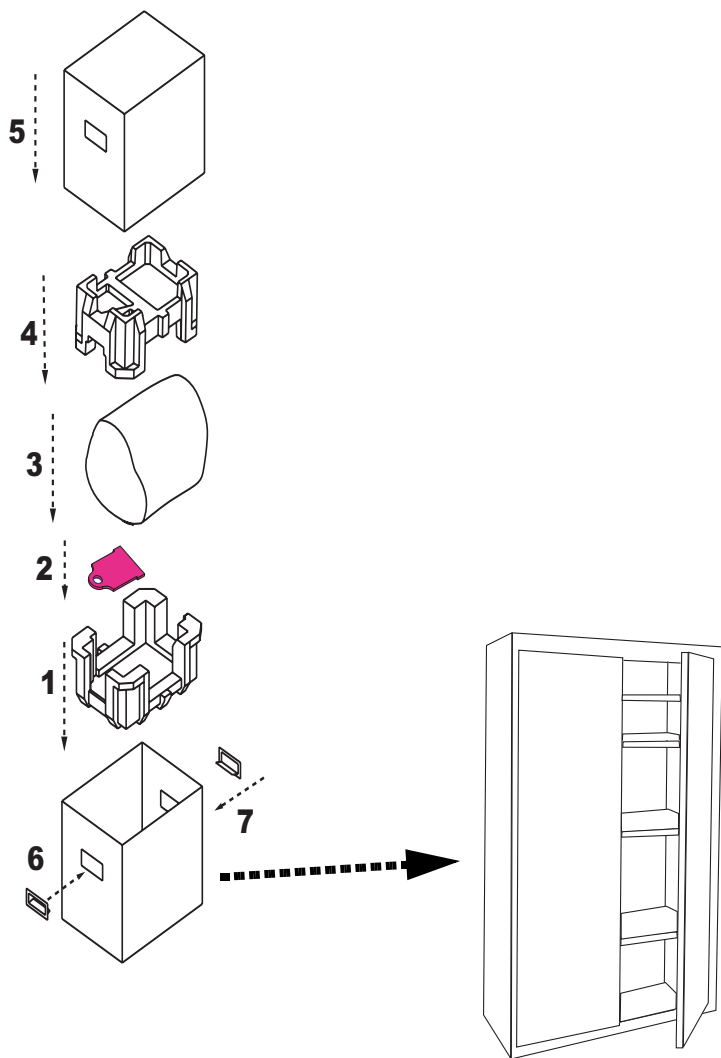

6

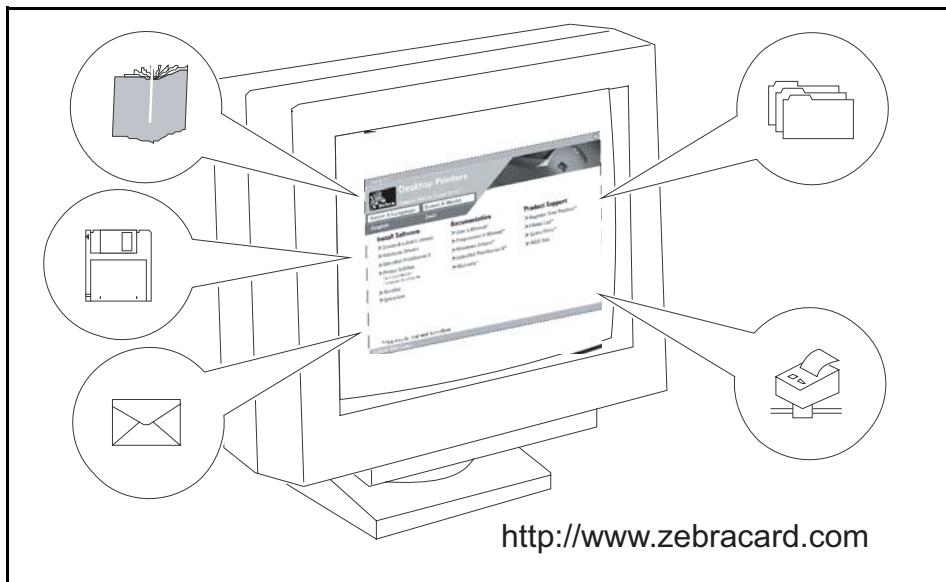
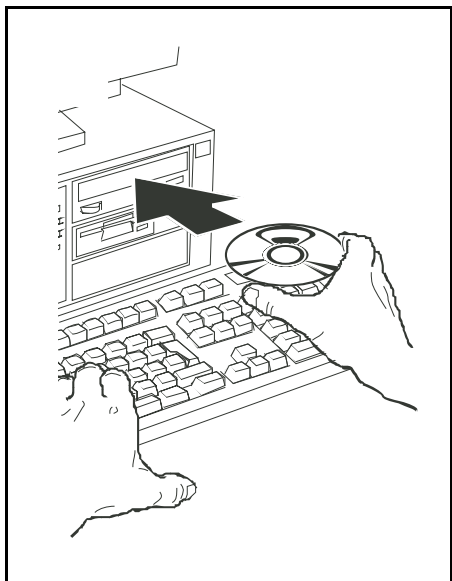
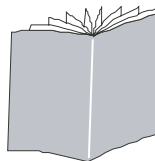

7

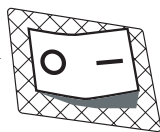
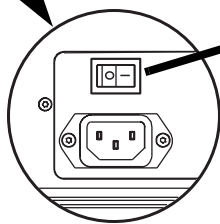
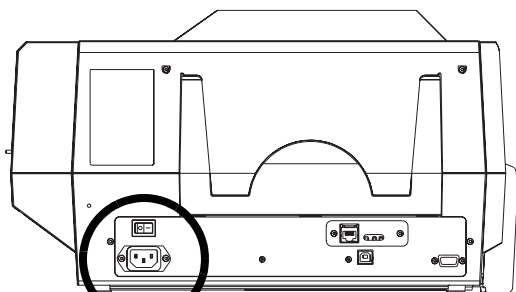
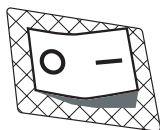

8

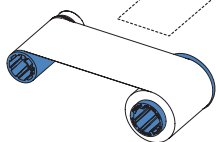
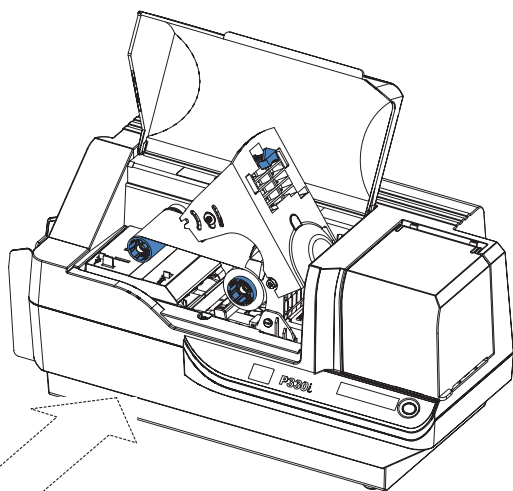
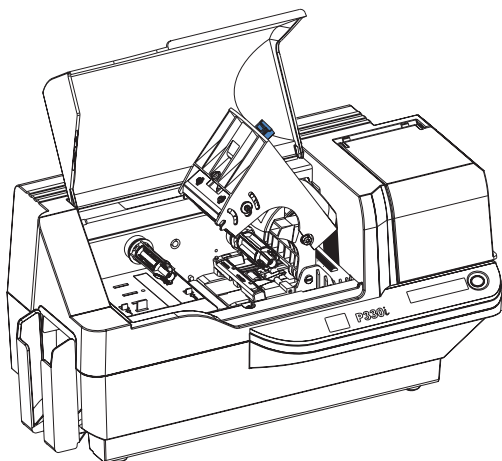
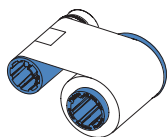

9

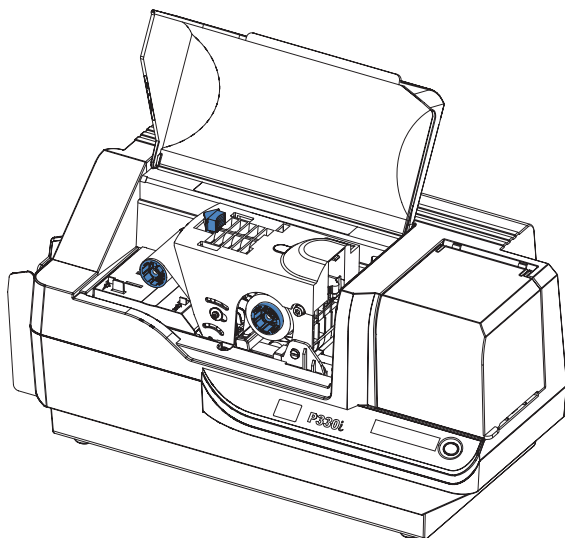
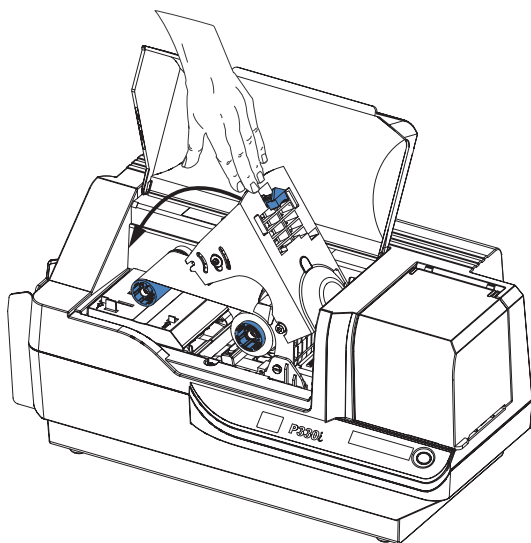
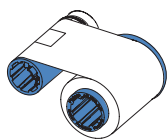

10

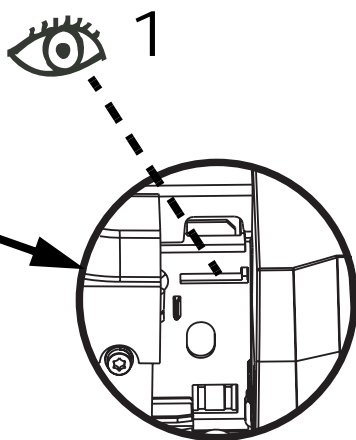
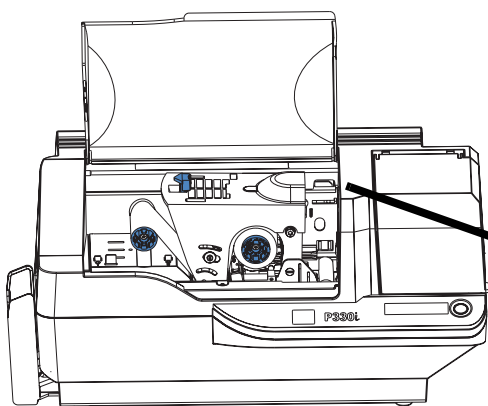
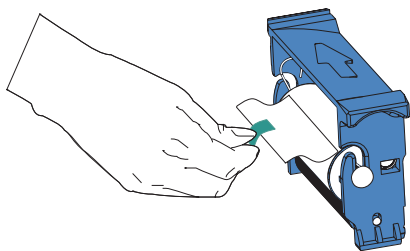
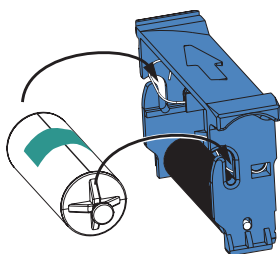
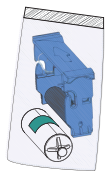

11

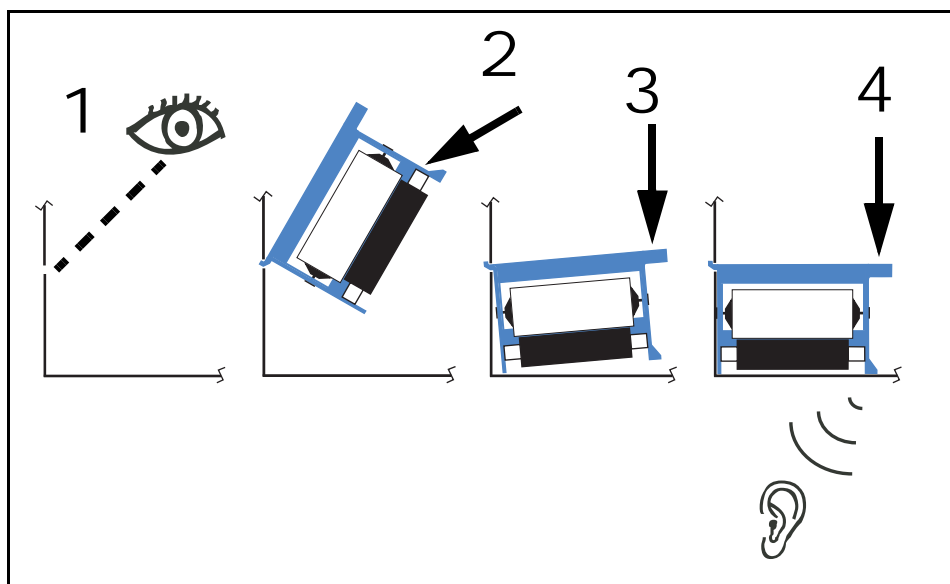
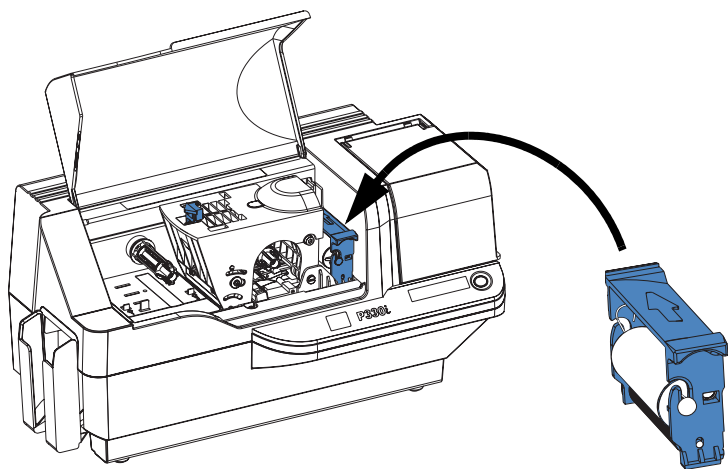
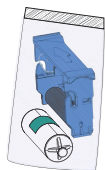

12

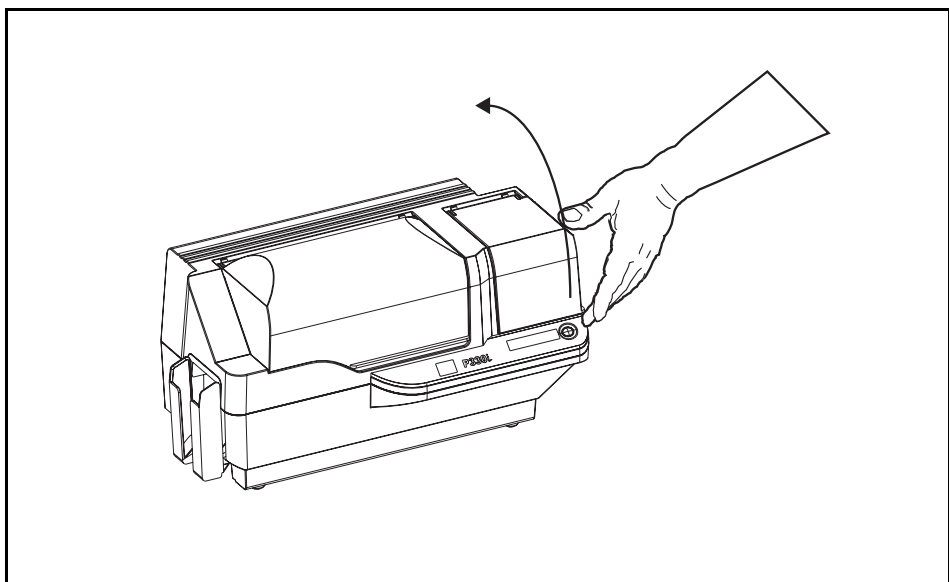
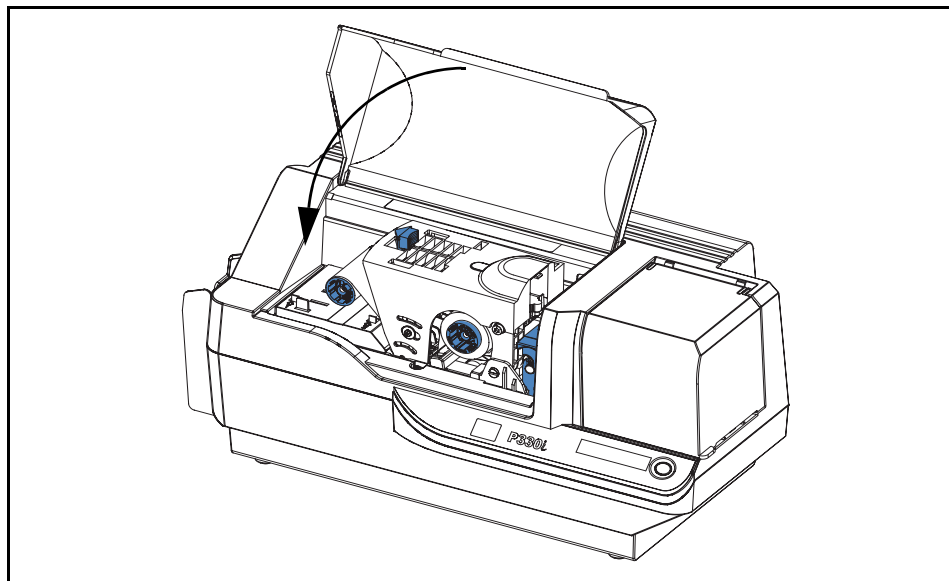

13

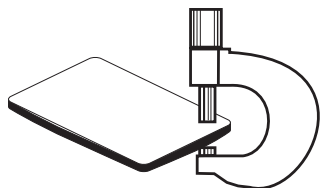
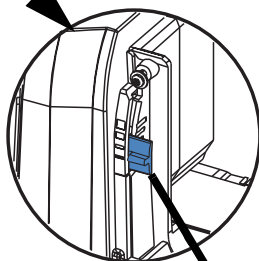
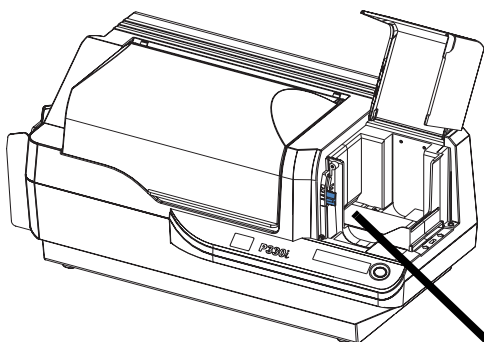
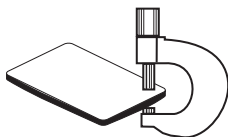

☐ 50 - 60 mil (1.27 - 1.52 mm)

☐ 30 - 50 mil (0.76 - 1.27 mm)

☐ 20 - 40 mil (0.51 - 1.02 mm)

☐ 10 - 20 mil (0.25 - 0.51 mm)

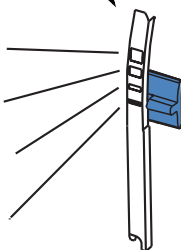

14

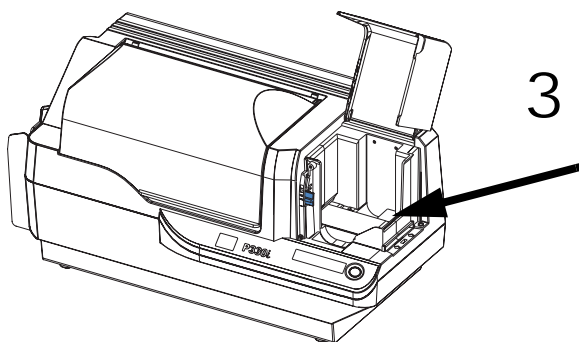
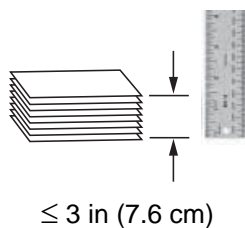
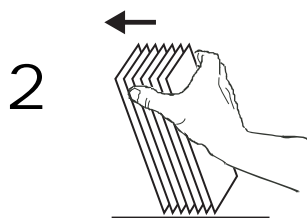
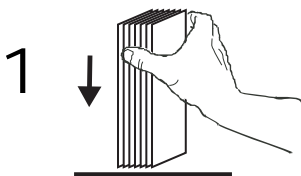

3

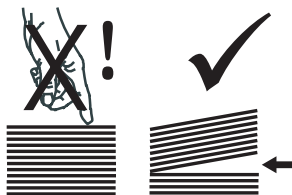
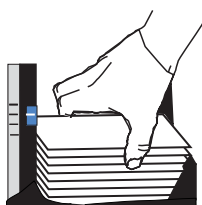

15

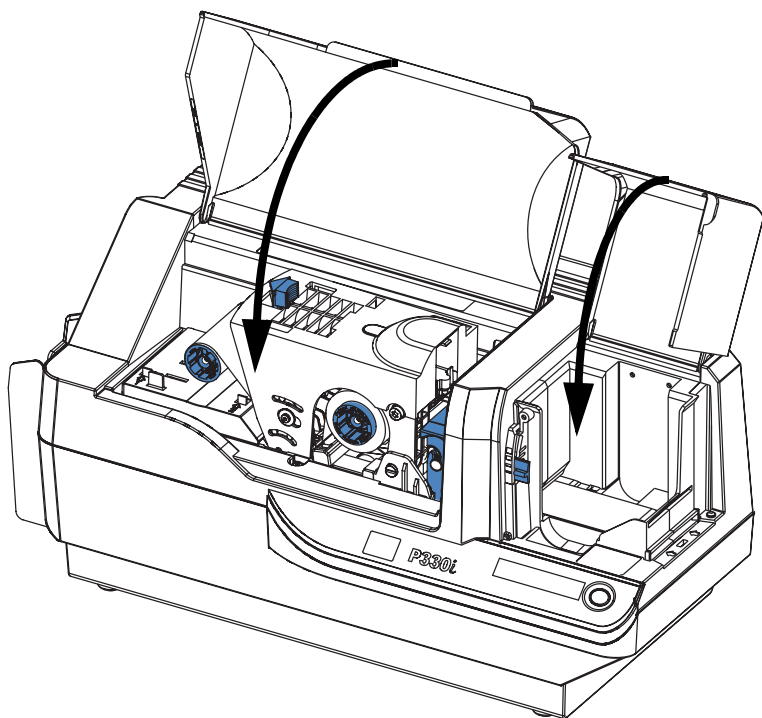

16

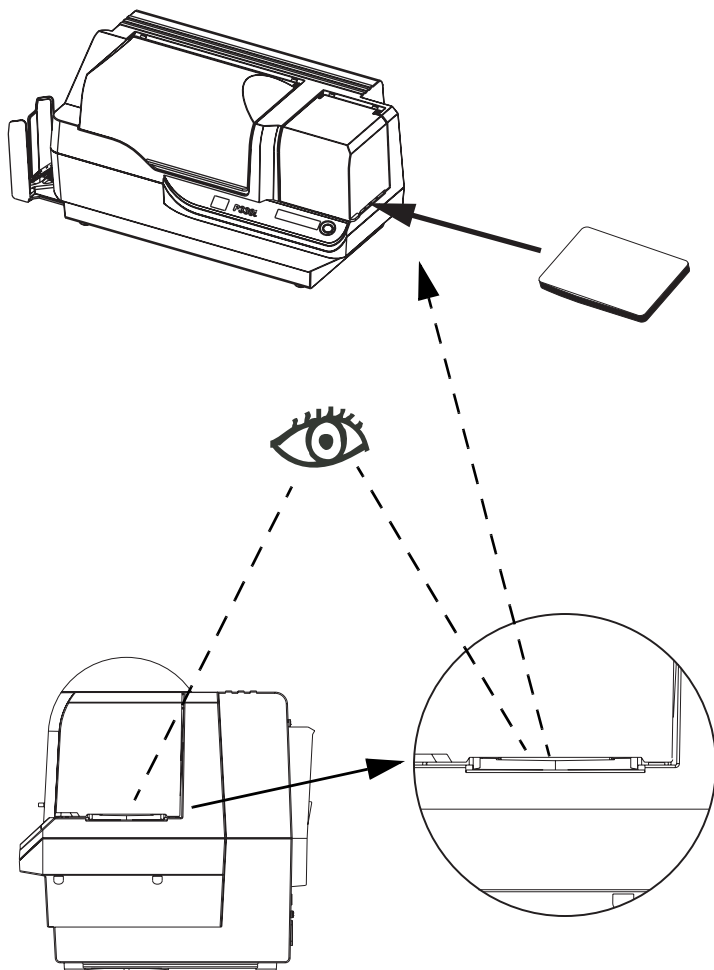
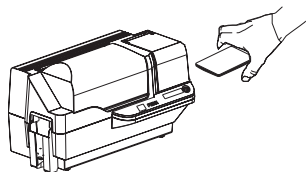

17

USB



10/100base-T

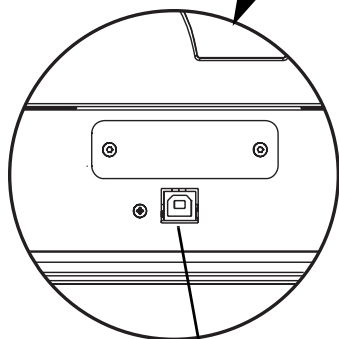
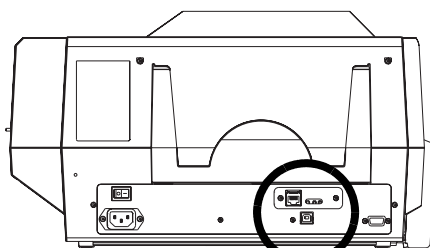
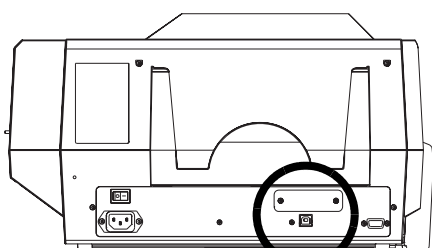
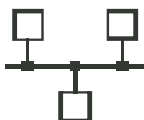

10/100base-T

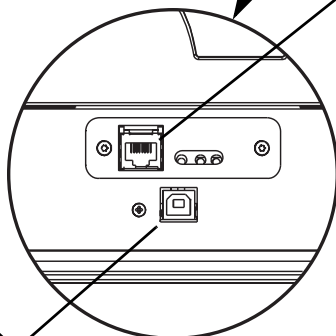
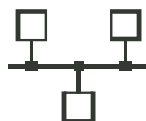

USB



18

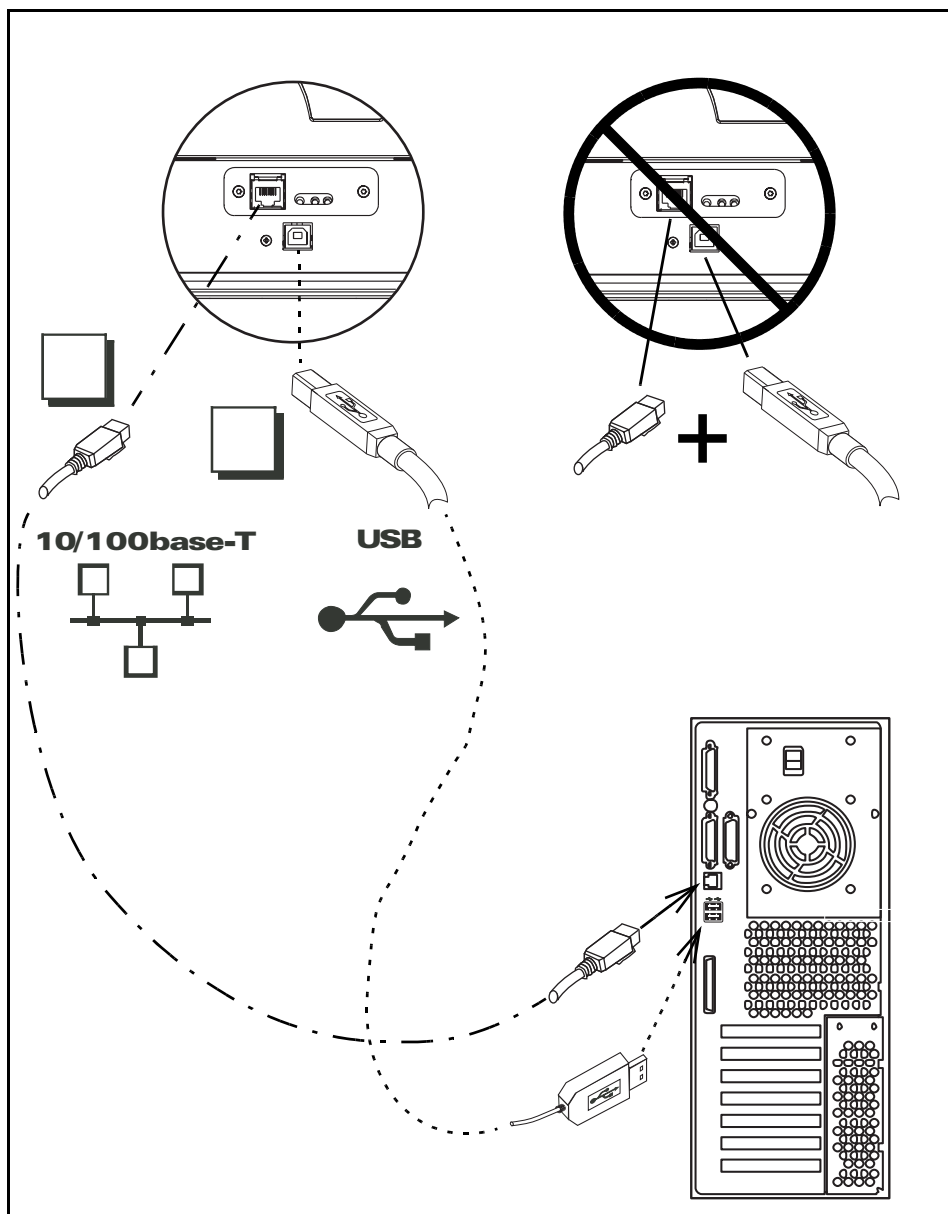
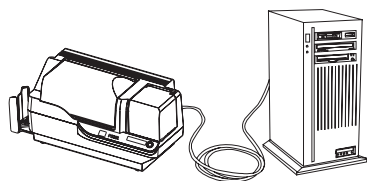

19

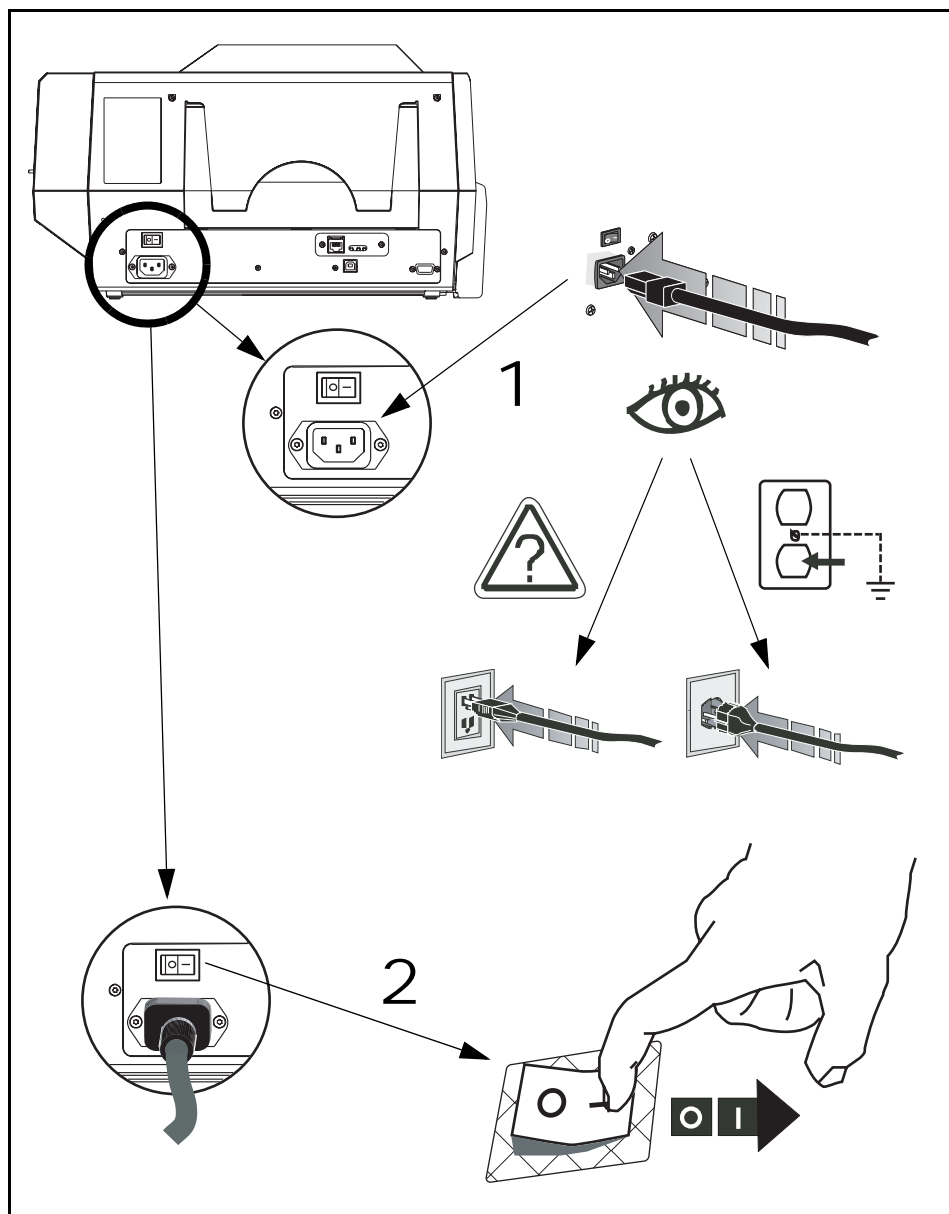
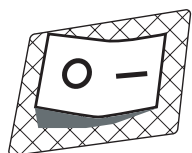

FCC Regulations

Models P330*i* and P330*m* have been tested and found to comply with the limits for a Class A digital device, pursuant to Part 15 of the FCC Rules. These limits are designed to provide reasonable protection against harmful interference when the equipment is operated in a commercial environment. This equipment generates, uses, and can radiate radio frequency energy and, if not installed and operated in accordance with the P330*i* and P330*m* User’s Manual, may cause harmful interference to radio communications. Operation of this equipment in a residential area is likely to cause harmful interference in which case the user will be required to correct the interference at his own expense.

Pursuant to Part 15.21 of the FCC Rules, any changes or modifications to this equipment not expressly approved by Zebra may cause harmful interference and void the FCC authorization to operate this equipment.

FCC Radiation Exposure Statement (applicable to 15.247 device only)

This equipment complies with FCC radiation exposure limits set forth for an uncontrolled environment. This equipment should be installed and operated with minimum 20 cm between the radiator and your body. This transmitter must not be collocated or operating in conjunction with any other antenna or transmitter unless authorized to do so by the FCC.

Industry Canada Notice

This device complies with Industry Canada ICES-003 class A requirements.
Cet équipement est conforme a l’ICES-003 classe A de la norm Industrielle Canadian.



89/336/EEC modified by 92/31/EEC and 93/68/EEC	EMC Directive	EN 55022 (1998)	RF Emissions control
	EMC Directive	EN 301489-3 V1.4.1	RF Emissions and immunity for radio equipment
	EMC Directive	EN 55024 (2001)	Immunity to Electromagnetic Disturbances
73/23/EEC modified by 93/68/EEC	Low voltage Directive	EN 60950 (2001)	Product safety
1999/5/CE	R&TTE Directive	EN300330-2 V1.1.1	Radio frequency interferences

For a formal Certificate, please contact Compliance Engineering at the Camarillo facility.

89/336/CEE modifiée par 92/31/CEE et 93/68/CEE	Directive CEM	EN 55022 (1998)	Contrôle des émissions de radiofréquence
	Directive CEM	EN 301489-3 V1.4.1	Émission de radiofréquences et immunité des appareils radio
	Directive CEM	EN 55024 (2001)	Immunité contre les perturbations électromagnétiques
73/23/EEC modifiée par 93/68/EEC	Directive basse tension	EN 60950 (2001)	Sécurité du Produit
1999/5/CEE	Directive R&TTE	EN300330-2 V1.1.1	Interférences dues aux fréquences radio

Pour obtention du certificat de conformité, veuillez contacter le responsable des normes sur le site de Camarillo.

89/336/EWG geändert durch 92/31/EWG und 93/68/EWG	EMV Vorschrift	EN 55022 (1998)	RF Emissionskontrolle
	EMV Vorschrift	EN 301489-3 V1.4.1	RF Emission und Schutz für Funkanlage
	EMV Vorschrift	EN 55024 (2001)	Schutz gegen elektromagnetische Störungen
73/23/EWG geändert durch 93/68/EWG	Niederspannungs-Vorschrift	EN 60950 (2001)	Produktsicherheit
1999/5/EG	R&TTE Vorschrift	EN300330-2 V1.1.1	Radiofrequenzstörungen

Falls Sie eine offizielles Zertifikat benoetigen, zu wenden Sie sich bitte an Compliance Engineering in Camarillo.

89/336/CEE modificado por 92/31/CEE y 93/68/CEE	Directiva CME	EN 55022 (1998)	Control de emisiones RF
	Directiva CME	EN 301489-3 V1.4.1	Emisiones e inmunidad RF para equipo de radio
	Directiva CME	EN 55024 (2001)	Inmunidad frente a las perturbaciones electromagnéticas
73/23/CEE modificada por 93/68/CEE	Directiva de baja tensión	EN 60950 (2001)	Seguridad de producto
1999/5/CE	Directiva R y TTE	EN300330-2 V1.1.1	Interferencias de frecuencias de radio

Para obtener un certificado de conformidad, comuníquese al departamento de ingeniería de Camarillo.

89/336/CEE modificata da 92/31/CEE e 93/68/CEE	Direttiva EMC	EN 55022 (1998)	Controllo delle emissioni RF
	Direttiva EMC	EN 301489-3 V1.4.1	Emissioni RF e immunità per apparecchiature radio
	Direttiva EMC	EN 55024 (2001)	Immunità alle Perturbazioni Elettromagnetiche
73/23/CEE modificata da 93/68/CEE	Direttiva Bassa Tensione	EN 60950 (2001)	Sicurezza dei prodotti
1999/5/CE	Direttiva R&TTE	EN300330-2 V1.1.1	Interferenze in Radiofrequenza

Per la certificatione formale, per favore, intraccia Compliant Enginiere presso l'ufficio di Camarillo.

由 92/31/EEC 与 93/68/EEC 修正的 89/336/EEC	EMC 《电磁兼容性》规定	EN 55022 (1998)	无线电频率发射控制
	EMC 《电磁兼容性》规定	EN 301489-3 V1.4.1	无线电设备的 RF (射频) 发射和免除
	EMC 《电磁兼容性》规定	EN 55024 (2001)	抗电磁干扰
由 93/68/EEC 修正 的 73/23/EEC	低电压规定	EN 60950 (2001)	产品安全
1995/5/CEE	R&TTE 《电磁兼容性》规定	EN 300330-2 V1.1.1	无线电频率的干扰

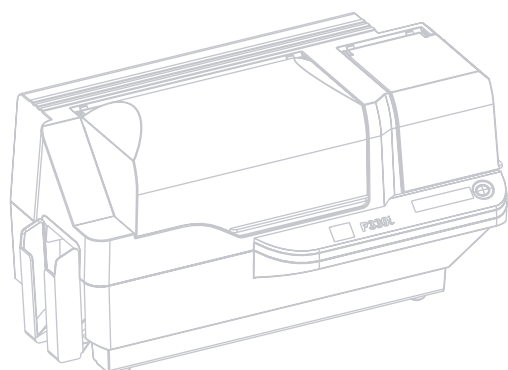

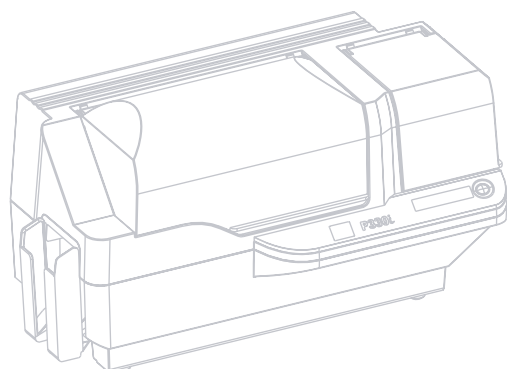

The Americas:

Zebra Technologies
Card Printer Solutions Headquarters
1001 Flynn Road
Camarillo, CA 93012-8706 USA
Telephone +1 805 579 1800
Fax +1 805 579 1808
Toll free in US 800 452 4056
e-mail: cards@zebra.com
Website: <http://www.zebracard.com>



Europe:

Zebra Technologies Europe Limited
Zebra House
The Valley Centre - Gordon Road
High Wycombe
Buckinghamshire HP13 6EQ UK
Tel: +44 (0) 870 241 1527
Fax: +44 (0) 870 241 0765
e-mail: eurosales@zebra.com



Latin America Sales Office:

9800 NW 41st Street, Suite 220
Doral FL 33178 USA
Telephone +1 305 558 3100
Fax +1 305 558 8485
e-mail: latinsales@zebra.com



Asia Pacific:

Zebra Technologies Asia Pacific, LLC
16 New Industrial Road
#05-03 Hudson TechnoCentre
Singapore 536204
Telephone +65 6858 0722
Fax +65 6885 0836
e-mail: asiasales@zebra.com

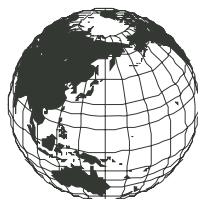

**Card
Printer
Solutions**



980449-002