

**Zebra Technologies Corporation**

333 Corporate Woods Parkway
Vernon Hills, Illinois 60061.3109 U.S.A.
Telephone +1 847.634.6700
Facsimile +1 847.913.8766

**Zebra Technologies Europe Limited**

Zebra House
The Valley Centre, Gordon Road
High Wycombe
Buckinghamshire HP13 6EQ, UK
Telephone +44 (0)1494 472872
Facsimile +44 (0)1494 450103

**Zebra Technologies
Latin American Sales Office**

6175 NW 153rd Street
Suite 121
Miami Lakes FL 33014 U.S.A.
Telephone +1 305.558.8470
Facsimile +1 305.558-8485

**Zebra Technologies
Regional Sales Office - Asia/Pacific**

1 Sims Lane, #06-11
Singapore 387355
Telephone +011 / 65 6842 0322
Facsimile +011 / 65 6842 0366



Zebra® TLP 2824™



980484-001A

TLP 2824 -lämpötulostimet

EMC-direktiivi EN 55022-B 1998
EN 55024 1998
CB-kaavio EN 60950 1991

Radiotaajuussäteilyn säätö
Sähkömagneettinen häiriönsieto
Turvallisuus

TLP 2824 Termiska skrivare

EMC-direktiv EN 55022-B 1998
EN 55024 1998
CB regler EN 60950 1991

RF emissionskontroll
Tålighet mot elektromagnetiska störningar
Säkerhet

Termoskrivnerne TLP 2824

EMC-Direktiv EN 55022-B 1998
EN 55024 1998
CB skjema EN 60950 1991

RF-emisjonskontroll
Uimottakelighet mot elektromagnetiske
forstyrrelser
Sikkerhet

Impresoras térmicas TLP 2824

Normativa EMC EN 55022-B 199
EN 55024 1998
CB Esquema EN 60950 1991

Control de emisiones de radiofrecuencia
Inmunidad a las alteraciones electromagnéticas
Seguridad

Stampante termica TLP 2824

Direttiva EMC EN 55022-B 1998
EN 55024 1998
CB Schema EN 60950 1991

Controllo delle emissioni di frequenza
radiofonica
Immunità ai disturbi elettromagnetici
Sicurezza

Impressoras térmica TLP 2824

Diretiva EMC EN 55022-B 1998
EN 55024 1998
CB Esquema EN 60950 1991

Controle de Emissões de RF
Imunidade a Distúrbios Eletromagnéticos
Segurança

Θερμικοί Εκτυπωτές TLP 2824

Οδηγία ΗΜΣ (EMC) EN 55022-B 1998
EN 55024 1998
CB Διάγραμμα EN 60950 1991

Έλεγχος εκπομπών ΡΣ
Ανοσία σε ηλεκτρομαγνητικές παρεμβολές
Ασφάλεια

TLP 2824 termoprinter

EMC direktiv EN 55022-B 1998
EN 55024 1998
CB certifikatorning EN 60950 1991

Udstråling
Ujmodtagelig for elektromagnetisk støj
Sikkerhed

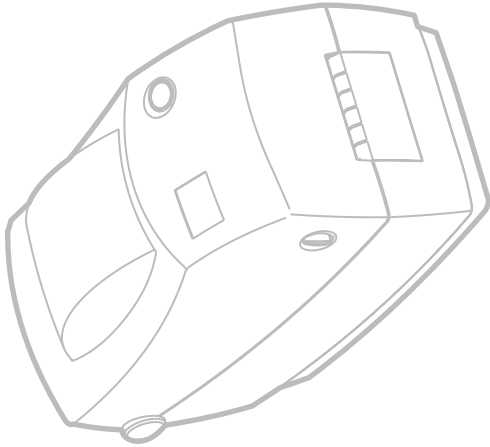



FCC - DECLARATION OF CONFORMITY:

Model: TLP 2824 conforms to the following specification: FCC Part 15, Subpart B, Section 15.107(a) and Section 15.109(a) Class B digital device

Supplemental Information: This device complies with Part 15 of the FCC Rules. Operation is subject to the following Two Conditions: (1) This device may not cause harmful interference , and (2) this device must accept any interference received, including interference that may cause undesired operation.

INDUSTRY CANADA NOTICE:

This device complies with Industry Canada ICS-003 class B requirements.
Cet équipement est conforme à l'ICS-003 classe B de la norme Industrielle Canadienne.



TLP 2824 Thermal Printers

<u>EMC Directive</u>	EN 55022-B 1998 EN 55024 1998	RF Emissions control Immunity to Electromagnetic Disturbances
<u>CB Scheme</u>	EN 60950 1991	Safety

TLP 2824 Thermodrucker

<u>EMC Direktive</u>	EN 55022-B 1998 EN 55024 1998	HF-Emissionsbegrenzung Festigkeit gegen elektro- magnetische Störungen
<u>CB Entwurf</u>	EN 60950 1991	Sicherheit

Imprimante thermique TLP 2824

<u>Directive EMC</u>	EN 55022-B 1998 EN 55024 1998	Contrôle des émissions RF Protection controles perturbations électromagnétiques
<u>CB Arrangement</u>	EN 60950 1991	Sûreté

Thermische printer TLP 2824

<u>EMC-richtlijn</u>	EN 55022-B 1998 EN 55024 1998	RF emissieregeling Immunititeit voor elektromagnetische storingen
<u>CB schema</u>	EN 60950 1991	Veiligheid

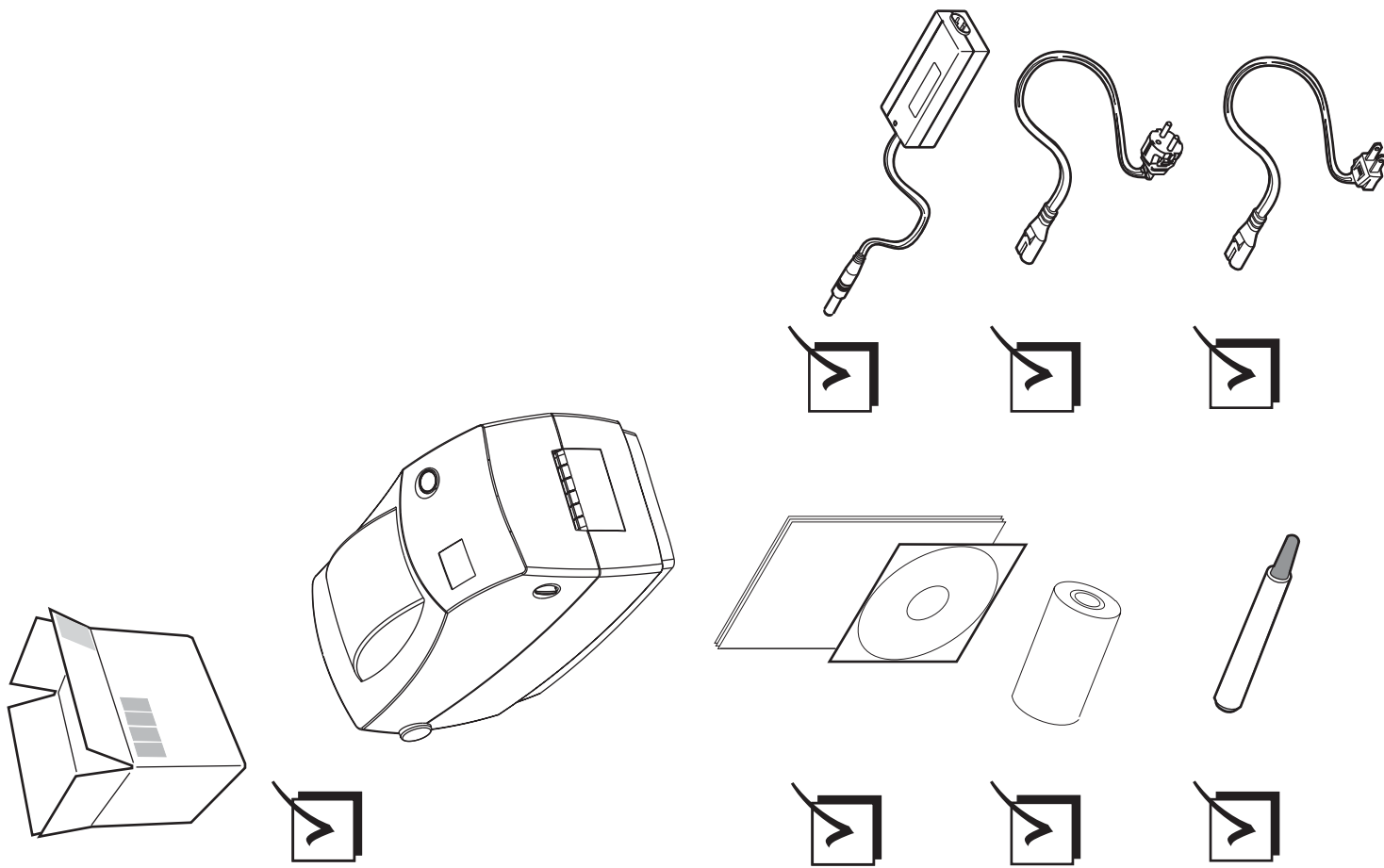

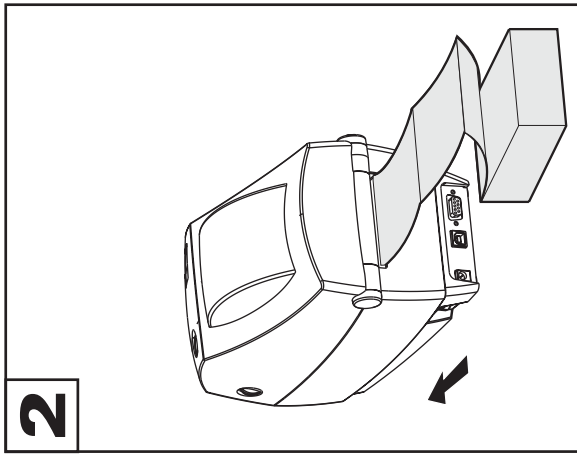
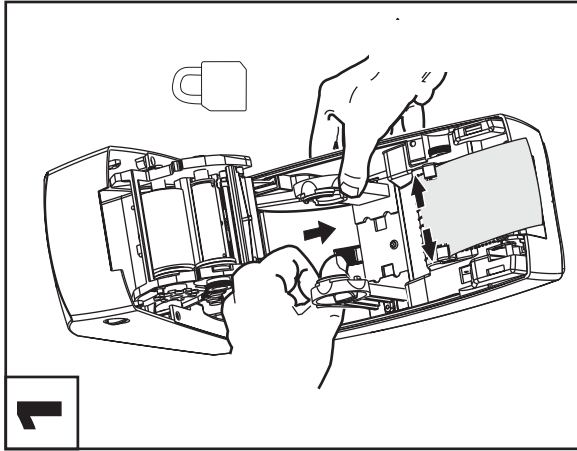
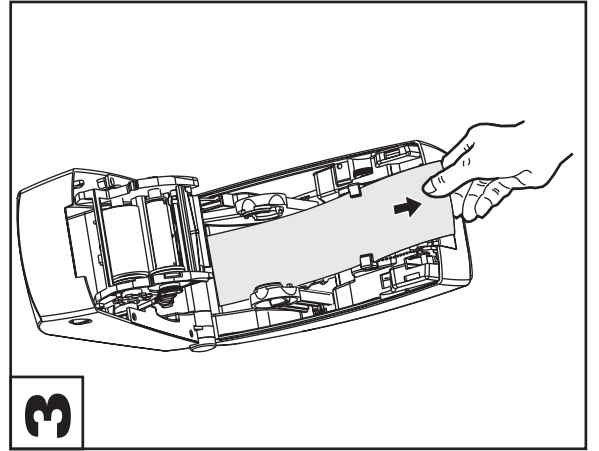
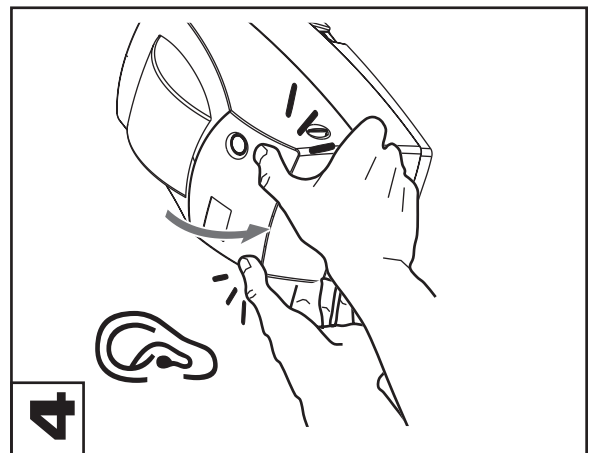
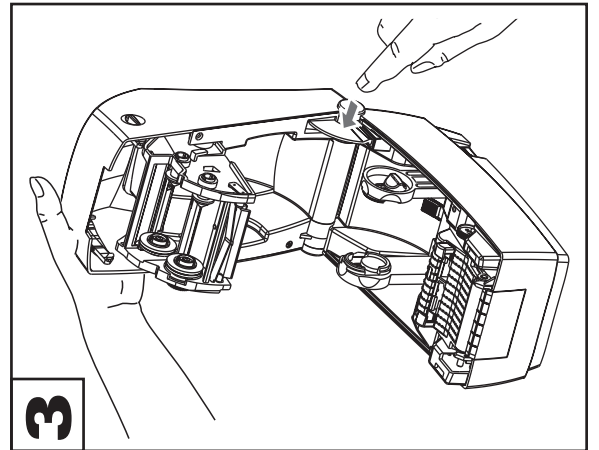
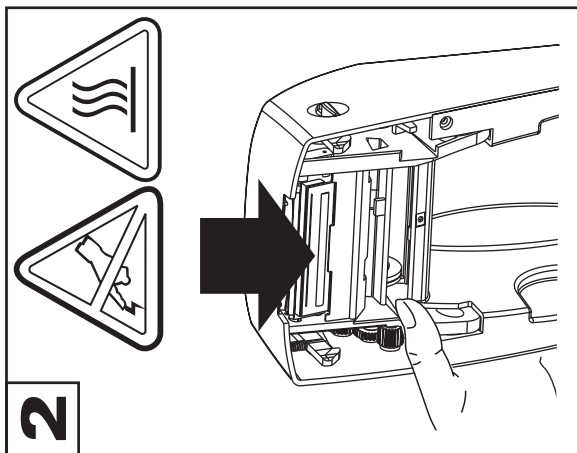
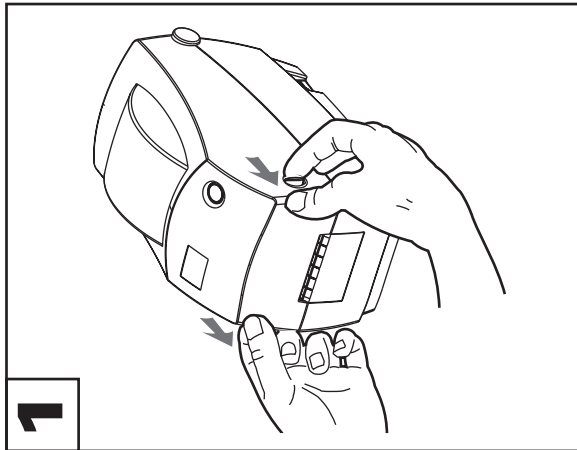
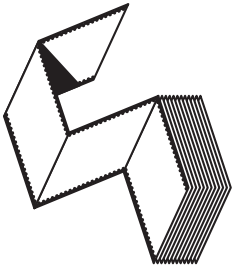
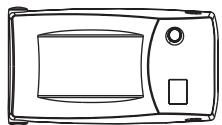
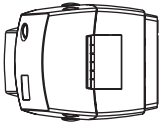
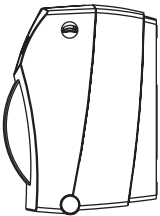

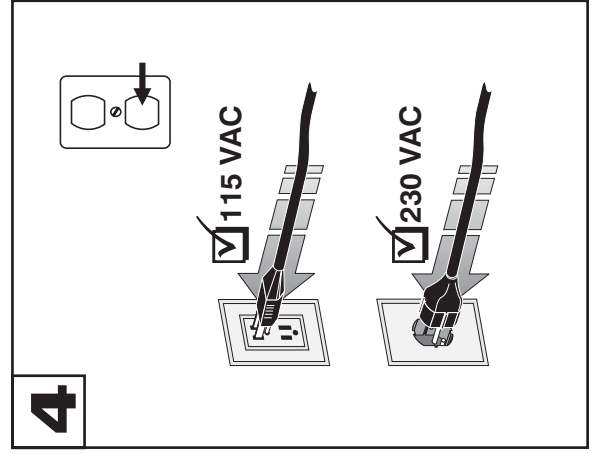
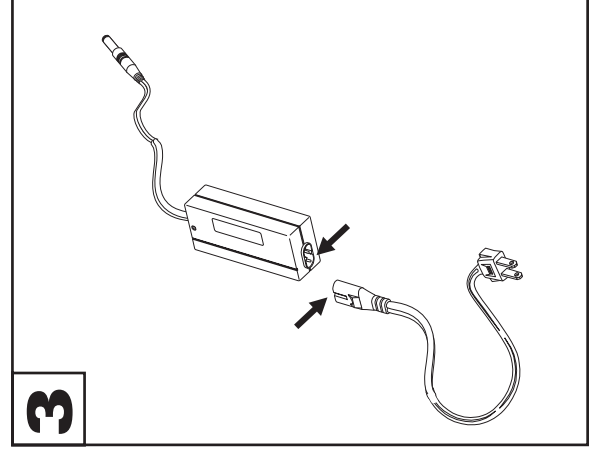
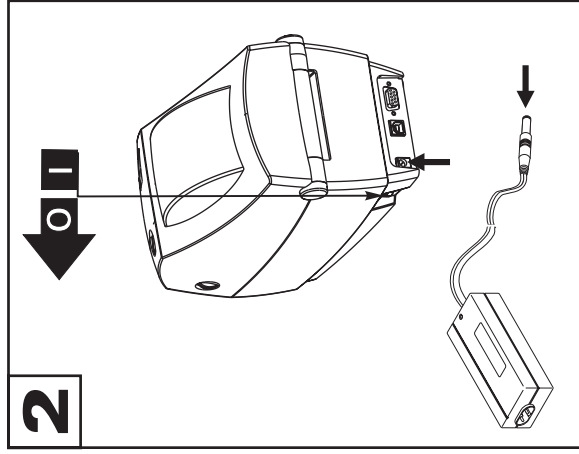
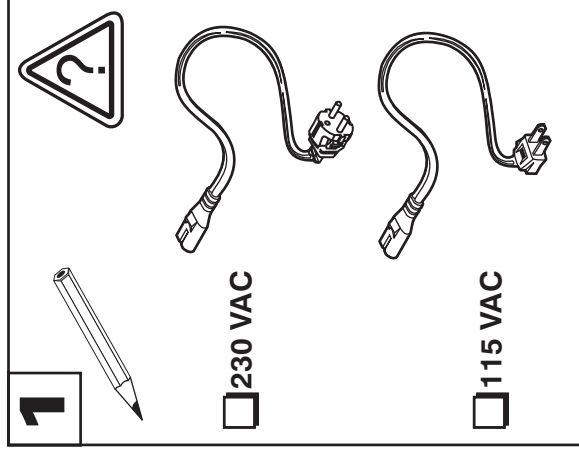
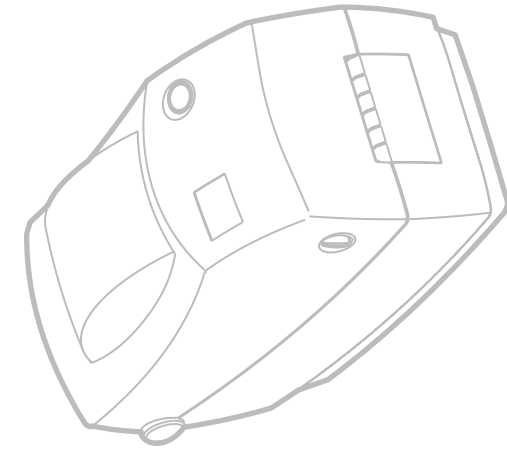

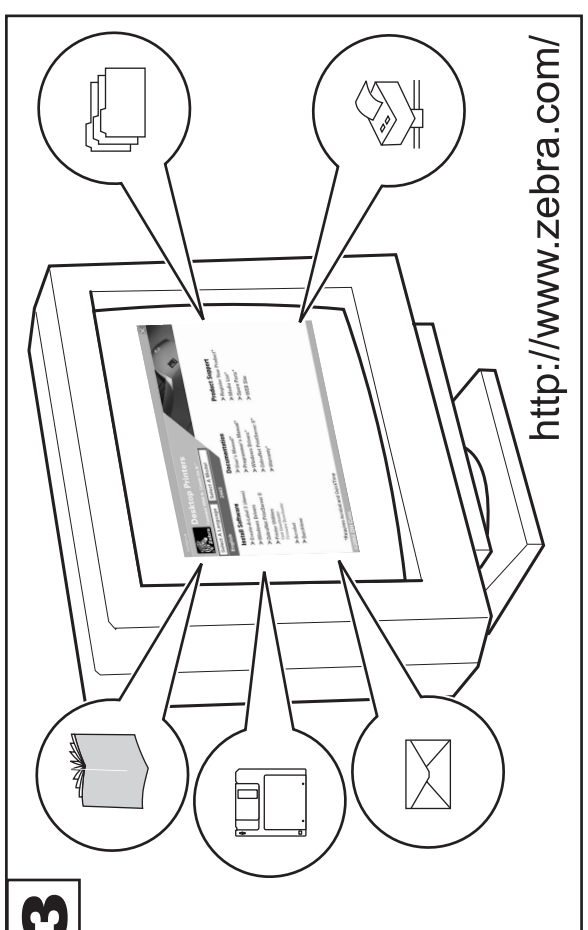
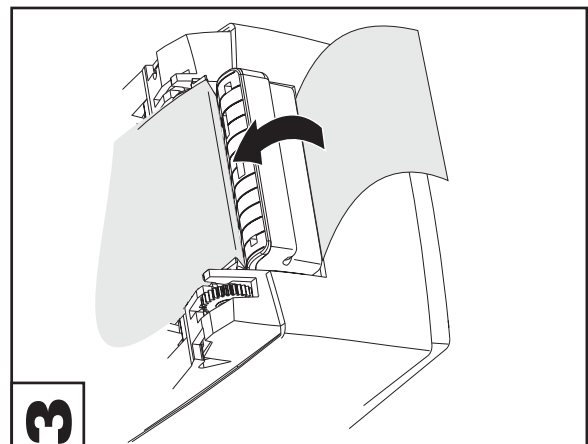
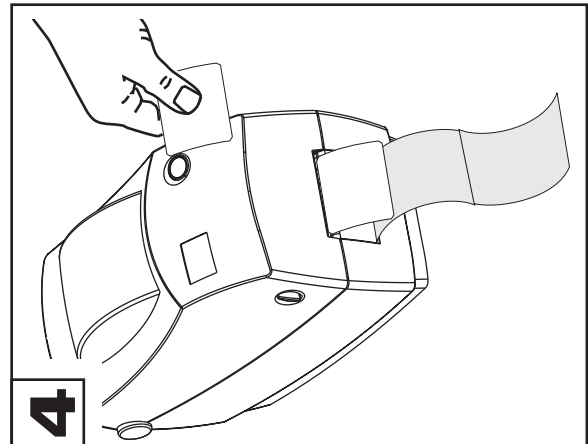
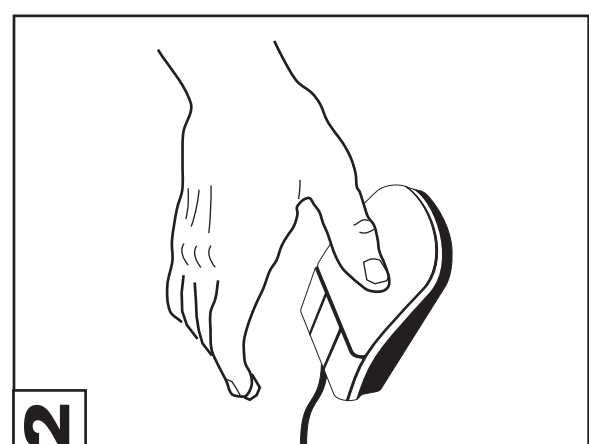
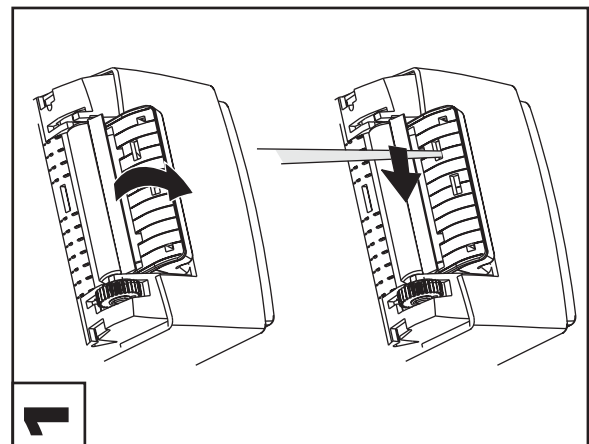
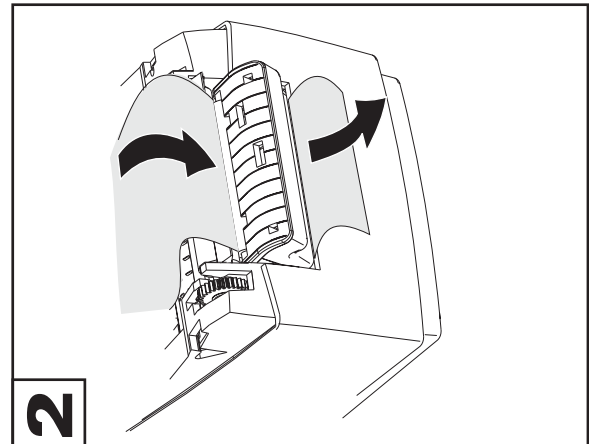
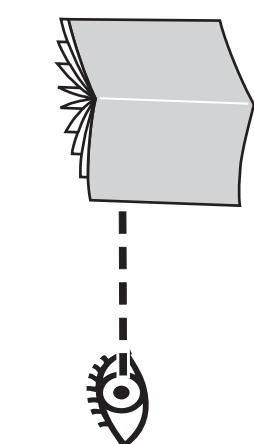
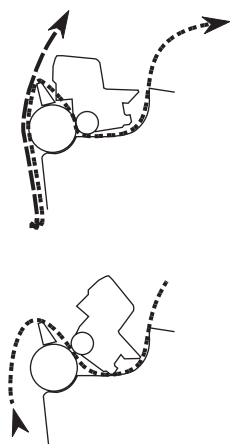

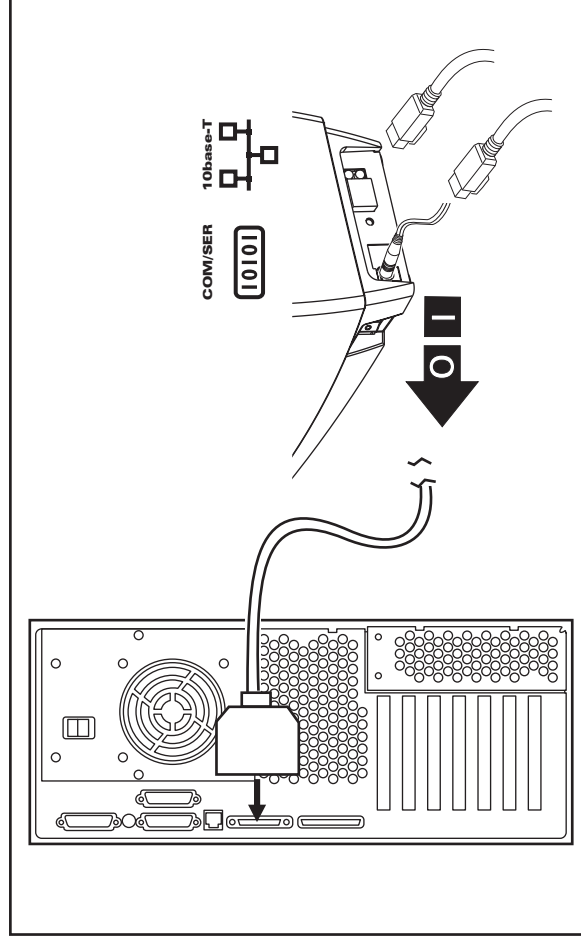
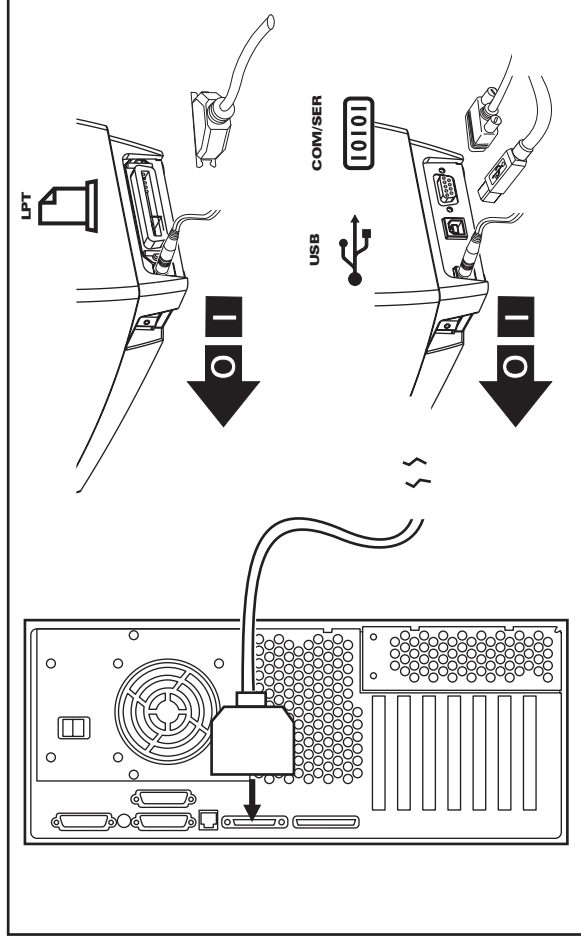
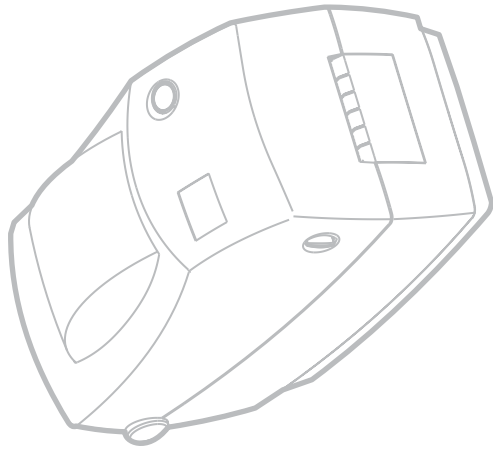
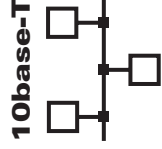
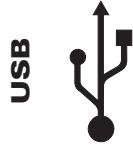

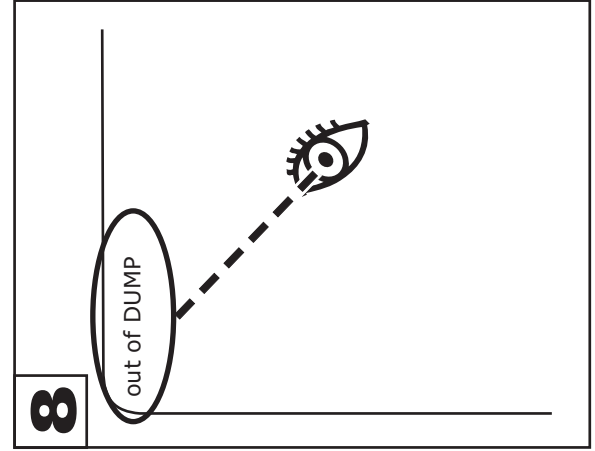
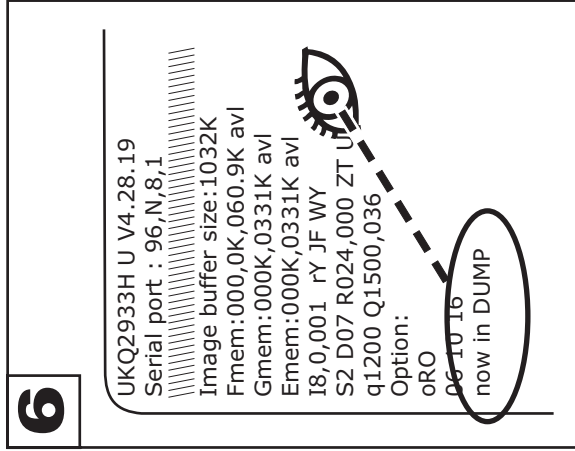
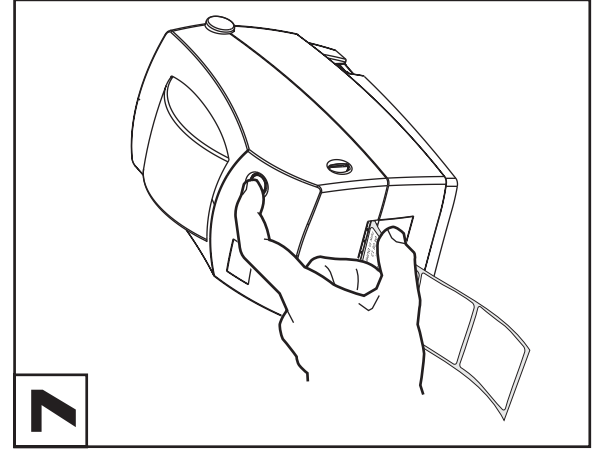
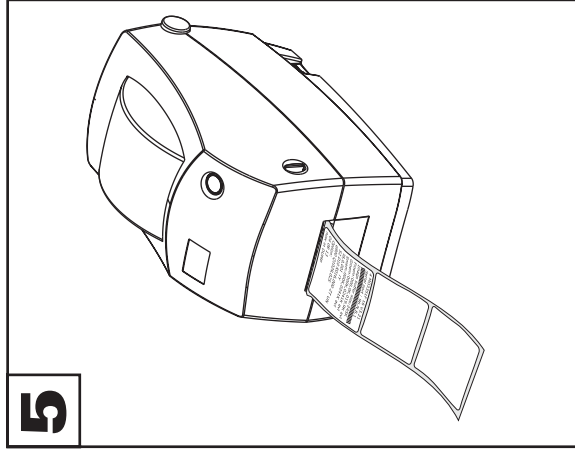
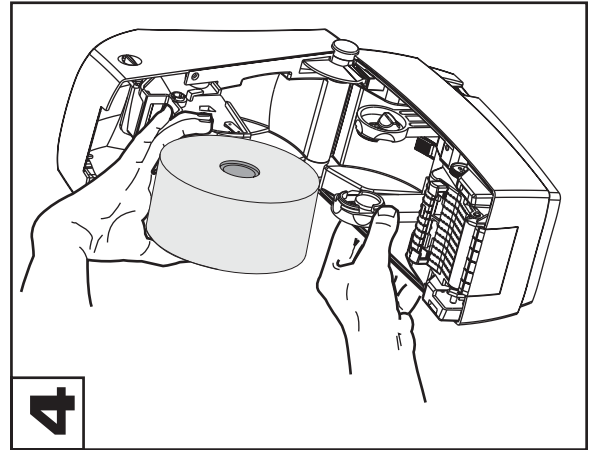
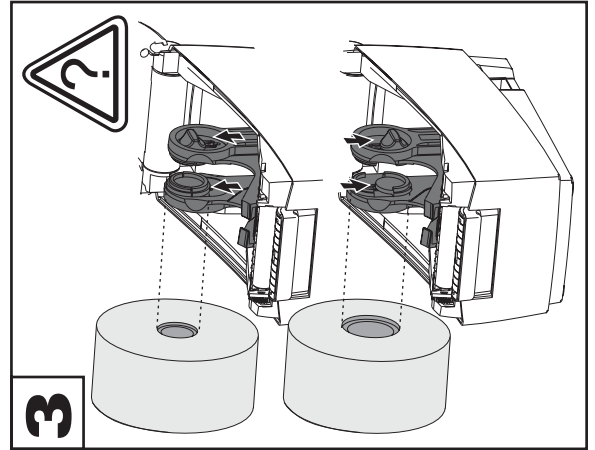
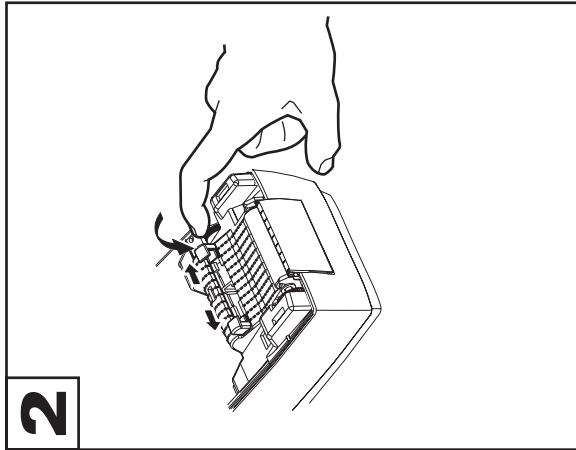
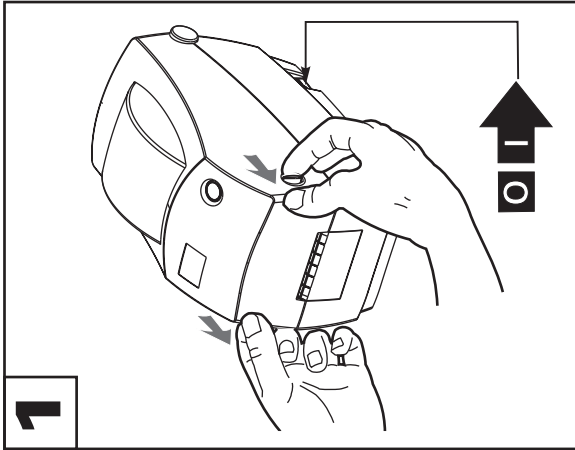
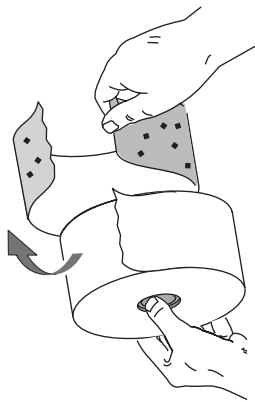

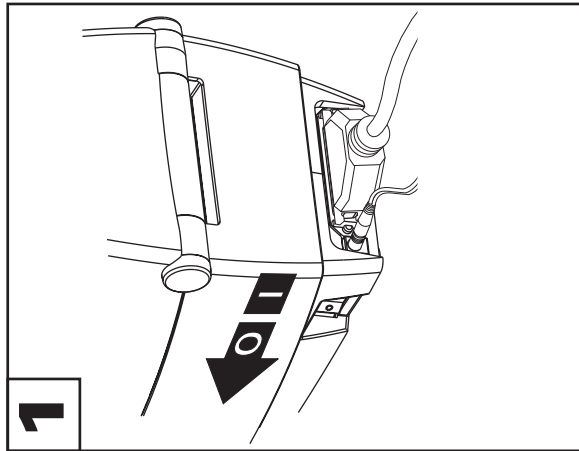
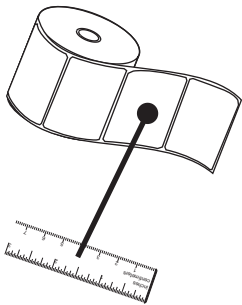

1

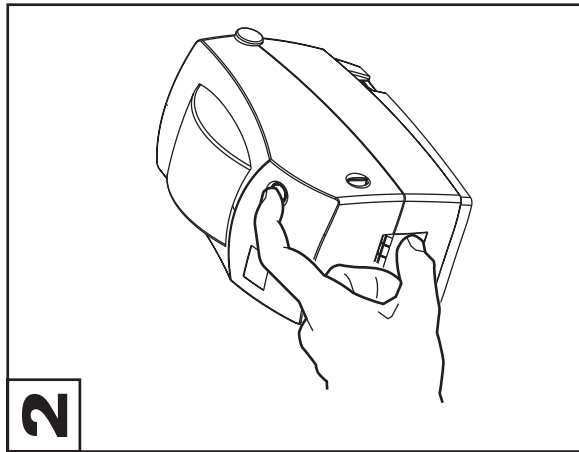

2

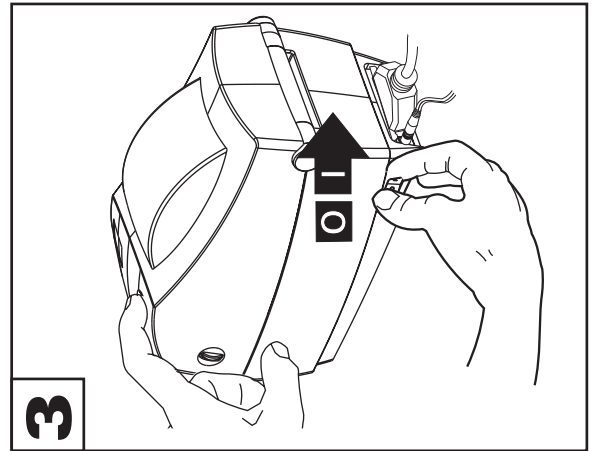

3

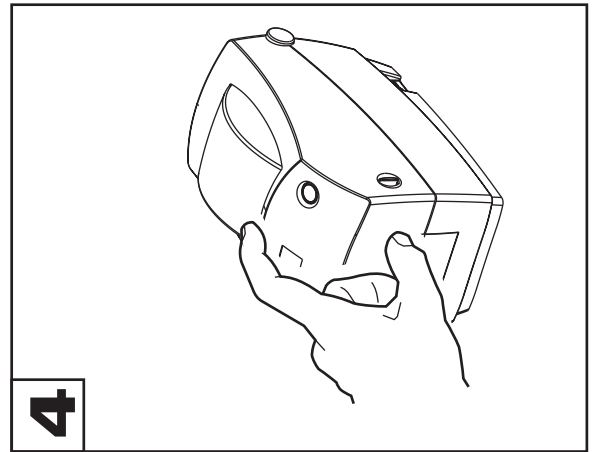

4

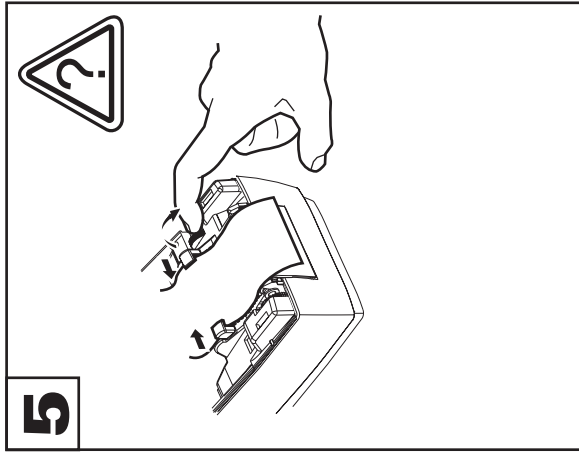

5

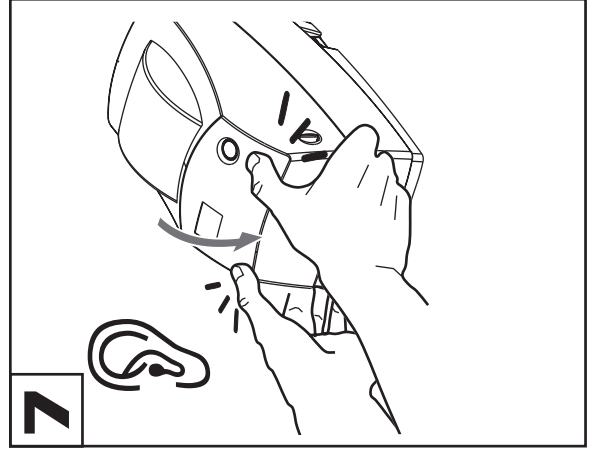

7

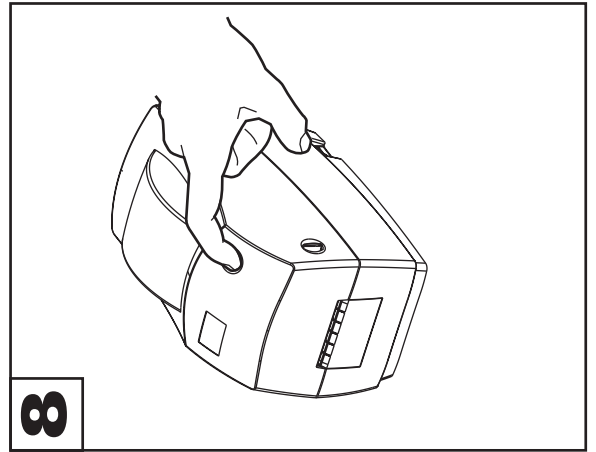

8

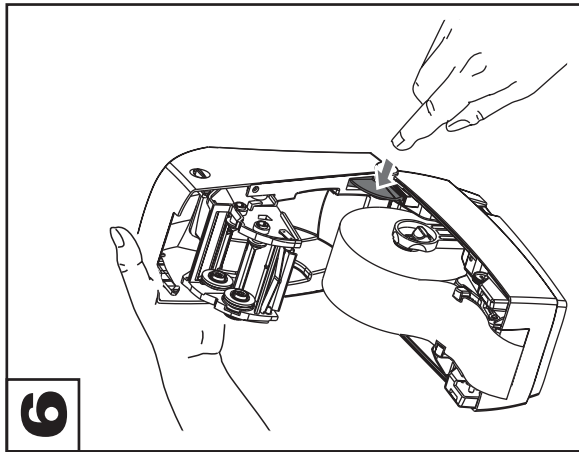

6

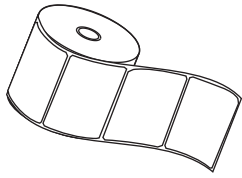

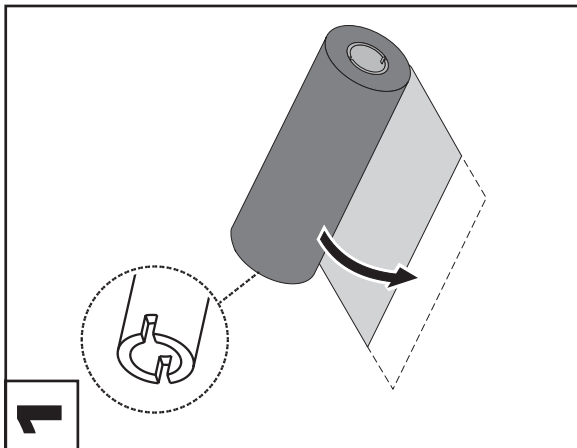
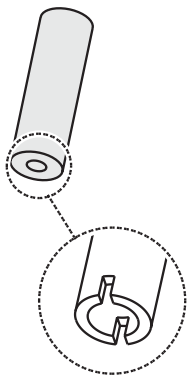

1

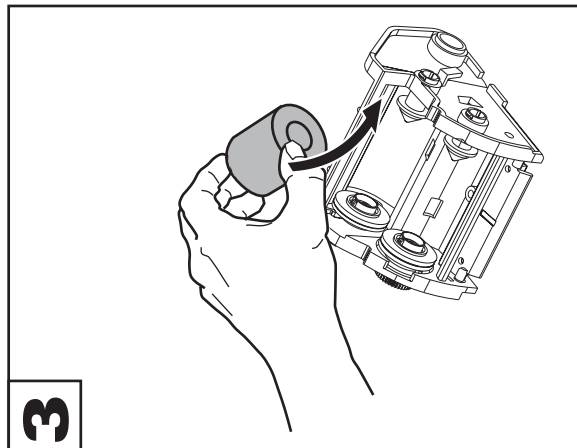

3

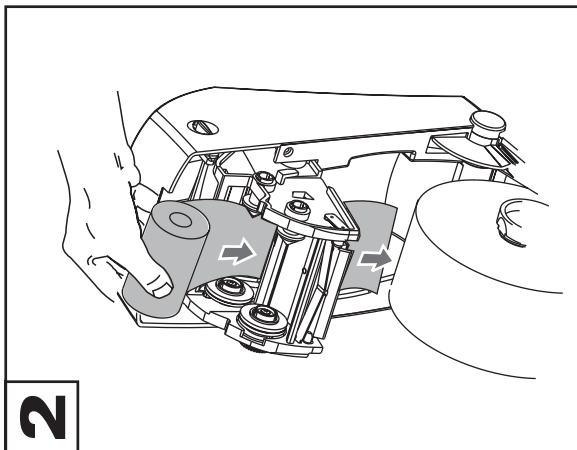

2

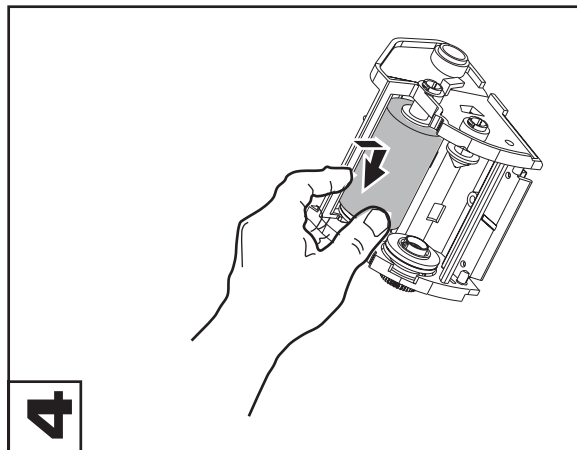

4

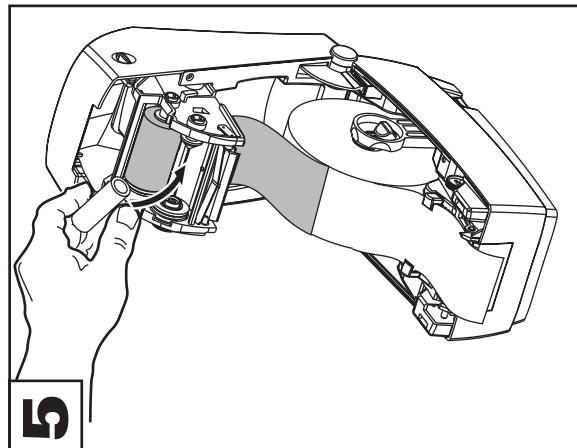
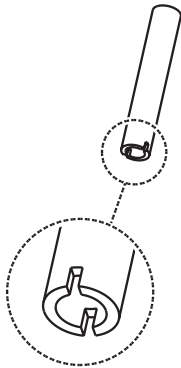

5

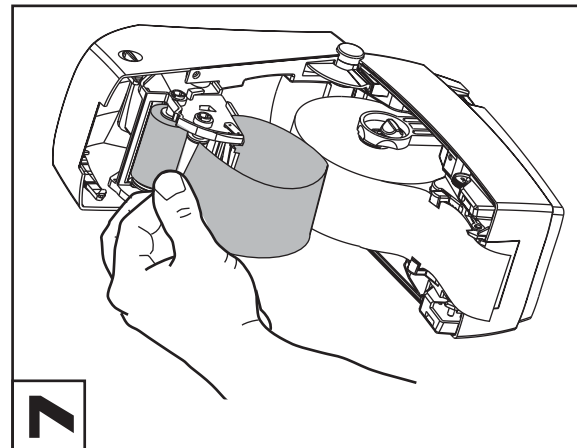

7

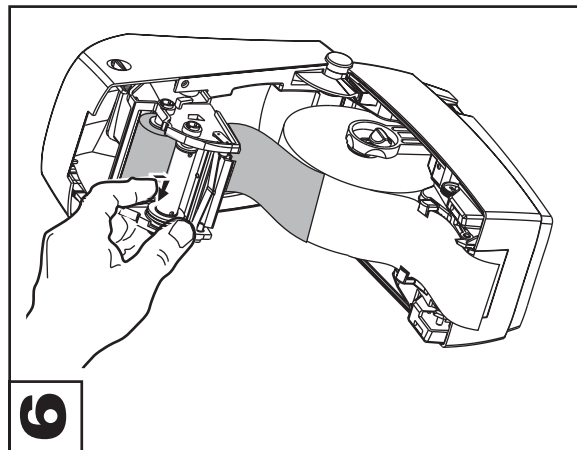

6

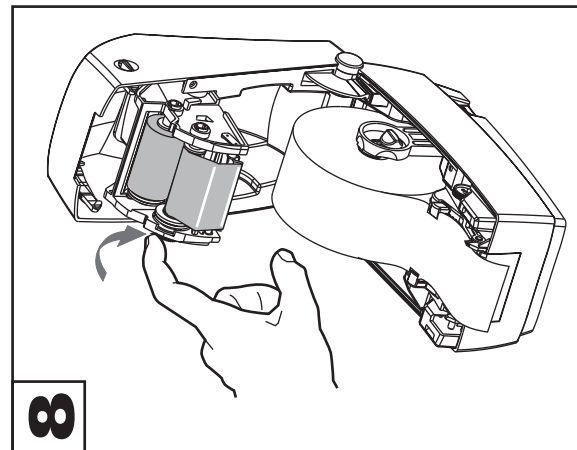

8