

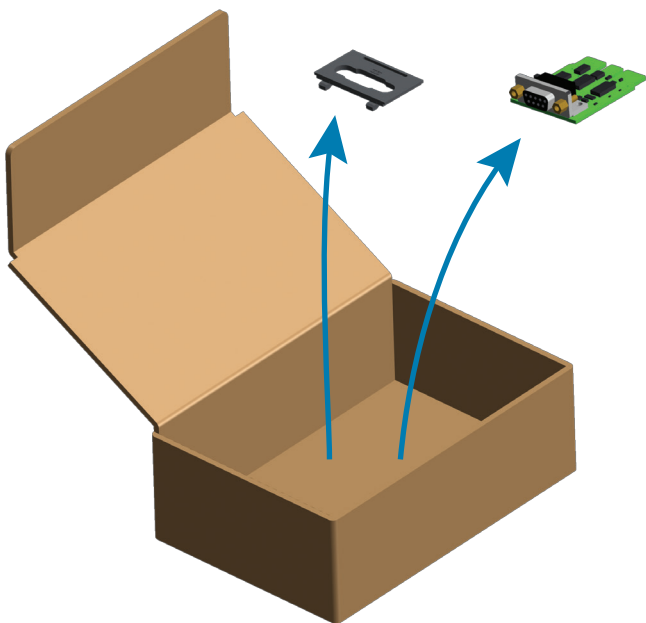

ZD410 Serial Module Option



www.zebra.com/zd410d-info



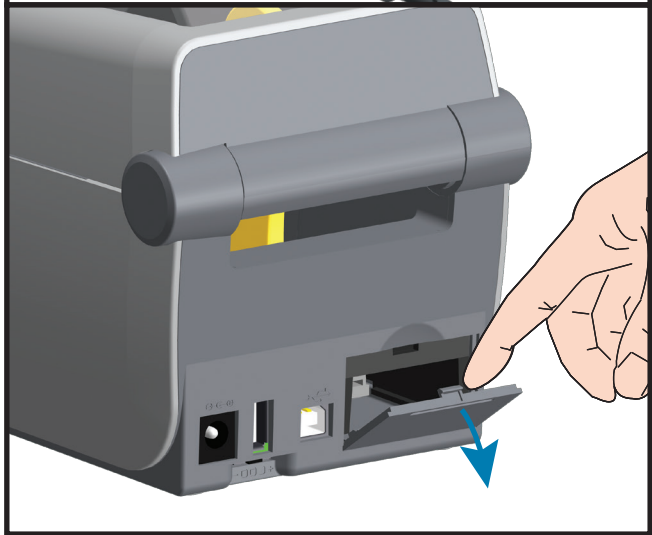
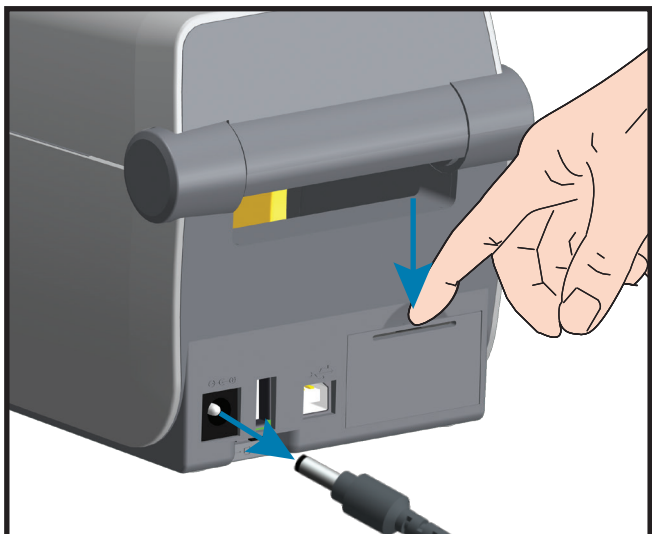

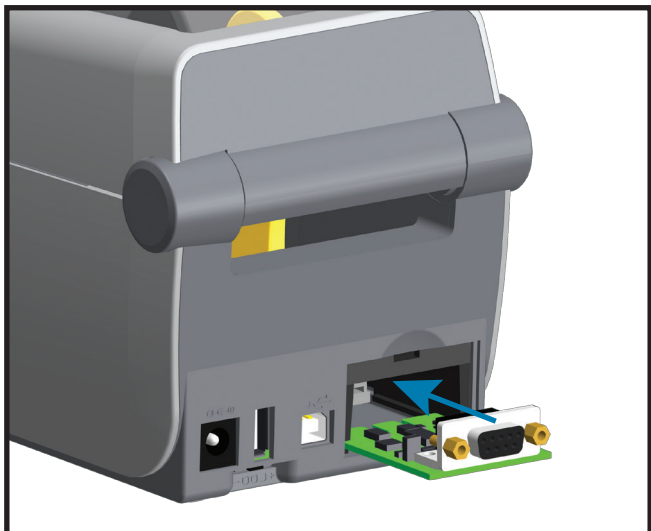



<http://www.zebra.com/locations>

Corporate Headquarters

+1 800 423 0442

inquiry4@zebra.com

Asia-Pacific Headquarters

+65 6858 0722

contact.apac@zebra.com

EMEA Headquarters

zebra.com/locations

mseurope@zebra.com

Latin America Headquarters

+1 847 955 2283

la.contactme@zebra.com

©2015 ZIH Corp. and/or its affiliates. All rights reserved. Zebra and the stylized Zebra head are trademarks of ZIH Corp., registered in many jurisdictions worldwide. All other trademarks are the property of their respective owners.



PAP

Printed in China



212295-001