

Installation Instructions

This kit includes the parts and documentation necessary to install the one inch media hanger into the following printers:

- ZT410
- ZT411

Read these instructions thoroughly before installing this kit.

Parts List

Before proceeding, verify that your kit contains the following items. To reorder specific parts, navigate to [Zebra.com/parts](https://zebra.com/parts), and select your printer model.

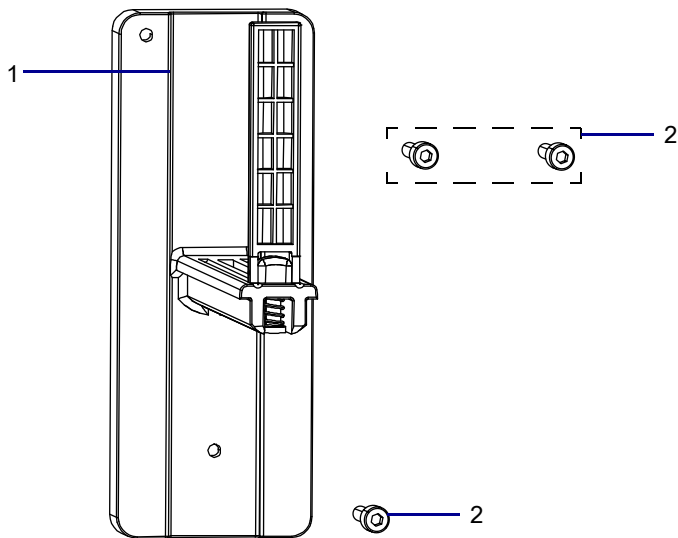

Item	Description	Qty
1	Media hanger	1
2	Screw, M4 × 0.7 × 12 (sold in quantities of 25)	3

- TOOLS NEEDED:**
- Metric hexalobular wrench set

Prepare for Installation



CAUTION: Turn off (O) the printer and disconnect it from the power source before performing the following procedure.

- 1. Remove the media from the printer.
- 2. Is this a new option?

If...	Then...
Yes	Continue with "Remove the Old Metal Hanger".
No	Go to "Remove the Old One Inch Hanger on page 3".

Remove the Old Metal Hanger

- 1. Remove the two screws (1) securing the media hanger (2) to the printer.

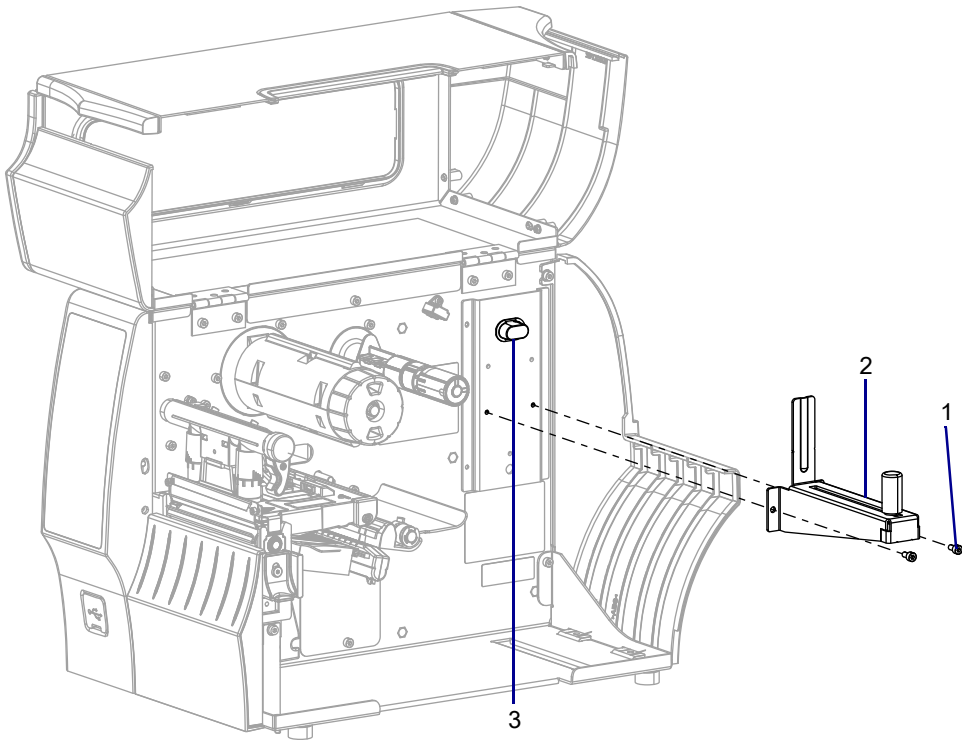

- 2. Remove the media hanger spacer.
- 3. Go to "Install the New One Inch Media Hanger on page 3".

Remove the Old One Inch Hanger

1. Remove the three screws (1).
2. Remove the old hanger (2).

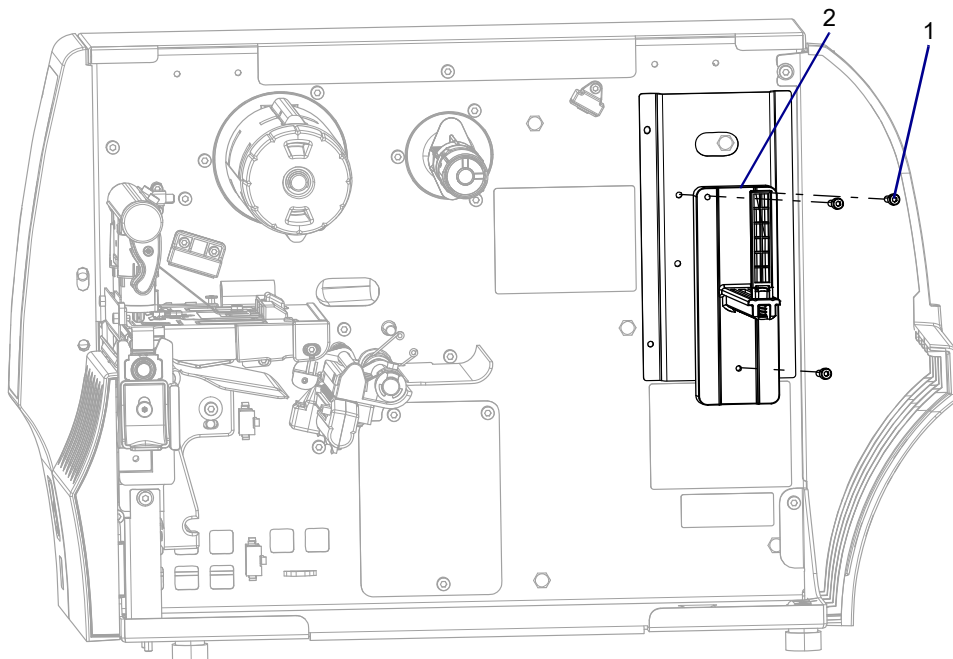

Install the New One Inch Media Hanger

1. Align the three mounting holes.
2. Install the three new screws (1).

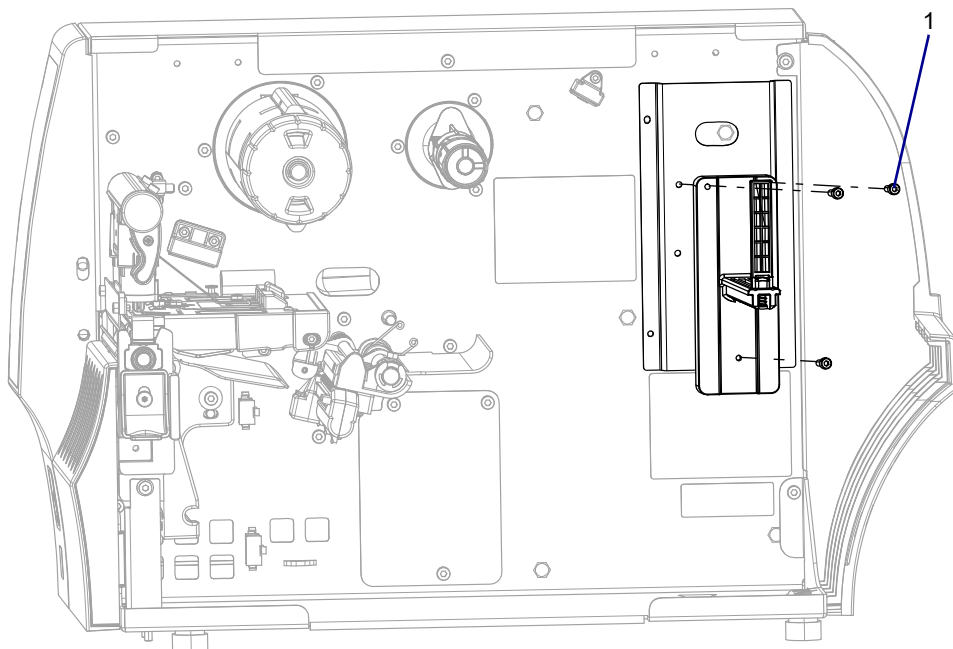

Resume Printer Operation

1. Reinstall media and ribbon (if used).
2. Close the media door.
3. If you disconnected the AC power cord and interface cables, reconnect them, and then turn on the printer power.
4. If necessary, press Pause to resume printer operation.

The installation is complete.