



EM220II Quad Cradle Installation Guide

P1007752-027 (Rev.1.0)

EM220II Quad Cradle

Information

This installation guide provides information required for product installation and use. The EM220II Quad cradle offers simultaneous recharging of up to four EM220II printers.

Components

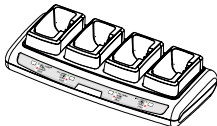

Quad Cradle



AC/DC Adaptor



Power Cord



Installation Guide

Installation Precautions

1. Avoid placement under direct sunlight and/or locations subject to excessive heat.
2. Do not use or store in locations subject to high temperatures and/or humidity.
3. Do not use or store in dusty locations.
4. Do not install in unstable and/or non-level locations.
5. Subjecting the product to strong vibration and/or shock can cause damage.
6. Secure sufficient space in the installation area to facilitate easy usage.

Connecting the cables

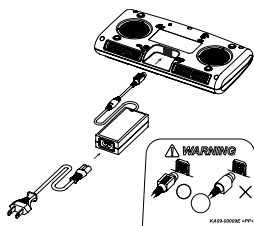

1. Connect the power cord to the adaptor, and connect the adaptor to the power connector of the Quad Cradle.
2. Plug the power cord into a power Outlet. Input power is 100 ~ 240VAC, 50/60Hz, 1.0A.
3. When the power is supplied, the yellow, green and red LED are on for three seconds and do the self-test.

WARNING

Use only designated AC/DC adaptor. (12VDC, 3A)

NOTE

LED	Self-Test
Yellow LED Blinking	Error Condition of Quad Cradle

CAUTION

1. Initially, Quad Cradle performs self test when power is on. When error occurs, Yellow LED will be blinking.
2. When Yellow LED is blinking continuously, remove the printer and check if alien substance is on the contact socket on Printer or Quad Cradle. Then disconnect and connect power cord 4 to 5 times to check connection status.
3. Yellow LED is still blinking with above procedures, contact your local dealer.

Battery Charging

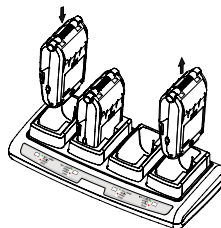

1. Turn the printer off.
2. Slide the printer in the Quad Cradle as shown in the picture.
3. Push the printer in until a clicking sound is heard
4. Charging will begin when the printer is installed.
5. When charging complete, Pull out the printer to separate it.

CAUTION

Please be sure to use the battery with external power contacts.

NOTE

Battery charging status descriptions are as follows.

LED	Charging Status	Charge Time
Red LED On	Charging	2.5 hours
Green LED Blinking	Over 80% Charged	
Green LED On	Fully Charged	
Red LED Blinking	Error Replace or Reinstall Battery	

CAUTION

1. If the red LED of the charger blinks, install the printer again.
2. If the red LED continues to blink despite several attempts (4 ~ 5 times) to install the printer, contact your local dealer.
3. The charging time may vary depending on the type of the charger or ambient temperature.

WEEE (Waste Electrical and Electric Equipment)



This marking shown on the product or its literature, indicates that it should not be disposed with other household wastes at the end of its working life. To prevent possible harm to the environment or human health from uncontrolled waste disposal, please separate this from other types of wastes and recycle it responsibly to promote the sustainable reuse of material resources. Household users should contact either the retailer where they purchased this product, or their local government office, for details of where and how they can take this item for environmentally safe recycling. Business users should contact their supplier and check the terms and conditions of the purchase contract. This product should not be mixed with other commercial wastes for disposal.

Zebra Technologies Corporation

Web site: <http://www.zebra.com>

Zebra Technologies Corporation (Global/Americas Headquarters)
333 Corporate Woods Parkway, Vernon Hills, IL 60061-3109 USA
Tel: +1 847 634 6700 or +1 800 423 0442

Zebra Technologies Europe Limited
Dukes Meadow, Millboard Road, Bourne End, Buckinghamshire, SL8 5XF, UK
Tel: +44 (0)1628 556000

Zebra Technologies Asia Pacific, LLC
120 Robinson Road#06-01 Parakou BuildingSingapore 68913
Tel: +65 6858 0722

Latin American Sales Office
9800 NW 41st StreetSuite 220Doral, FL 33178 USA
Tel: +1 305 558 8470