



ZEBRA® ZQ500™-serien

Mobile skrivere

Hurtigstartveiledning

Innhold

I esken..... 3

Oversikt 4

Fjerne og sette inn batteriet..... 6

Lade smart-batteriet..... 7

 UCL172-4 Quad-lader (AC18177-5).....7

 Smart-lader-2 (SC2) enkeltbatterilader (P1031365-063)8

 Vekselstrømsadapter (følger med settet, delnr. P1031365-XXX)9

 Redskapsåpning (P1063406-029)10

 4-dokks strømstasjon (P1063406-027).....10

Legge i uskriftsmateriale (ZQ510 vises) 11

Skriverkommunikasjon12

 Via en datamaskin12

 Via Bluetooth (NFC)12

 Via BT/WLAN12

Skriverkontroller13

Rengjøre skriverne.....14

Tilbehør.....15

 Mag-kortleser15

Tilbehør, forts.16

 Håndstropp (BT16899-1)16

 Skulderstropp (BT11132-1)16

 Myk veske (P1063406-037/-038)16

Tilbehør, forts.17

 Båndklips17

Produktstøtte.....18

 **Slå alltid opp i dataarket** Viktig sikkerhetsinformasjon som sendes med hver skriver og Teknisk bulletin som sendes med hver batteripakke. Disse dokumentene beskriver i detalj prosedyrer for å sikre maksimal pålitelighet og sikkerhet når denne skriveren brukes.

 **Virker sammen med:**



 **Sertifisert:**



I esken

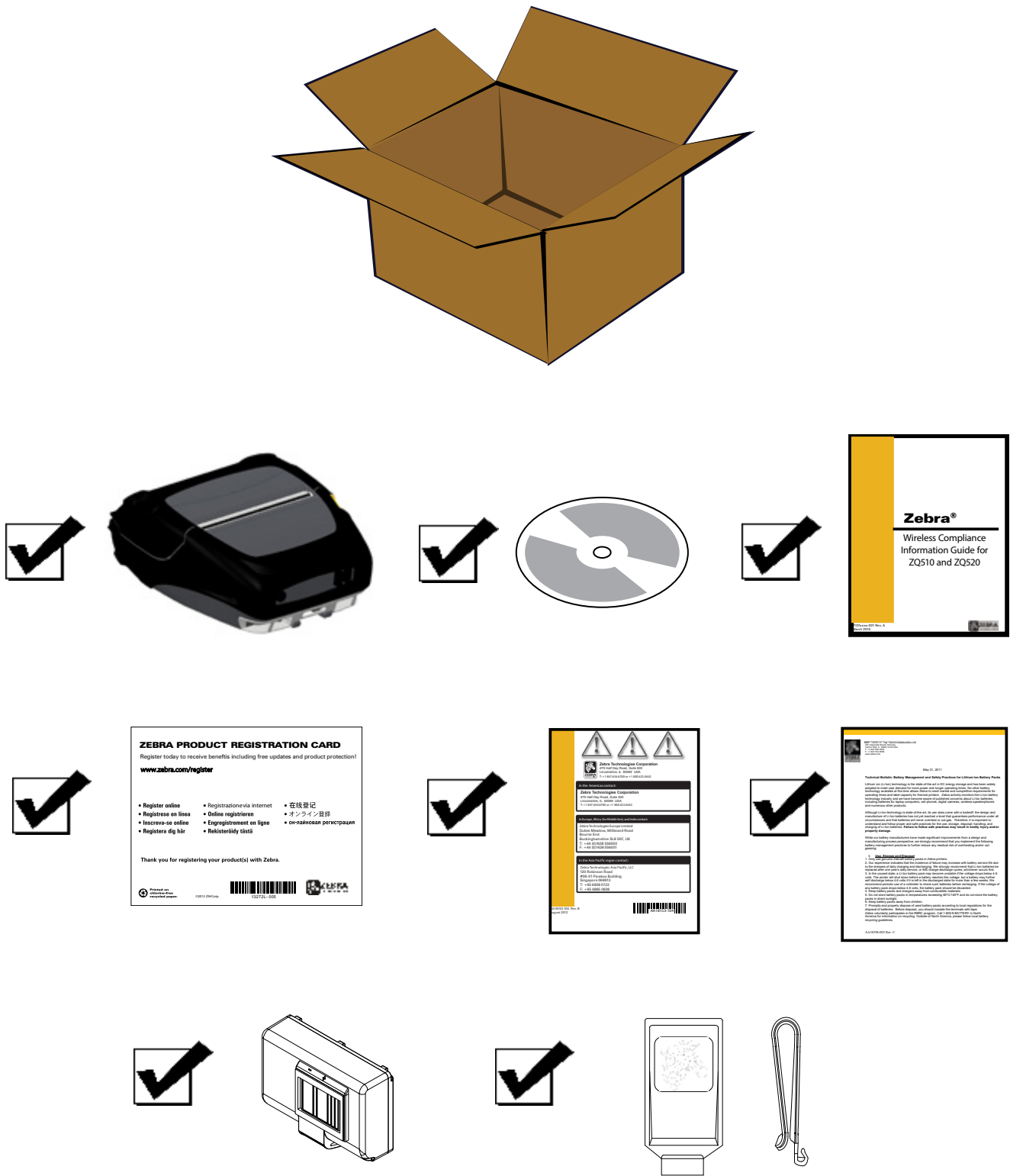

Oversikt

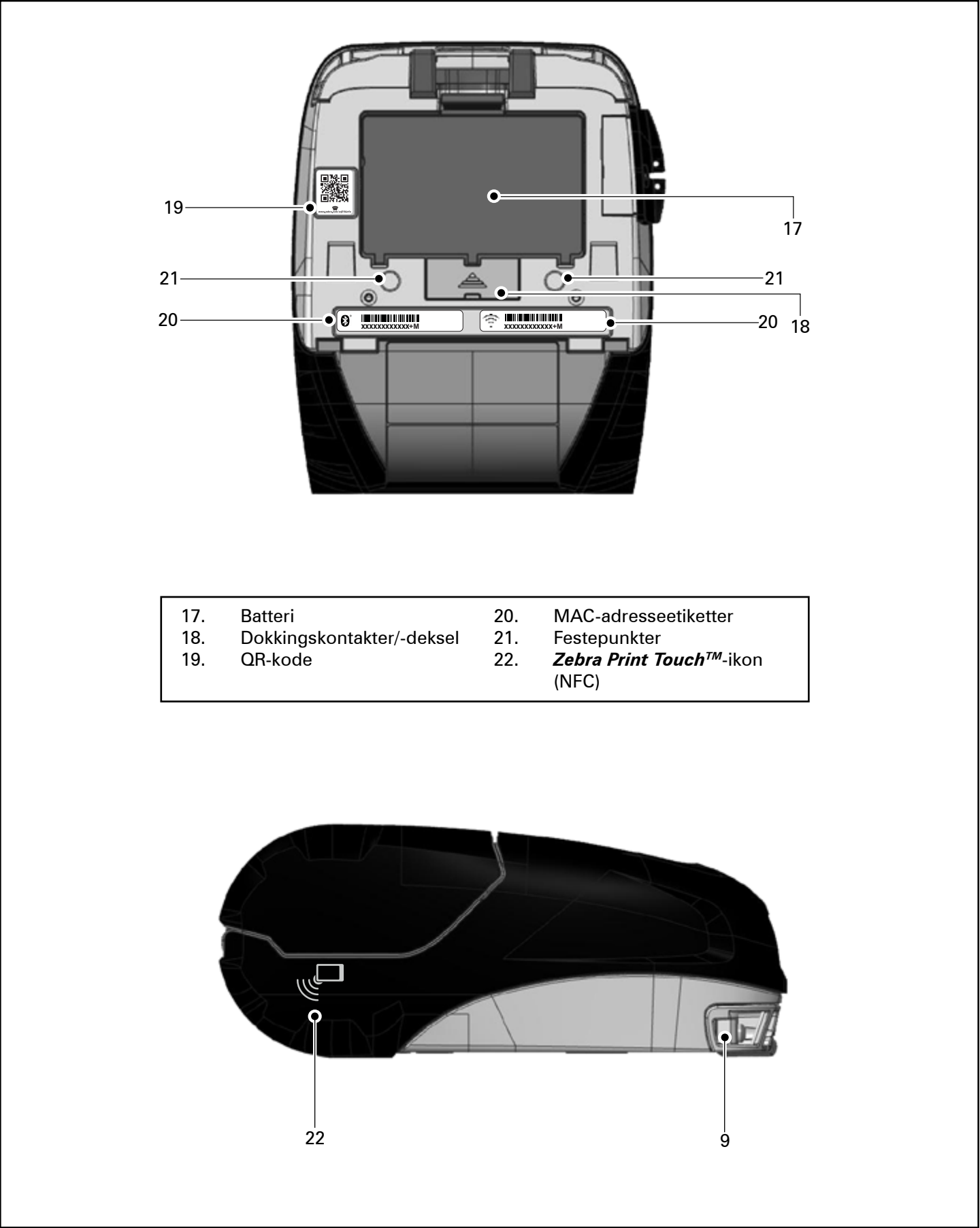
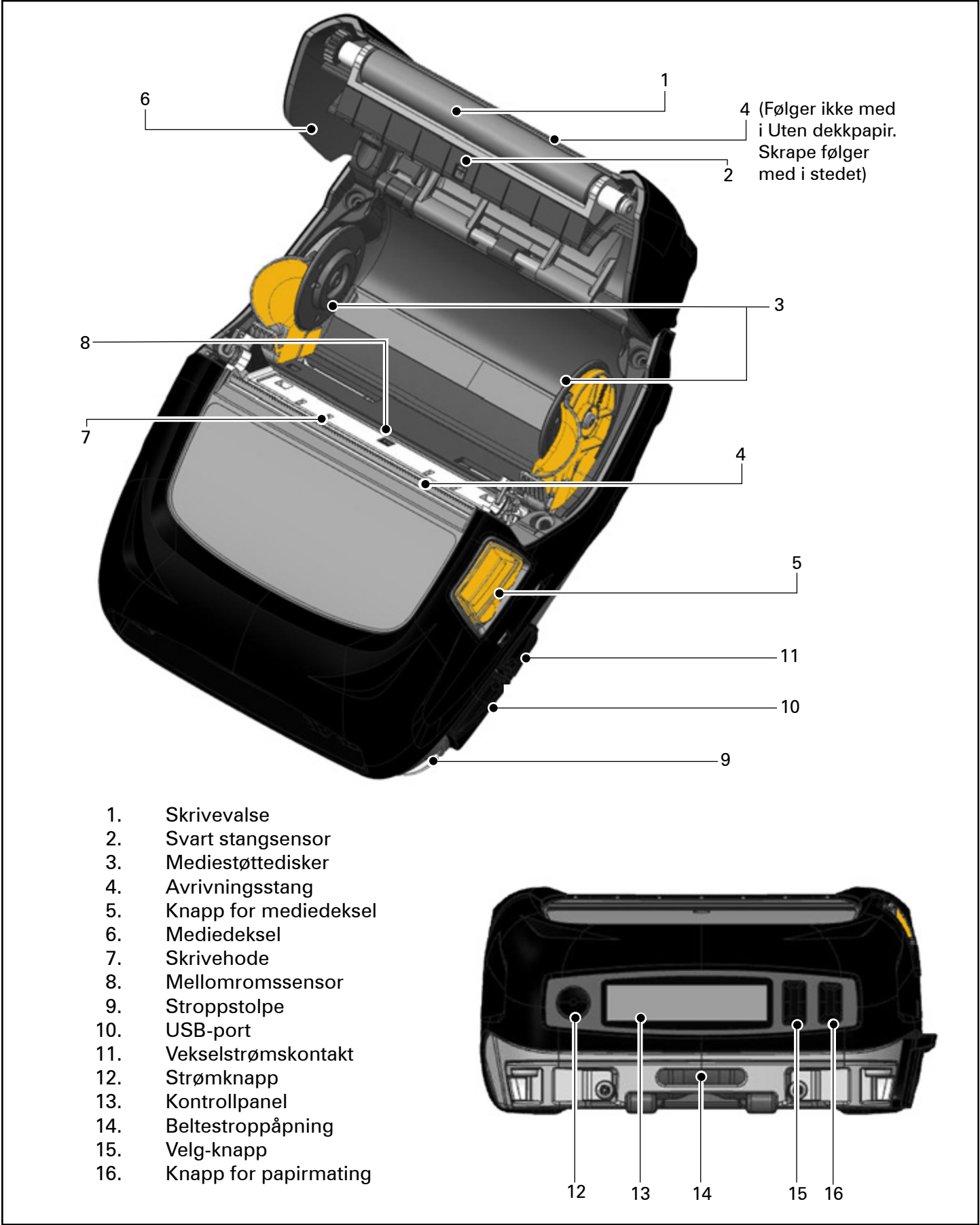

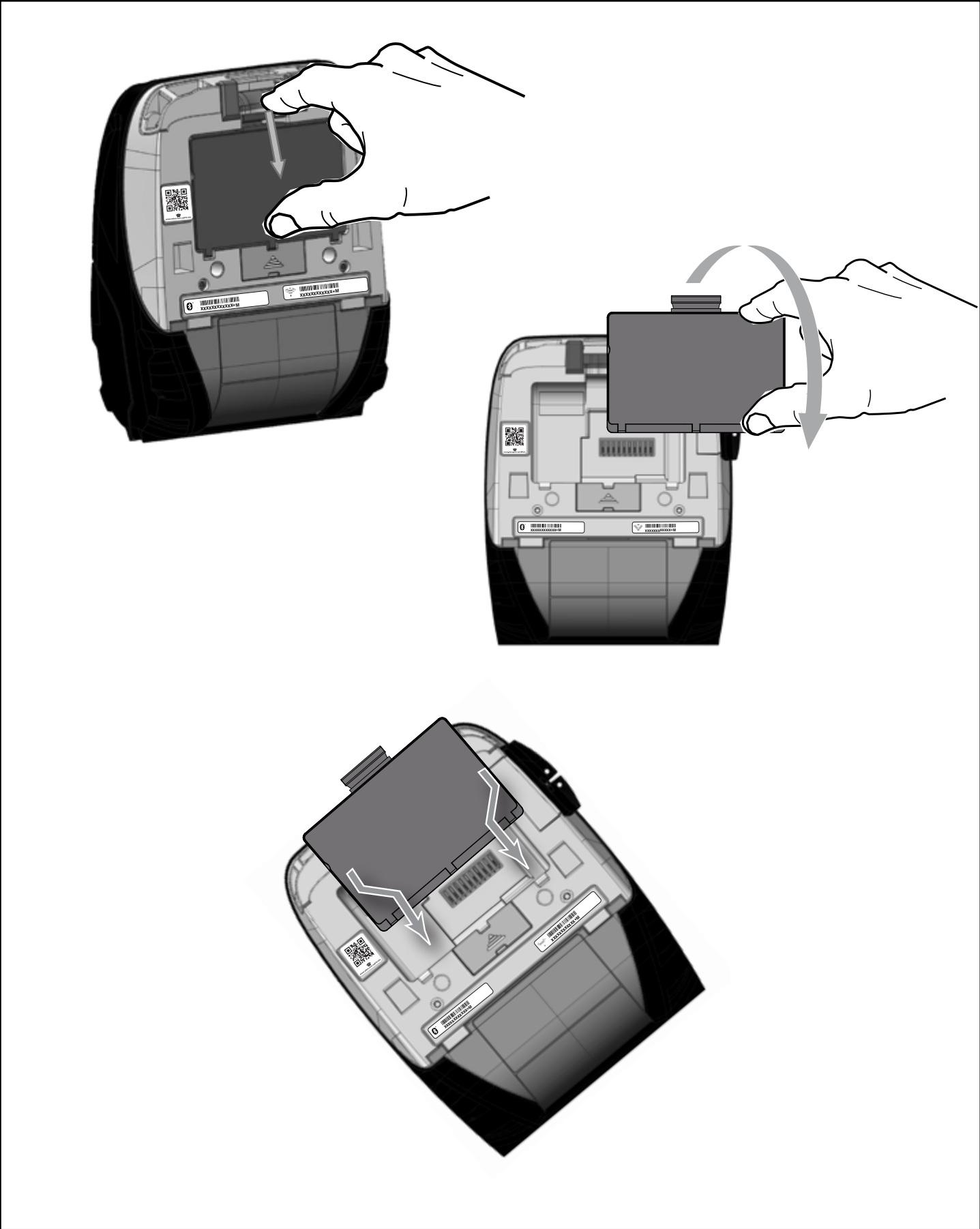

Fjerne og sette inn batteriet



Lade smart-batteriet

UCLI72-4 Quad-lader (AC18177-5)

The illustration shows a four-bay battery charger. A battery is being inserted into the first bay. A power cable is connected to the back of the charger, and a power button is indicated with a power symbol icon.

		
På	Av	Lader
På	Blinker	80% ladet (OK for bruk)
Av	På	Fullstendig oppladet
Blinker	Av	Feil

Smart-lader-2 (SC2) enkeltbatterilader (P1031365-063)

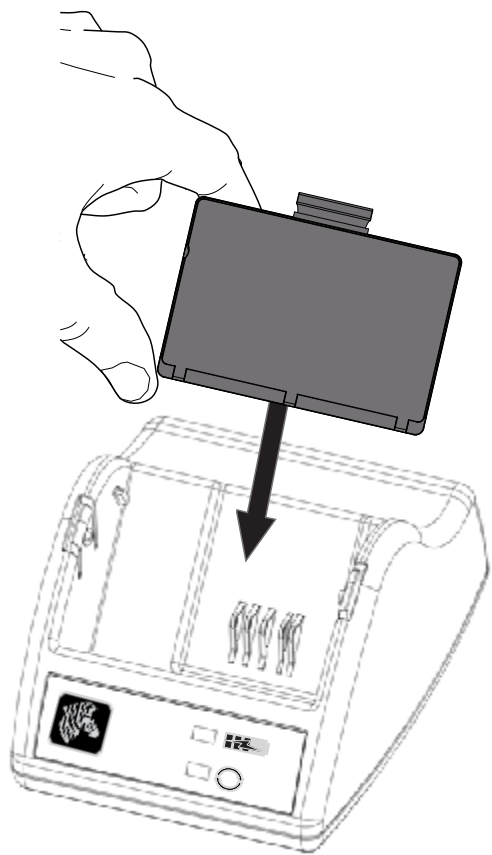

Ladestatus	Fullt ladet	Lader	Brukes ikke	Feil
Batteritilstand	God	Redusert kapasitet	Ikke lenger nyttig	Ubrukelig - bytt batteri

Når SC2 er plugget til, men ikke noe batteri er tilkople, vil ladestatus-LED-indikatoren være grønn.

Vekselstrømsadapter (følger med settet, delnr. P1031365-XXX)

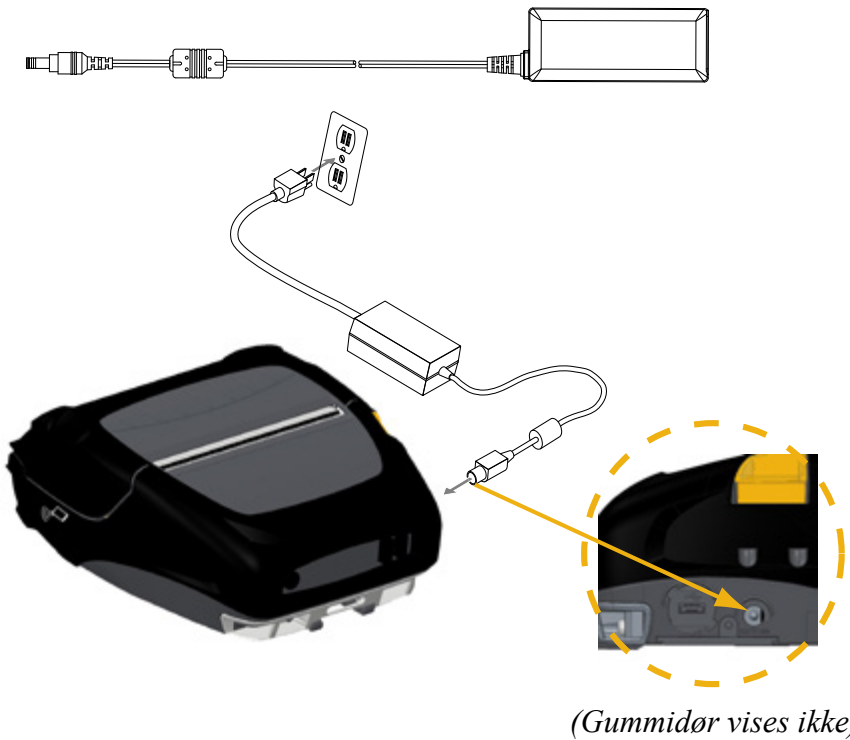

- Batteriene sendes uten ladning. Fjern batteriene fra beskyttelsen og la dem lades opp før første gangs bruk.
- Selv om det er mulig å lade batteriet mens skriveren brukes, øker ladetiden når dette gjøres.

**Redskapsåpning
(P1063406-029)**

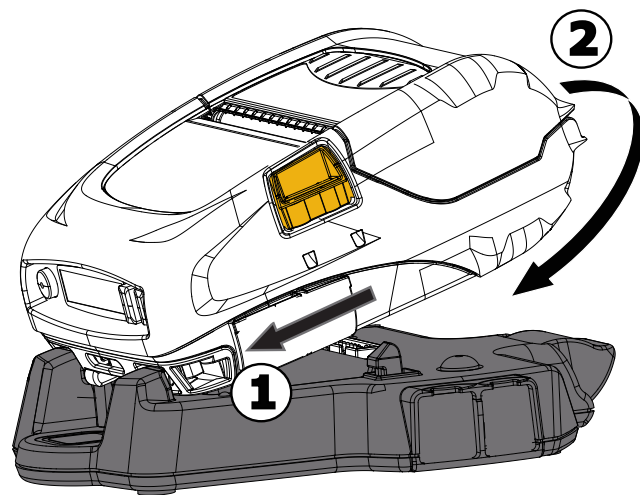
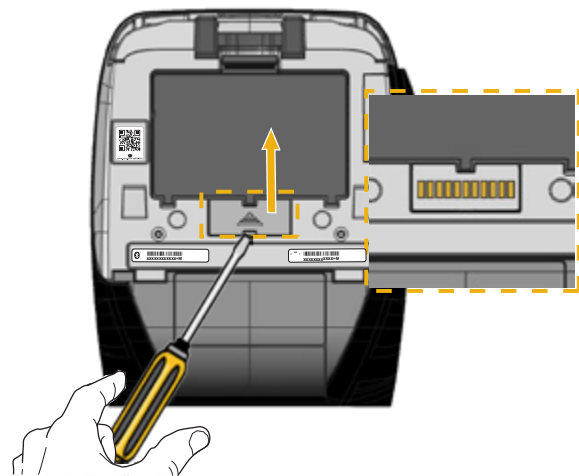

**4-dokks strømstasjon
(P1063406-027)**

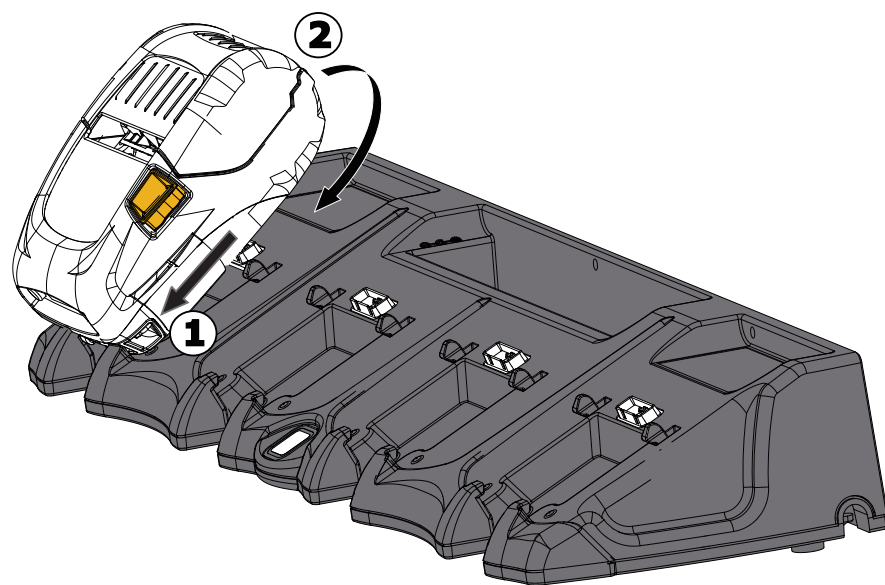

Legge i uskriftsmateriale (ZQ510 vises)

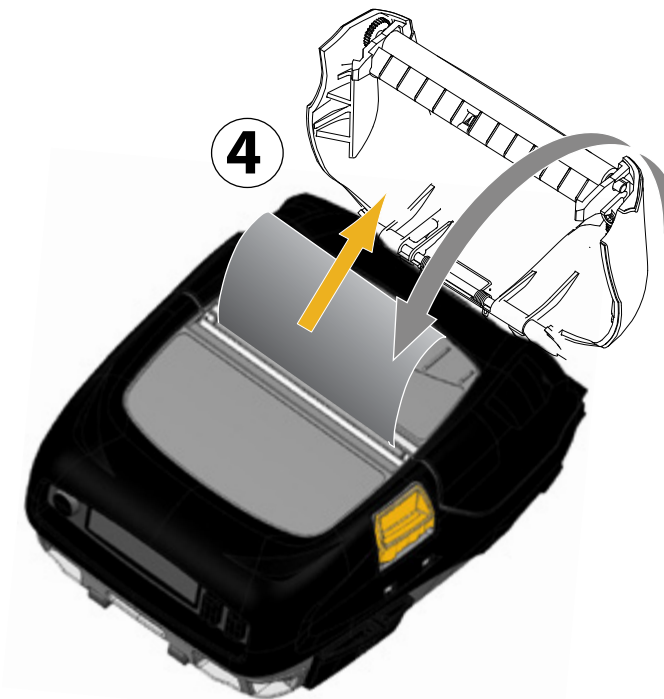
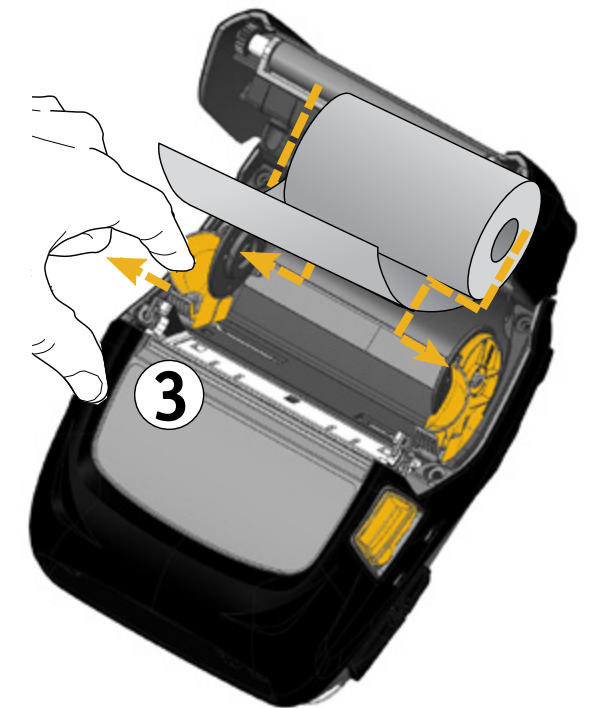
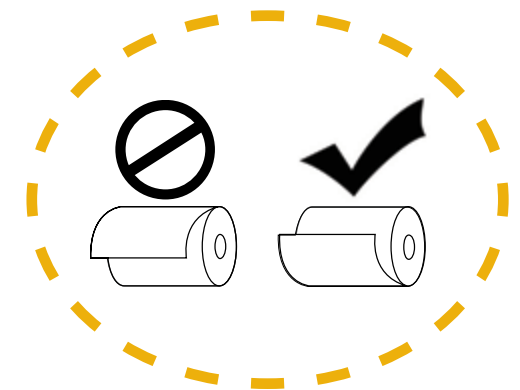
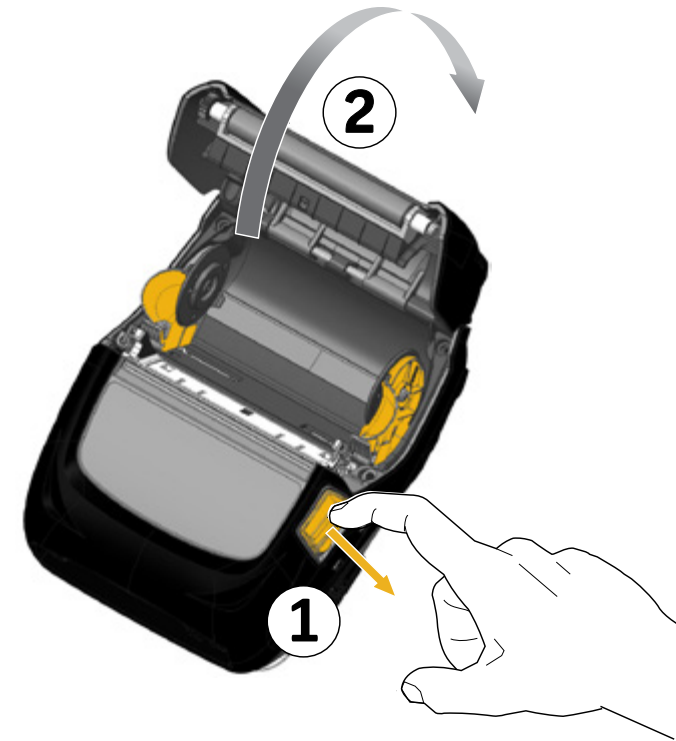

Skriverkommunikasjon

Via en datamaskin

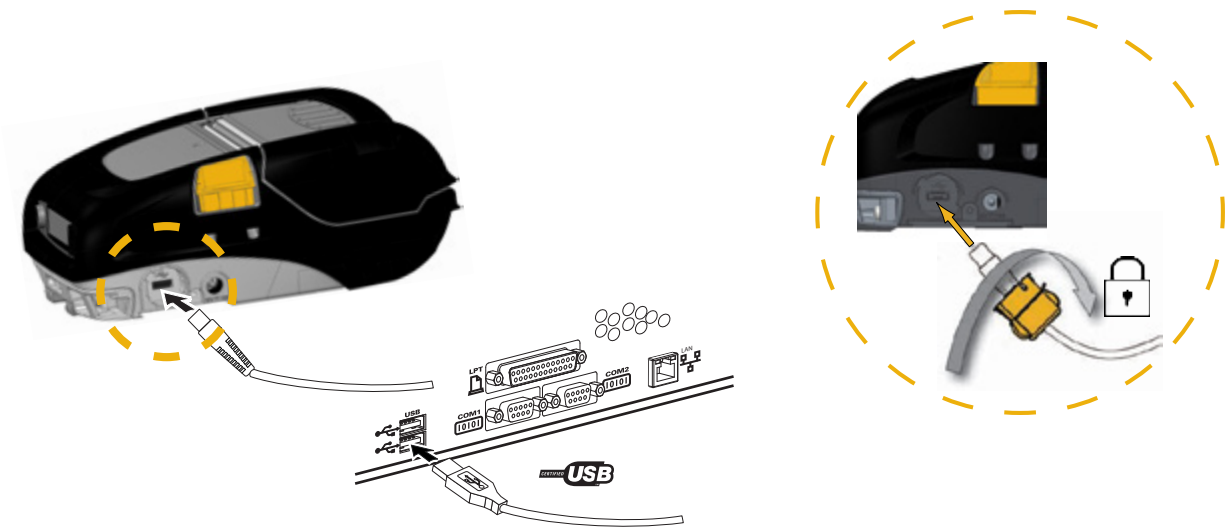

Via Bluetooth (NFC)



Via BT/WLAN

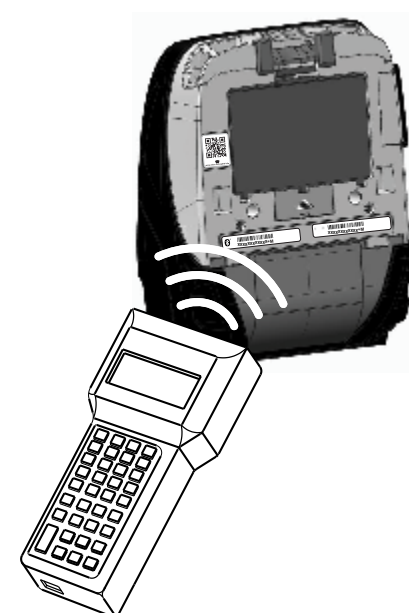

Skriverkontroller



- | | | | |
|--|--|--|--------------------|
| | Strøm
Grønn LED: Ladet batteri/
Batterieliminatør i bruk | | Data |
| | Strøm
Fast gul LED: Lader
Blinkende gul LED: Hvilemodus | | Utskriftsmateriale |
| | Strøm
Rød LED: Batterifeil | | Deksel åpent |
| | Bluetooth | | Batteri |
| | WiFi-tilkobling | | Batterieliminatør |
| | WiFi-signalstyrke | | Velg |
| | Feil | | Mediemating |

Rengjøre skriverne



Zebra rengjøringspenn



70 % isopropylalkohol







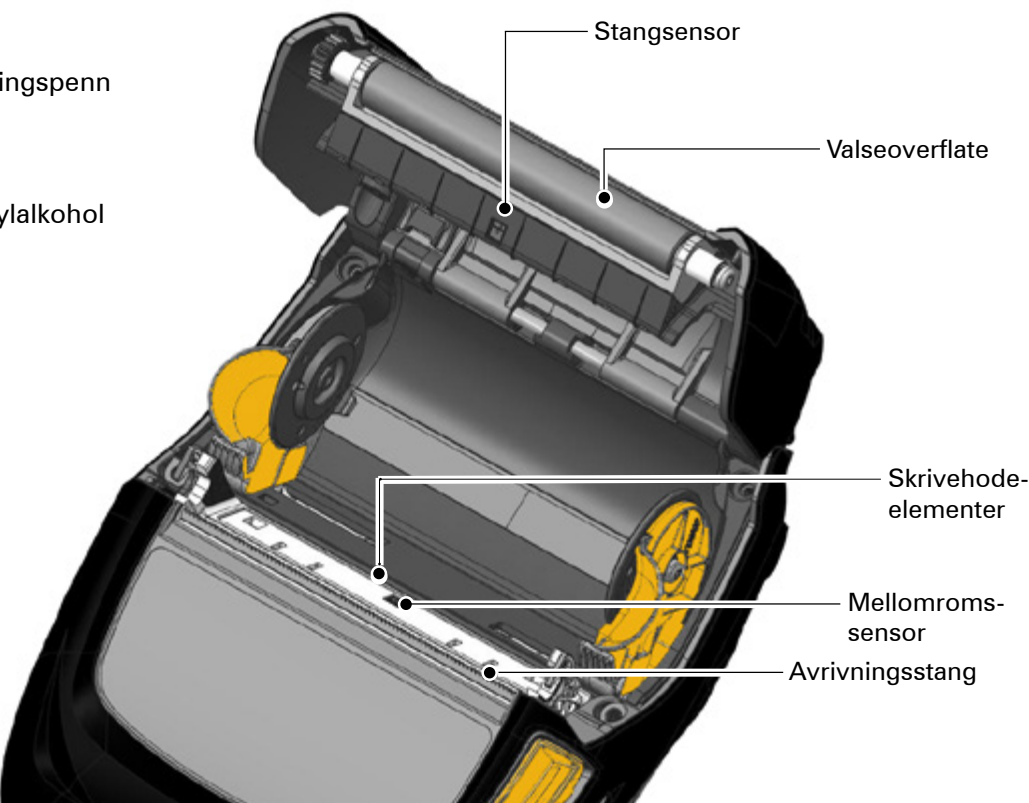

Børste



Luftblåsing



Område	Rengjøringsmetode	Intervall
Skrivehode		Etter hver femte medierull (eller oftere om nødvendig). Når du bruker medietyper uten dekkpapir er det nødvendig med rengjøring etter hver medierull.
Valseoverflate		Etter hver femte medierull (eller oftere om nødvendig). Medier uten dekkpapir krever rengjøring oftere, dvs. etter hver rull.
Skrape (Bare enheter uten dekkpapir)		Etter hver femte medierull (eller oftere om nødvendig)
Avrivningsstang		Etter behov
Utvendig		Etter behov
Innvendig		Etter behov
Innvendig i enhetene med valser uten dekkpapir		Etter hver femte medierull (eller oftere om nødvendig)

Tilbehør

Mag-kortleser

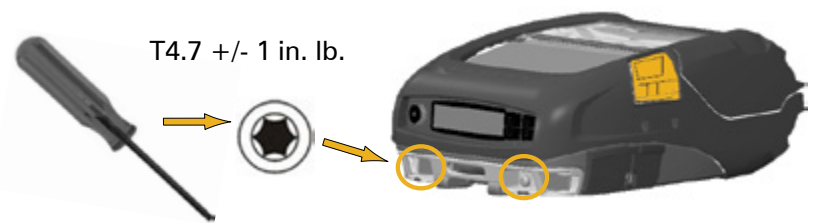

1.

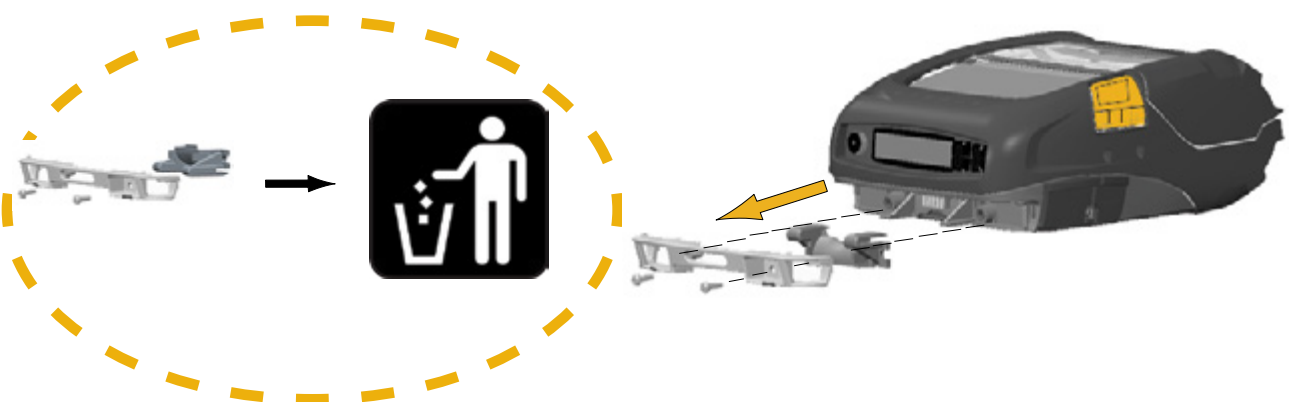

2.



3.



4.

Tilbehør, forts.

Håndstropp (BT16899-1)

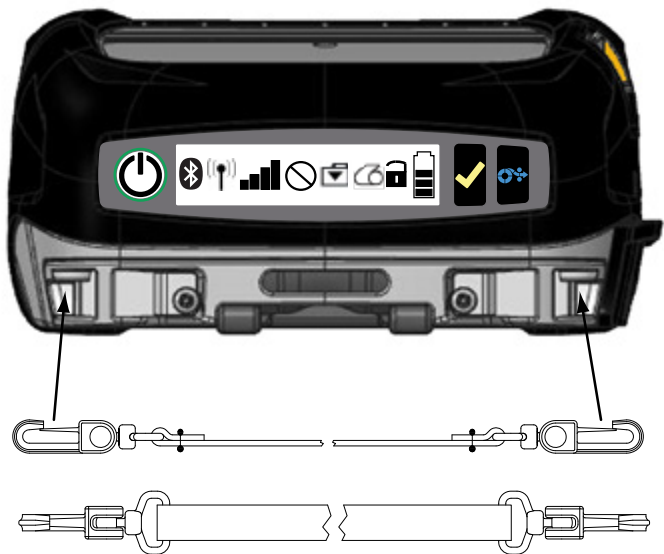

Skulderstropp (BT11132-1)

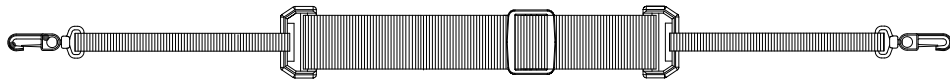

Myk veske (P1063406-037/-038)



Tilbehør, forts.

Båndklips

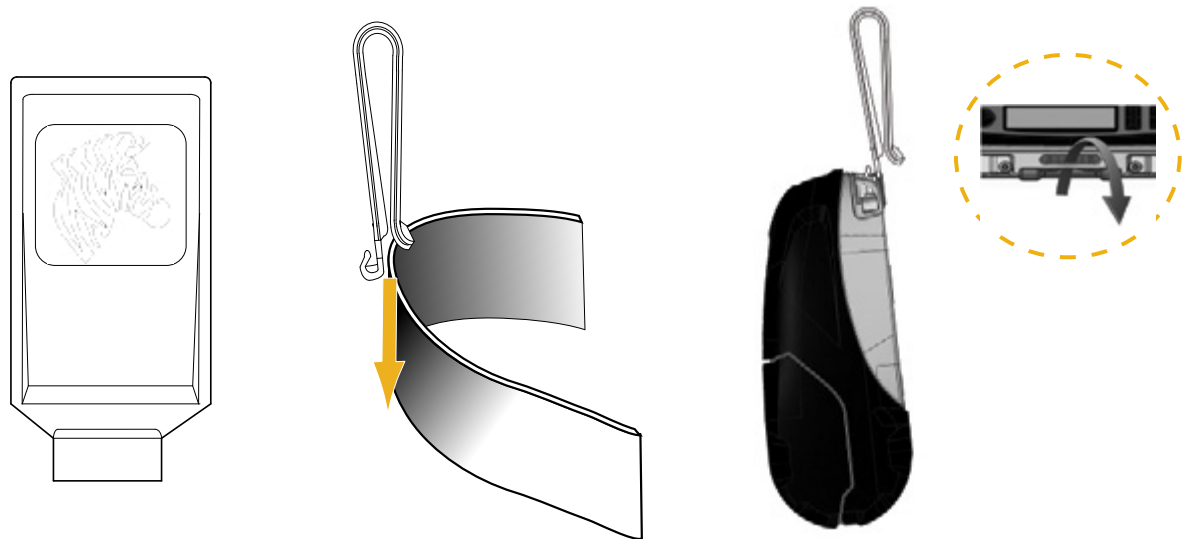

Du finner en fullstendig liste over tilbehør i Bruksanvisning for ZQ500-serien (delnr. P1070599-001) på www.zebra.com/manuals.



Fullstendig og oppdatert dokumentasjon for skriverne gis i Bruksanvisning for ZQ500-serien som finnes på: www.zebra.com/manuals.

Produktstøtte

Zebra Technologies Corporation
475 Half Day Rd., Suite 500
Lincolnshire, Illinois 60069 U.S.A.
T: +1 847.634.6700
T: +1 866.230.9494 (Bare USA)



Zebra Technologies Europe Limited
Dukes Meadow
Millboard Road
Bourne End
Buckinghamshire SL8 5XF, UK
T: +44 (0) 1628 556000



Zebra Technologies Asia Pacific Pte. Ltd.
Regionalt salgskontor i Stillehavsregionen av Asia
71 Robinson Road #05-02/03
Singapore 068895
T: +011/65 6858 0722



Zebra Technologies Corporation
475 Half Day Road, Suite 500
Lincolnshire, IL 60069 USA
T: +1 847.634.6700 eller +1 800.423.0442