

# MC9090-G RFID

## Quick Start Guide

<http://www.zebra.com/rfid>

See User Guide for more information  
This guide is applicable to all MC90XX-G RFID series products

### BATTERY INSERTION

#### Front View

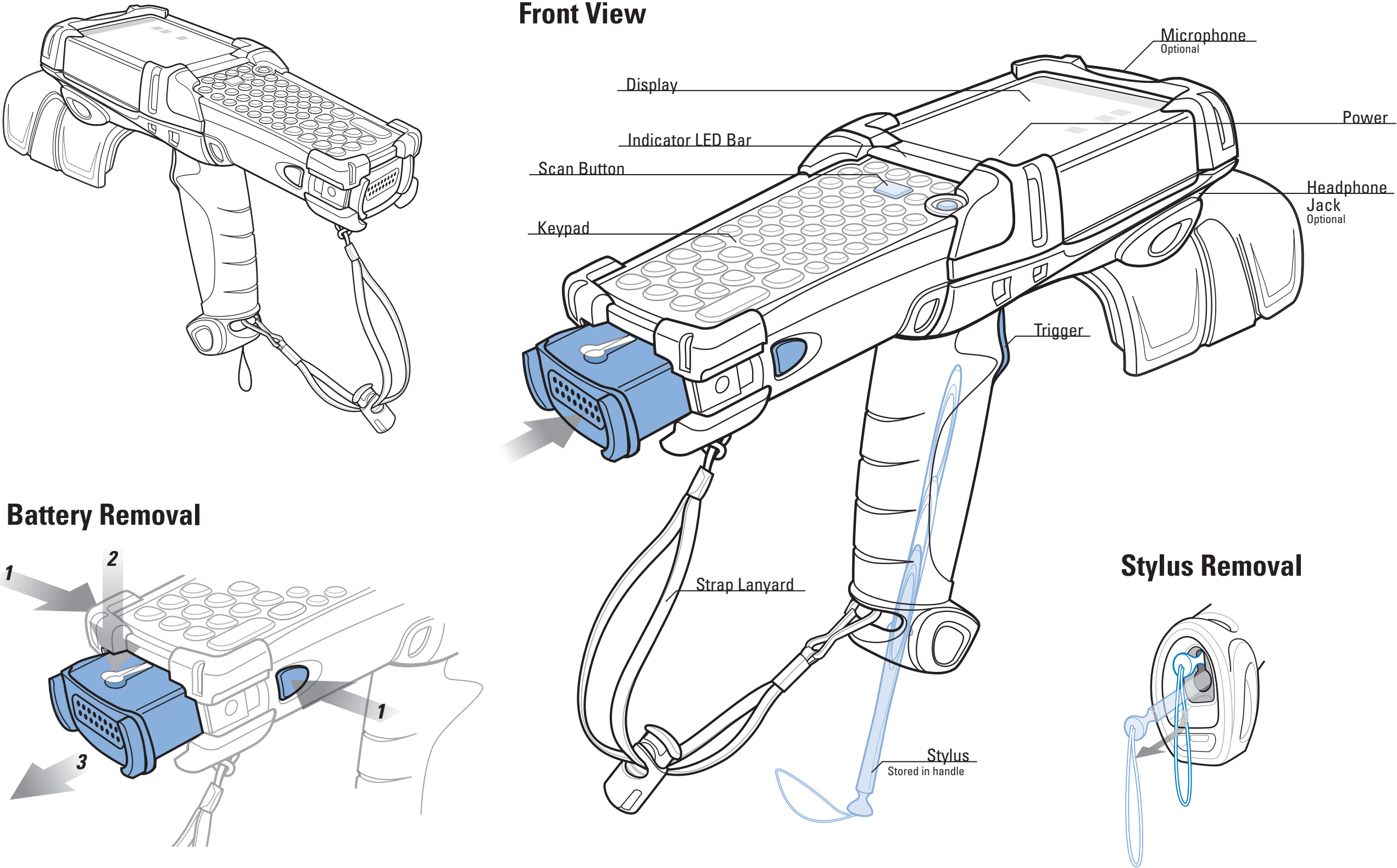

### SNAP-ON ACCESSORY INSTALLATION

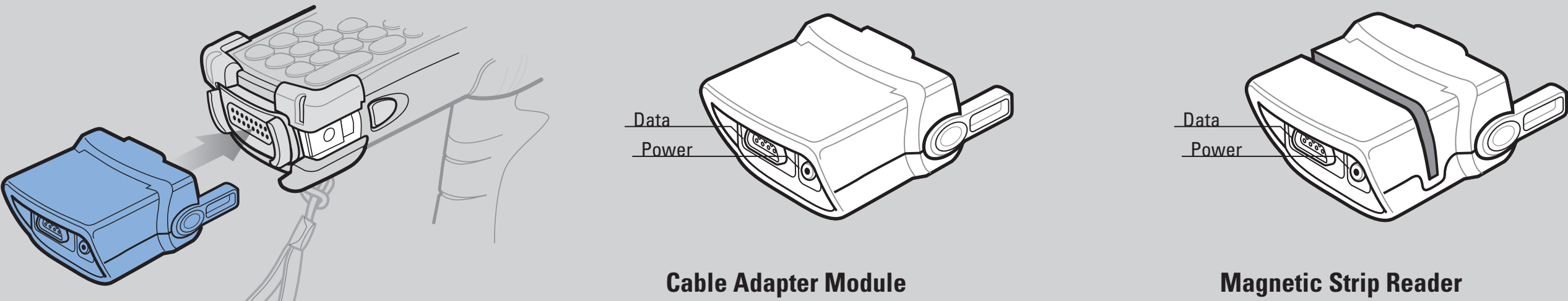

### CHARGING INSTRUCTIONS

⦿ = LED Indicator Location    Slow Flash = Normal Charge    Solid Amber = Full Charge    Fast Flash = Charging Error

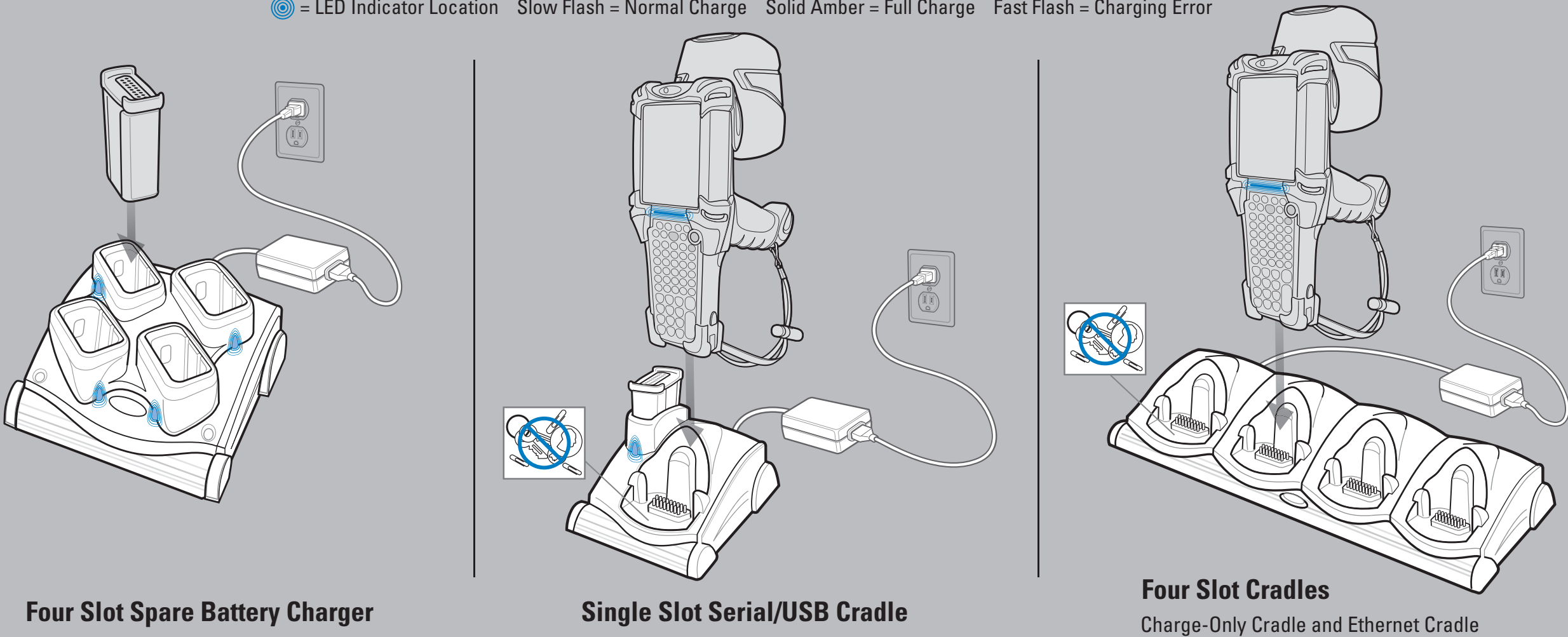

# OPTIMUM IMAGING AND SCANNING POSITIONS

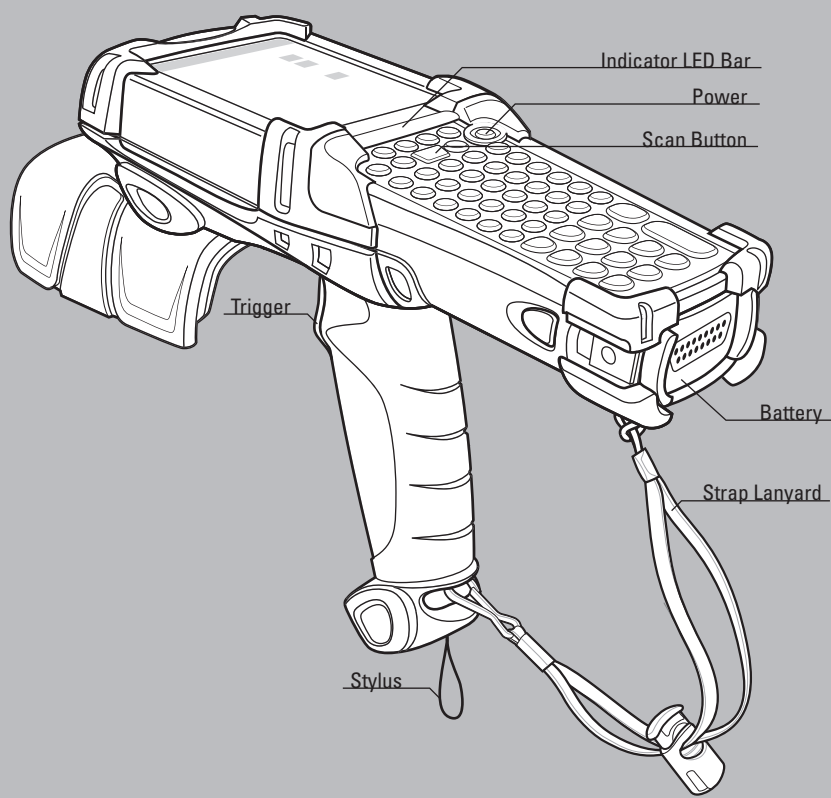

## Scanning/Imaging

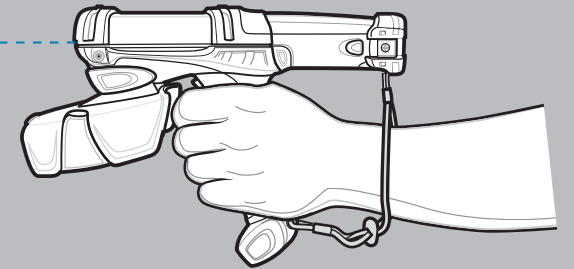

# OPTIMUM UPRIGHT BODY POSTURE

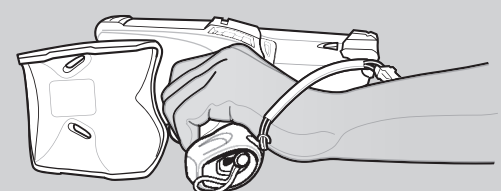
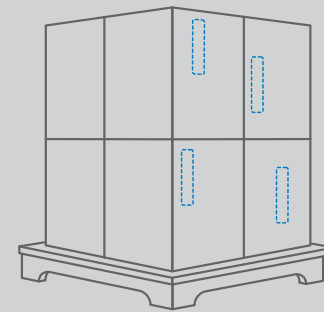
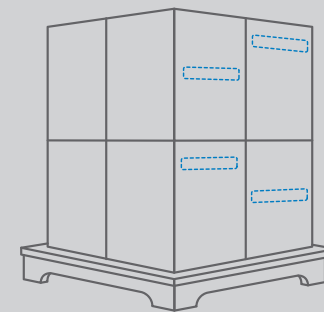
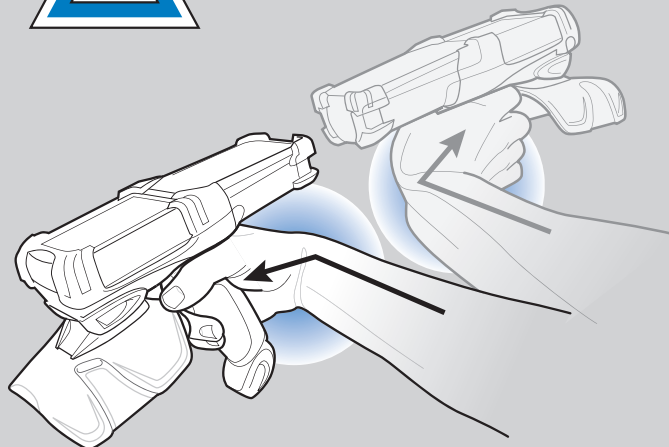
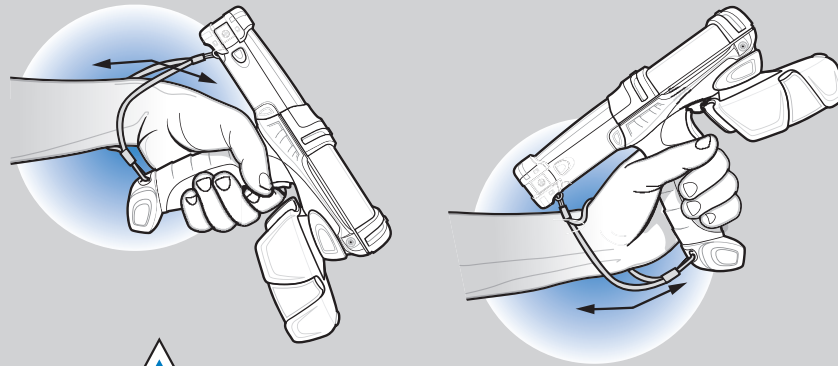
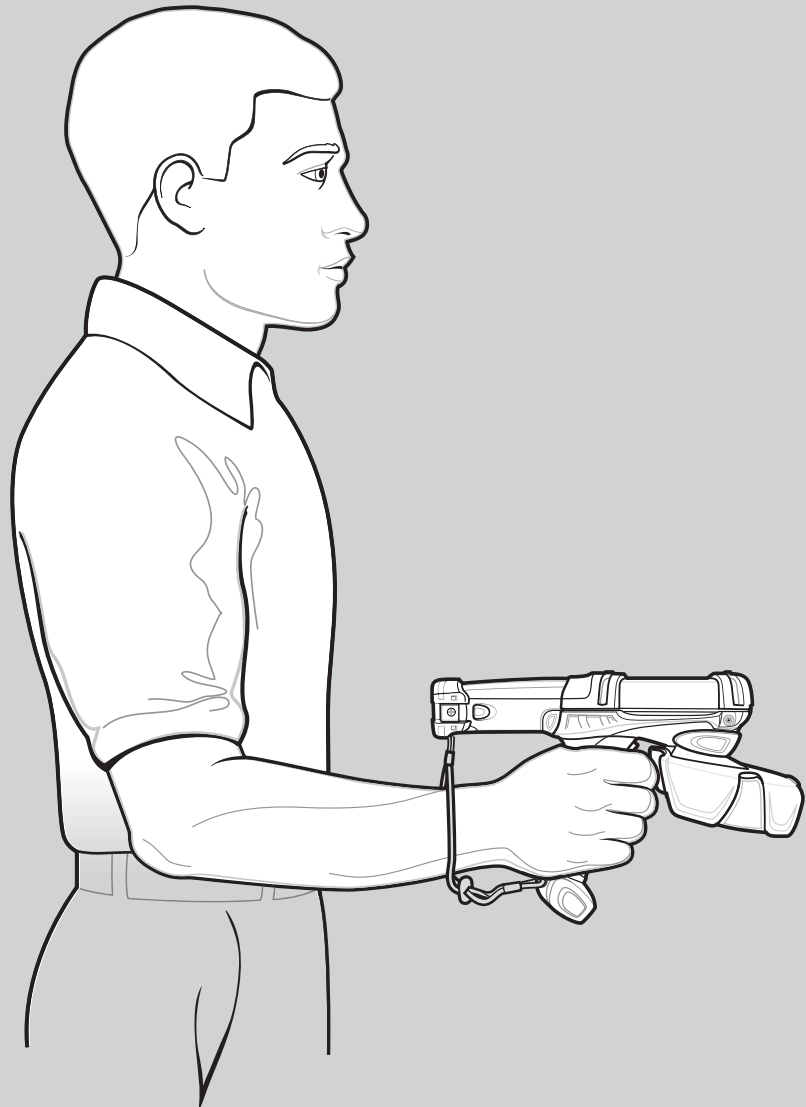

# OPTIMUM BODY POSTURE

## Low Scanning

Alternate left and right knees

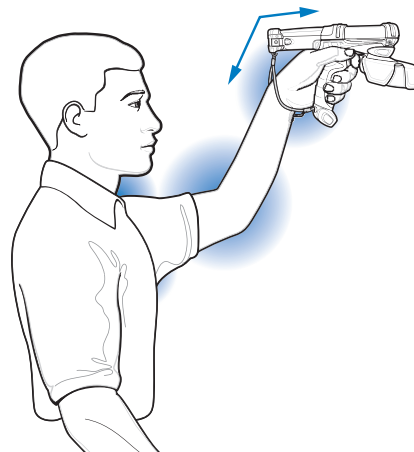
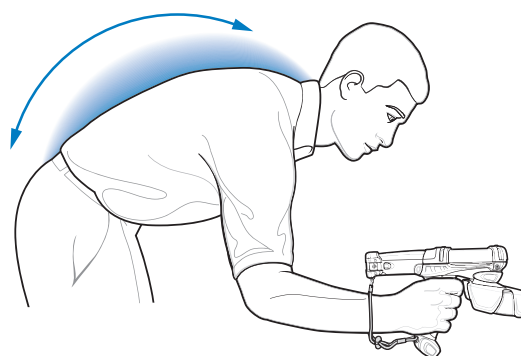
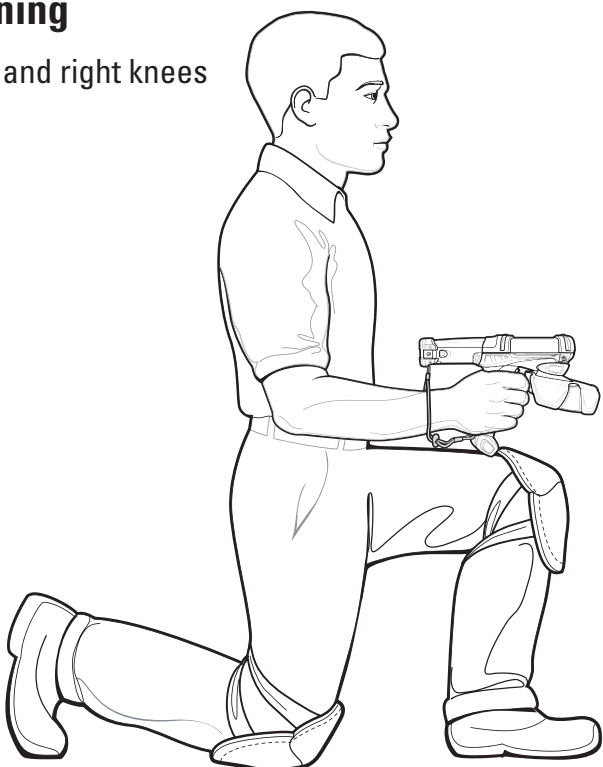

## High Scanning

Use a ladder

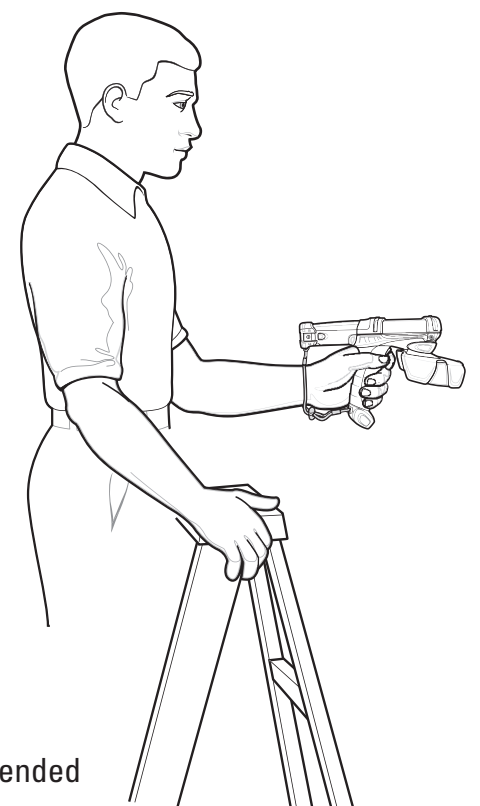

Taking breaks and task rotation recommended



72-89960-02 Rev A March 2015

<http://www.zebra.com/rfid>